

H:\1998\98404\DWG\PRF4006.DWG

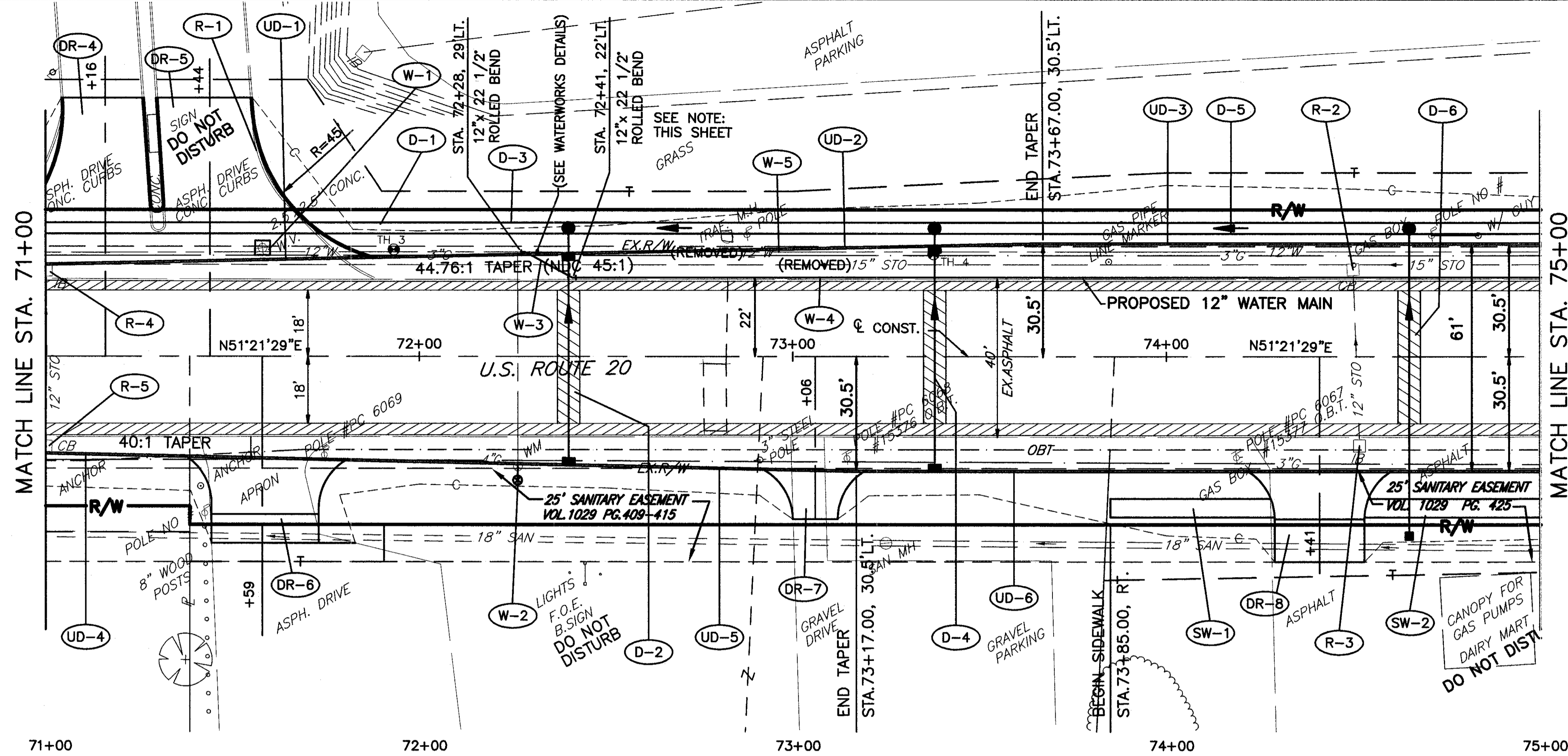

BENCH MARK #4
TOP NW CORNER CONC. WALK AT
NW CORNER DAIRY MART BLDG.
STA. 74+29± 121± RT.
ELEV. 676.58

- NOTE:
- 1.) ROTATE (2) 22 1/2' BENDS TO OFFSET WATERMAIN 7' HORIZONTALLY AND 3.5' VERTICALLY. CONTRACTOR SHALL VERIFY LOCATION OF EXISTING WATERMAIN TO MAINTAIN ADEQUATE CLEARANCE TO ADJACENT STORM SEWER PER NOTES K.3 AND K.4 IN THE GENERAL NOTES ON SHEET 303 OF 441.
 - 2.) THRUST BLOCKING AND JOINT RESTRAINTS SHALL BE PROVIDED AT ALL BENDS PER STANDARD DETAILS.

FOR ESTIMATED QUANTITIES SEE SHEET 87.

FULL DEPTH PAVEMENT REPAIR AS PER SECTION 603.09 OF THE CONSTRUCTION AND MATERIALS SPECIFICATIONS.

EXISTING PAVEMENT TO BE REMOVED

Station	673.11	673.26	673.41	673.56	673.71	673.86	674.01	674.16	674.31
685									
680			PROPOSED 12" WATERMAIN INVERTS	664.00	664.00	664.00	664.50	665.00	667.00
675									
670									
665									
660									
655									
650									
Station	673.03	673.20	673.34	673.52	673.68	673.79	673.92	674.05	674.21