

ESTIMATED QUANTITIES		877	
LOCATION	SIDE	TEMPORARY PERIMETER FILTER FABRIC FENCE	TEMPORARY INLET PROTECTION FILTER FABRIC FENCE
		LIN.FT.	LIN.FT.
AT ALL INLETS & CATCH BASINS	LT & RT		525
AT ALL MANHOLES	LT & RT		360
STA. 270+80 TO STA. 279+00	LT	820	
STA. 10+50 TO STA. 15+00 (CENTER RD)	LT	450	
STA. 12+50 TO STA. 13+50 (CENTER RD)	RT	100	
STA. 283+00 TO STA. 287+50	LT	450	
STA. 270+80 TO STA. 272+50	RT	170	
STA. 273+50 TO STA. 276+00	RT	250	
STA. 277+50 TO STA. 279+50	RT	200	
STA. 6+50 TO STA. 9+00 (CENTER RD)	LT	250	
STA. 6+50 TO STA. 9+50 (CENTER RD)	RT	300	
STA. 280+50 TO STA. 281+15	RT	65	
STA. 281+60 TO STA. 282+10	RT	50	
STA. 282+60 TO STA. 288+00	RT	540	
TOTALS		3,645	885

QUANTITIES CARRIED TO GENERAL SUMMARY

PROJECT DATA	
TOTAL AREA (RIGHT OF WAY) -----	5.13 AC.
AREA TO UNDERGO EXCAVATION, FILLING OR GRADING -----	3.90 AC.
RUNOFF COEFFICIENT FOR PRE-CONSTRUCTION SITE -----	0.6
RUNOFF COEFFICIENT FOR POST CONSTRUCTION SITE -----	0.7
SOIL DATA -----	SEE SOIL PROFILE
IMMEDIATE RECEIVING WATERS -----	EXISTING DITCH
SUBSEQUENT RECEIVING WATERS -----	LAKE ERIE

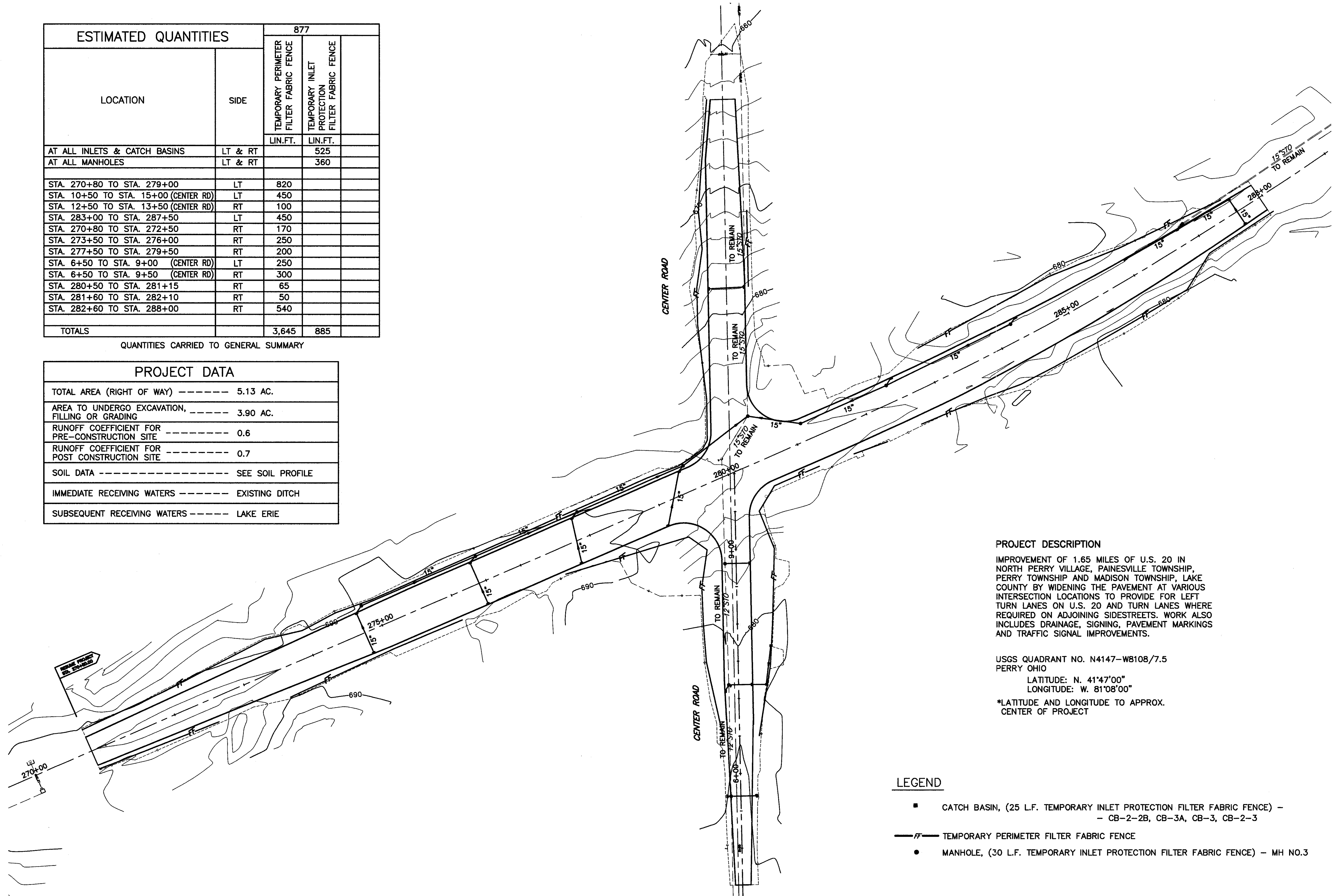

PROJECT DESCRIPTION

IMPROVEMENT OF 1.65 MILES OF U.S. 20 IN NORTH PERRY VILLAGE, PAINESVILLE TOWNSHIP, PERRY TOWNSHIP AND MADISON TOWNSHIP, LAKE COUNTY BY WIDENING THE PAVEMENT AT VARIOUS INTERSECTION LOCATIONS TO PROVIDE FOR LEFT TURN LANES ON U.S. 20 AND TURN LANES WHERE REQUIRED ON ADJOINING SIDESTREETS. WORK ALSO INCLUDES DRAINAGE, SIGNING, PAVEMENT MARKINGS AND TRAFFIC SIGNAL IMPROVEMENTS.

USGS QUADRANT NO. N4147-W8108/7.5
PERRY OHIO

LATITUDE: N. 41°47'00"
LONGITUDE: W. 81°08'00"

*LATITUDE AND LONGITUDE TO APPROX. CENTER OF PROJECT

LEGEND

- CATCH BASIN, (25 L.F. TEMPORARY INLET PROTECTION FILTER FABRIC FENCE) - CB-2-2B, CB-3A, CB-3, CB-2-3
- FF — TEMPORARY PERIMETER FILTER FABRIC FENCE
- MANHOLE, (30 L.F. TEMPORARY INLET PROTECTION FILTER FABRIC FENCE) - MH NO.3

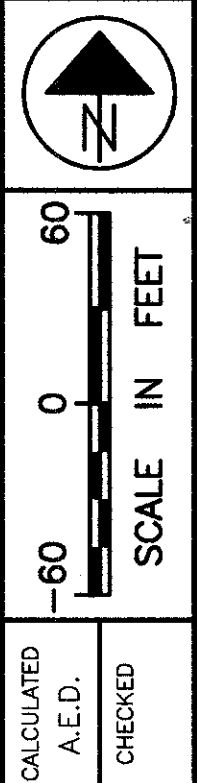

STORM WATER POLLUTION PREVENTION PLAN
STA. 270+00 TO STA. 288+00

LAK - 20 - 18.72

H:\1998\98-04\DWG\SWPPI1.DWG