

CALCULATED
A.E.D.
CHECKED

STORM WATER POLLUTION PREVENTION PLAN
STA. 68+00 TO STA. 82+00

LAK - 20 - 18.72

75
441

ESTIMATED QUANTITIES		877	
LOCATION	SIDE	TEMPORARY PERIMETER FILTER FABRIC FENCE	TEMPORARY INLET PROTECTION FILTER FABRIC FENCE
		LIN.FT.	LIN.FT.
AT ALL INLETS & CATCH BASINS	LT & RT		500
AT ALL MANHOLES	LT & RT		330
STA. 69+00 TO STA. 70+75	LT	175	
STA. 71+75 TO STA. 77+00	LT	525	
STA. 11+25 TO STA. 13+35 (BACON RD)	LT	210	
STA. 13+90 TO STA. 16+00 (BACON RD)	LT	210	
STA. 12+00 TO STA. 13+55 (BACON RD)	RT	170	
STA. 14+20 TO STA. 15+75 (BACON RD)	RT	155	
STA. 78+50 TO STA. 82+00	LT	350	
STA. 53+00 TO STA. 69+00	LT		210
(SEE PLANS FOR M.H. LOCATIONS)	LT		
TOTALS		1795	1040

QUANTITIES CARRIED TO GENERAL SUMMARY

PROJECT DATA	
TOTAL AREA (RIGHT OF WAY)	7.22 AC.
AREA TO UNDERGO EXCAVATION, FILLING OR GRADING	6.20 AC.
RUNOFF COEFFICIENT FOR PRE-CONSTRUCTION SITE	0.6
RUNOFF COEFFICIENT FOR POST CONSTRUCTION SITE	0.7
SOIL DATA	SEE SOIL PROFILE
IMMEDIATE RECEIVING WATERS	MUD MILL CREEK
SUBSEQUENT RECEIVING WATERS	GRAND RIVER

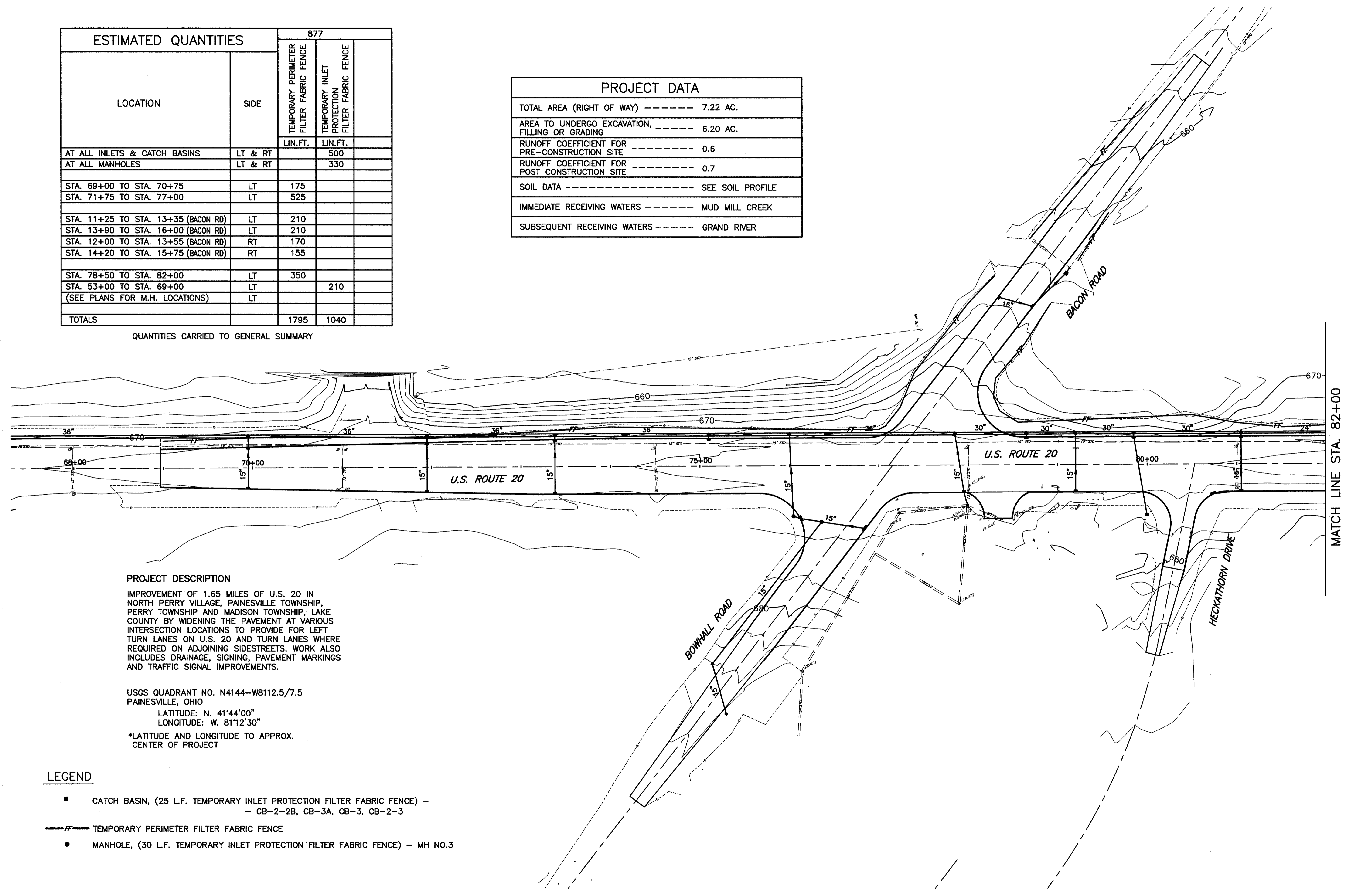

PROJECT DESCRIPTION

IMPROVEMENT OF 1.65 MILES OF U.S. 20 IN NORTH PERRY VILLAGE, PAINESVILLE TOWNSHIP, PERRY TOWNSHIP AND MADISON TOWNSHIP, LAKE COUNTY BY WIDENING THE PAVEMENT AT VARIOUS INTERSECTION LOCATIONS TO PROVIDE FOR LEFT TURN LANES ON U.S. 20 AND TURN LANES WHERE REQUIRED ON ADJOINING SIDESTREETS. WORK ALSO INCLUDES DRAINAGE, SIGNING, PAVEMENT MARKINGS AND TRAFFIC SIGNAL IMPROVEMENTS.

USGS QUADRANT NO. N4144-W8112.5/7.5
PAINESVILLE, OHIO

LATITUDE: N. 41°44'00"
LONGITUDE: W. 81°12'30"

*LATITUDE AND LONGITUDE TO APPROX. CENTER OF PROJECT

LEGEND

- CATCH BASIN, (25 L.F. TEMPORARY INLET PROTECTION FILTER FABRIC FENCE) - CB-2-2B, CB-3A, CB-3, CB-2-3
- TEMPORARY PERIMETER FILTER FABRIC FENCE
- MANHOLE, (30 L.F. TEMPORARY INLET PROTECTION FILTER FABRIC FENCE) - MH NO.3

H:\1998\98404\DWG\SWPPT1.DWG