

PART A TYPICAL SECTION

PART A

1. WHEN HECKATHORN DRIVE IS CONSTRUCTED THE CONTRACTOR SHALL BE ALLOWED TO CLOSE THE ROAD UTILIZING THE DETOUR ROUTE INDICATED, FOR A PERIOD NOT TO EXCEED 30 CONSECUTIVE CALENDAR DAYS. LIQUIDATED DAMAGES SHALL BE ASSESSED IN THE AMOUNT OF \$1000.00 PER DAY FOR EACH CALENDAR DAY THE ROADWAY REMAINS CLOSED TO TRAFFIC BEYOND THE SPECIFIED LIMITS.
2. NO WORK SHALL OCCUR ON HECKATHORN DRIVE OR TO THE DRIVES TO PARCEL 8 BETWEEN NOVEMBER 1 TO APRIL 30. LIQUIDATED DAMAGES SHALL BE ASSESSED IN THE AMOUNT OF \$1,600.00 PER DAY FOR EACH CALENDAR DAY THE ROADWAY OR DRIVES REMAIN CLOSED TO TRAFFIC BEYOND THE SPECIFIED LIMIT.
3. HOLD ON TYPE 6 CURB INSTALLATION.
4. ACCESS TO CARWASH TO BE MAINTAINED AT ALL TIMES. PART WIDTH CONSTRUCTION SHALL BE USED TO CONSTRUCT DRIVE REPLACEMENTS TO CARWASH.

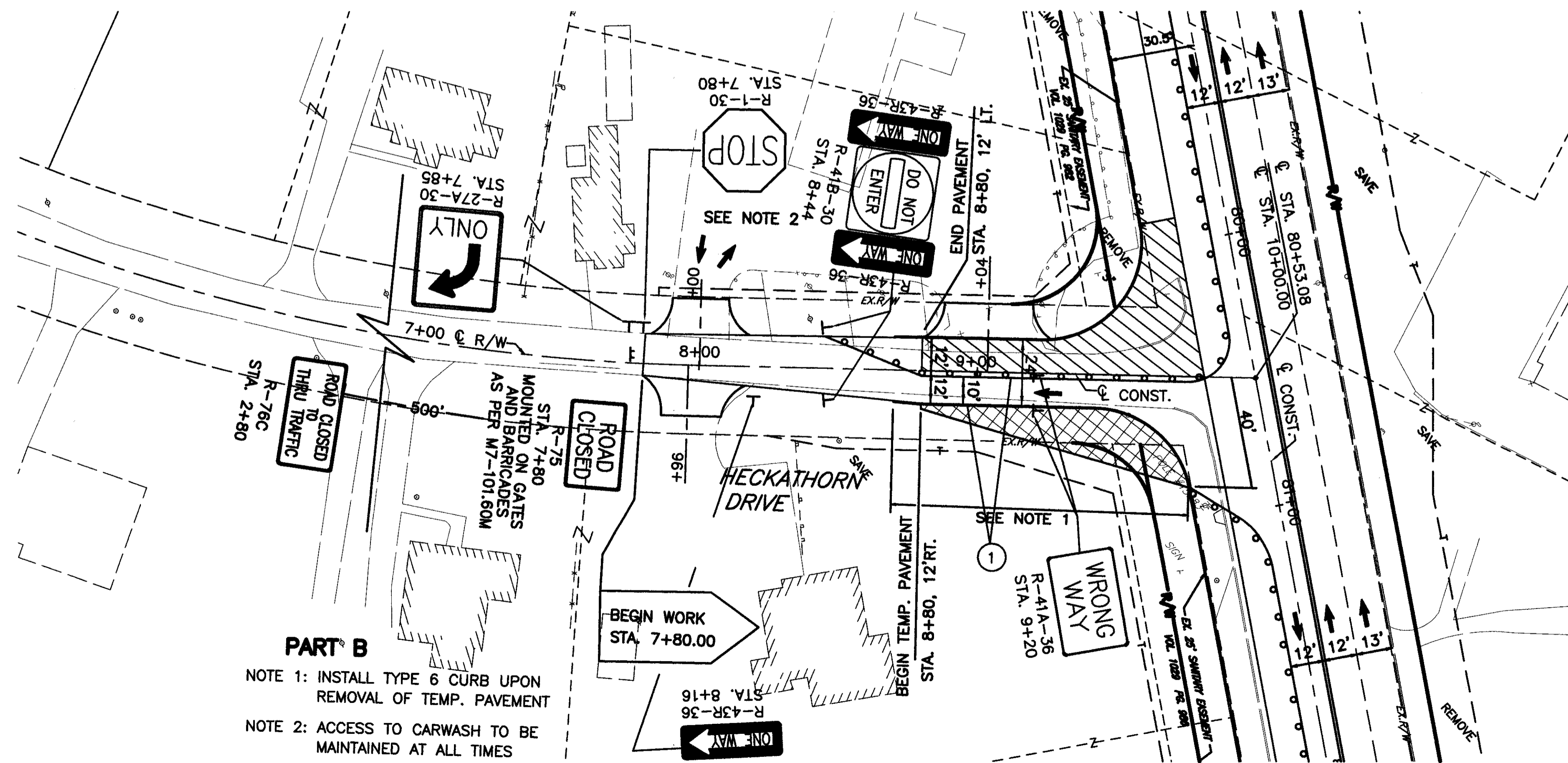

- PART B**
- NOTE 1: INSTALL TYPE 6 CURB UPON REMOVAL OF TEMP. PAVEMENT
- NOTE 2: ACCESS TO CARWASH TO BE MAINTAINED AT ALL TIMES

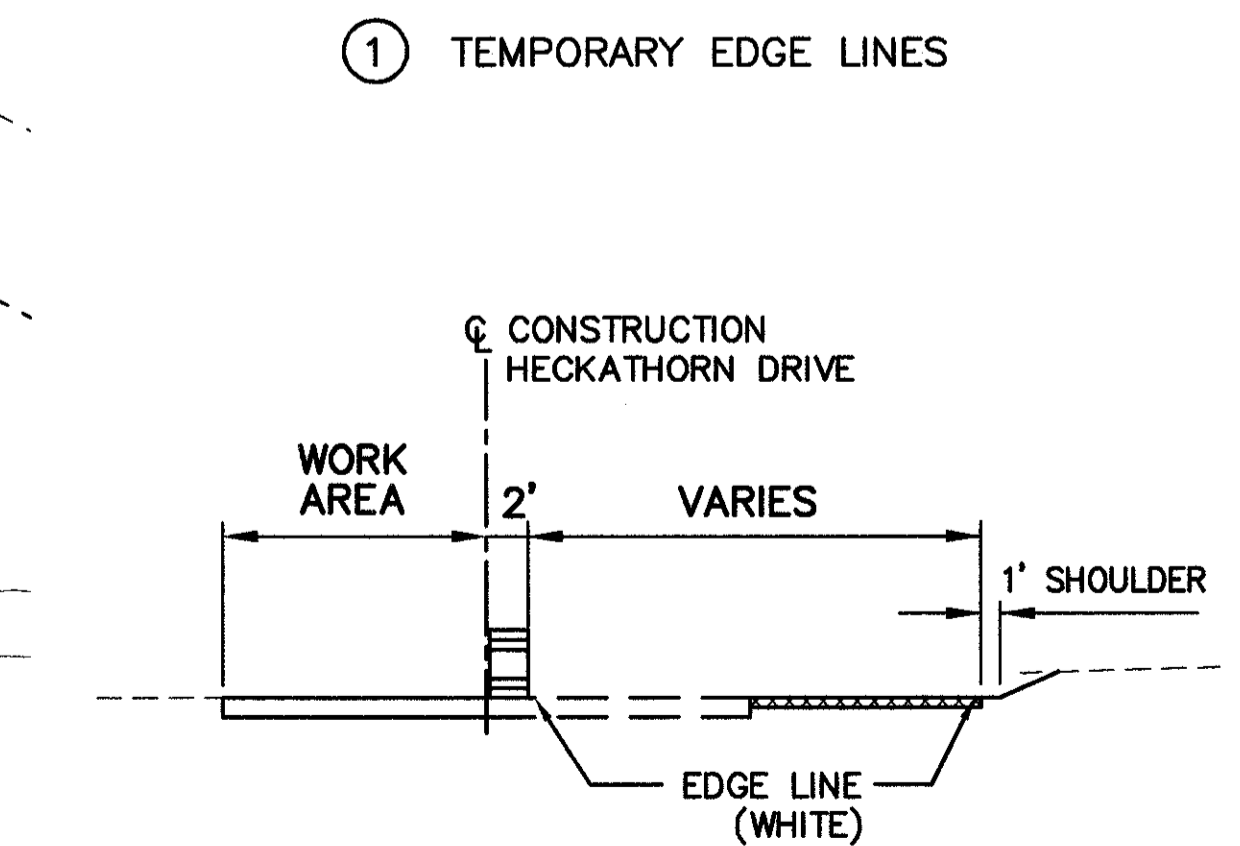

PART B TYPICAL SECTION

GRAPHIC SCALE
 1" = 20'
 1" = 40'
 1" = 80'

CALCULATED
 CHECKED

HECKATHORN DRIVE MAINTENANCE OF TRAFFIC
 SECTION 1 - PHASE 2 - PART A & B