

FORWARD ABUTMENT FOUNDATION PLAN

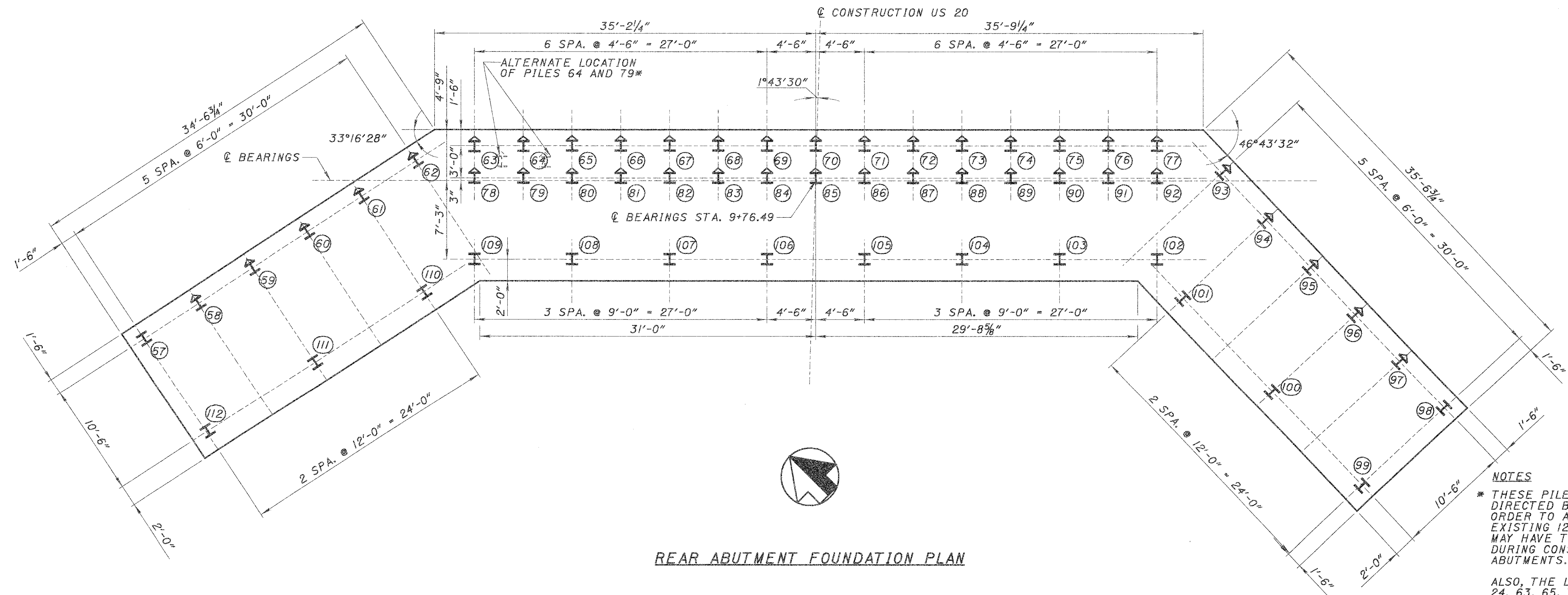

REAR ABUTMENT FOUNDATION PLAN

LEGEND
 I = VERTICAL PILE
 ↑ = BATTERED PILE

NOTES
 * THESE PILES MAY BE MOVED AS DIRECTED BY THE ENGINEER IN ORDER TO AVOID CONFLICT WITH THE EXISTING 12" DIA. WATERLINE WHICH MAY HAVE TO REMAIN IN PLACE DURING CONSTRUCTION OF THE ABUTMENTS.

ALSO, THE LOCATION OF PILES 7, 9, 22, 24, 63, 65, 78, AND 80 MAY ALSO BE ADJUSTED TO AVOID CONFLICTS WITH THE PILE DRIVING EQUIPMENT.

\$DATE\$
 \$FILE\$