

P:\PR22308\CADD\TSITE\PLN.DGN

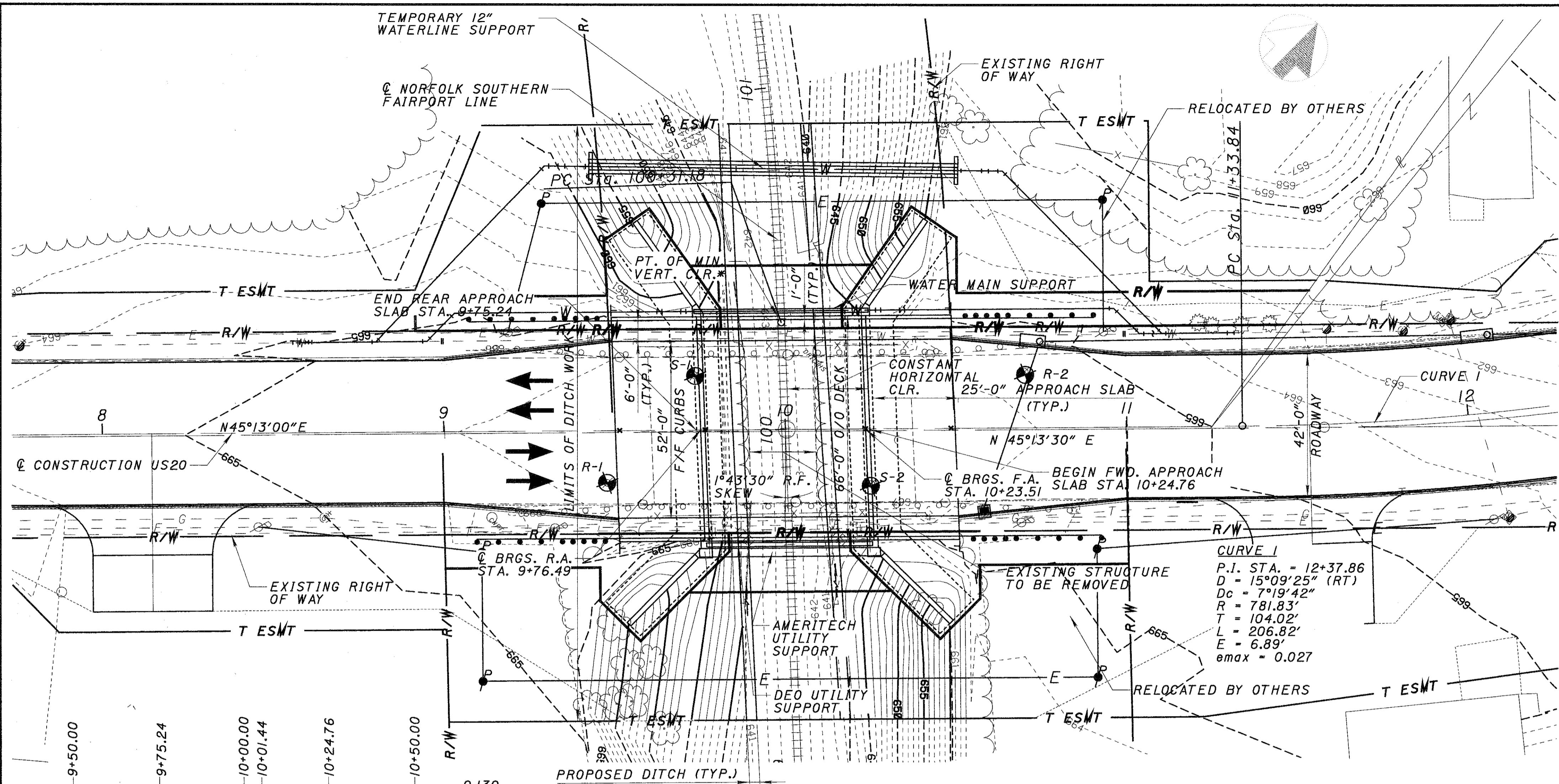

PLAN

SUPERELEVATION DIAGRAM

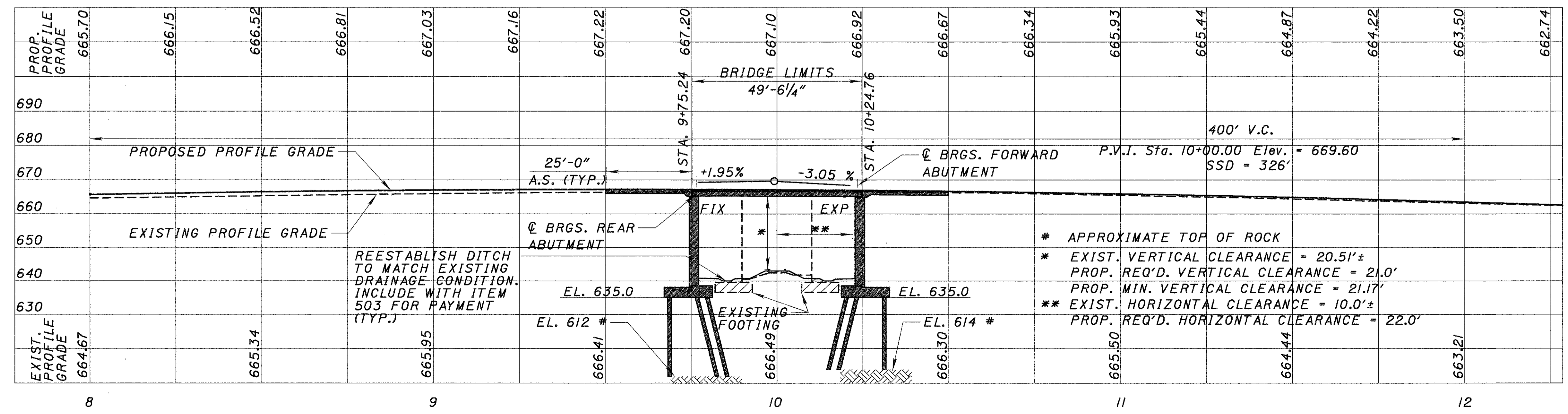

ELEVATION

ALONG Q CONSTRUCTION US20

TO BE REMOVED-INCLUDE WITH ITEM 202 FOR PAYMENT

FOR DITCH DETAIL SEE SHEET 8/22.

**BENCH MARK #1**  
 5/8" REBAR WITH RED CAP SET  
 STA. 10+90.39, 24.75 LT  
 ELEV. 665.47

**BENCH MARK #2**  
 5/8" REBAR WITH RED CAP SET  
 STA. 10+10.86, 116.17 RT  
 ELEV. 642.47

**NOTE:**  
 EARTHWORK LIMITS SHOWN ARE APPROXIMATE. ACTUAL SLOPES SHALL CONFORM TO PLAN CROSS SECTIONS.

STATION OF FIRST GUARDRAIL POST ADJACENT TO BRIDGE	
ABUTMENT	STATION
RIGHT REAR	9+47.04
LEFT REAR	9+45.12
RIGHT FORWARD	10+54.87
LEFT FORWARD	10+52.95

FOUNDATION DATA	
ESTIMATED PILE PAY LENGTH FOR HP 12 X 53 PILES	
REAR ABUTMENT: 28 FEET	
FORWARD ABUTMENT: 26 FEET	
TRAFFIC DATA	
CURRENT ADT (2002)	9300
DESIGN YEAR ADT (2002)	10900
DESIGN YEAR ADTT (2022)	10900
EXISTING STRUCTURE	
SFN:	4302281
TYPE:	PRESTRESSED CONCRETE BOX BEAM WITH REINFORCED CONCRETE SUBSTRUCTURE
SPAN:	21'-6 1/4" c/c BRGS.
ROADWAY:	43'-1" f/f CURBS
LOADING:	HS-20-44 & ALTERNATE MILITARY
WEARING SURFACE:	2 1/2" ASPHALT CONCRETE
ALIGNMENT:	TANGENT CROWN: 0.0156
APPROACH SLABS:	25' LONG (AS-1-81)
SKIEW:	1°48' R.F. DATE BUILT: 1981
PROPOSED STRUCTURE	
SFN:	4302303
TYPE:	SINGLE SPAN COMPOSITE PRESTRESSED BOX BEAM WITH REINFORCED CONCRETE SUBSTRUCTURE
SPAN:	47'-1/4" c/c BRGS
ROADWAY:	52'-0" f/f CURBS WITH 2 6'-0" SIDEWALKS
LOADING:	HS-25-44 & ALTERNATE MILITARY
WEARING SURFACE:	MONOLITHIC CONCRETE
ALIGNMENT:	TANGENT
APPROACH SLABS:	25' LONG (AS-1-81)
SKIEW:	1°43'30" R.F. CROWN: 0.0156 (LT ONLY)
SUPERELEVATION:	VARIES
LATITUDE:	N 41°44'39" LONGITUDE: E 81°13'55"

DESIGN AGENCY  
**Baker**  
 2000 EAST 91ST STREET, SUITE 1220  
 CLEVELAND, OHIO 44115

DATE  
 3-28-02

REVIEWED  
 RBP

STRUCTURE FILE NUMBER  
 4302303

DESIGNED  
 CDC

CHECKED  
 SCT

LAKE COUNTY  
 STA. 9+75.24  
 STA. 10+24.76

**SITE PLAN**  
 BRIDGE NO. LAK-20-1807  
 OVER NORFOLK SOUTHERN FAIRPORT LINE

LAK-20-18.07

1 / 22

42  
 72