

CURVE DATA
 P.I. STA = 26+51.20
 D = 4° 18' 09" (RT)
 Dc = 0° 48' 00"
 R = 7,161.97'
 T = 269.03'
 L = 537.82'
 E = 5.05'

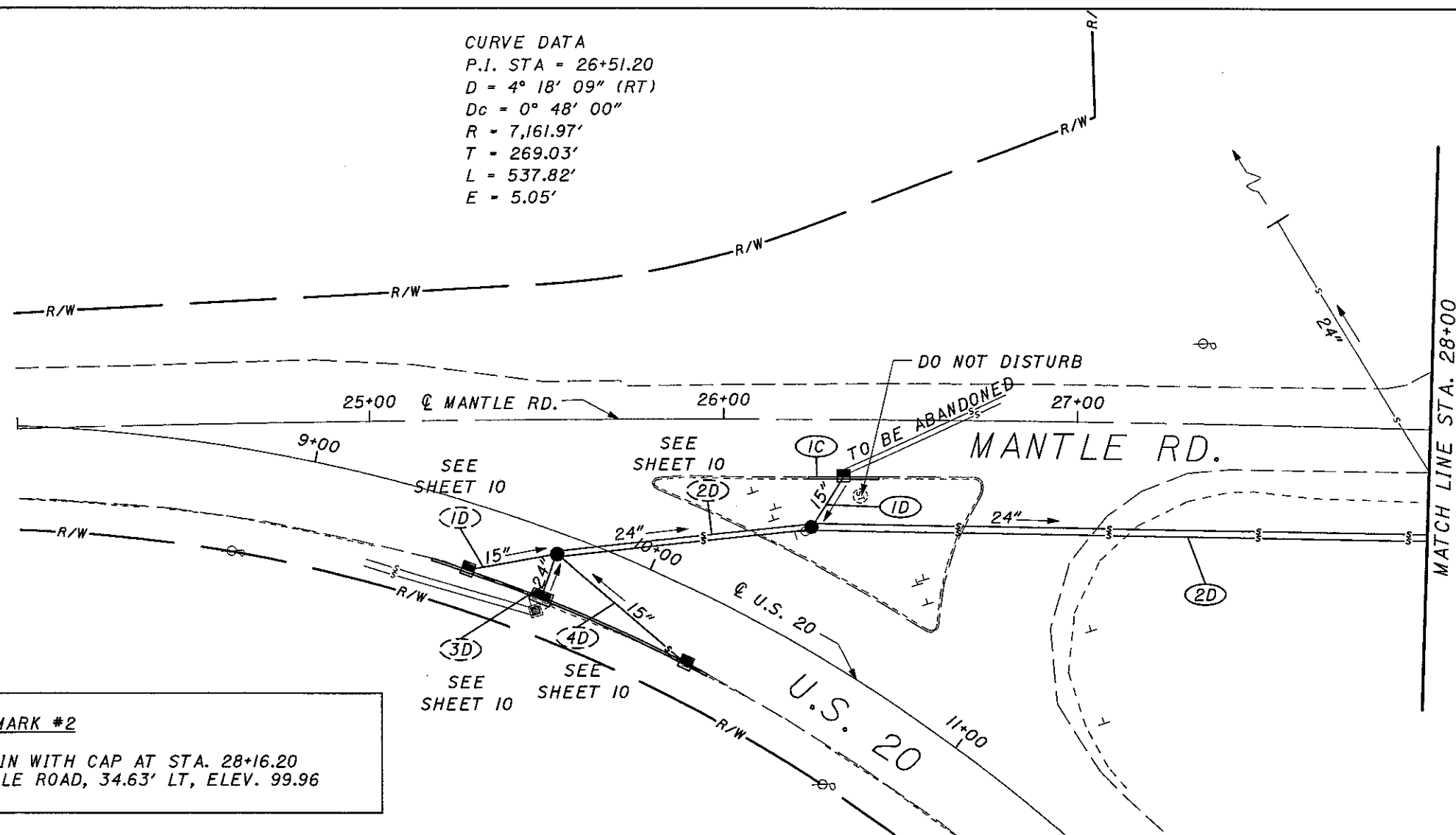

BENCHMARK #2

IRON PIN WITH CAP AT STA. 28+16.20
 @ MANTLE ROAD, 34.63' LT, ELEV. 99.96

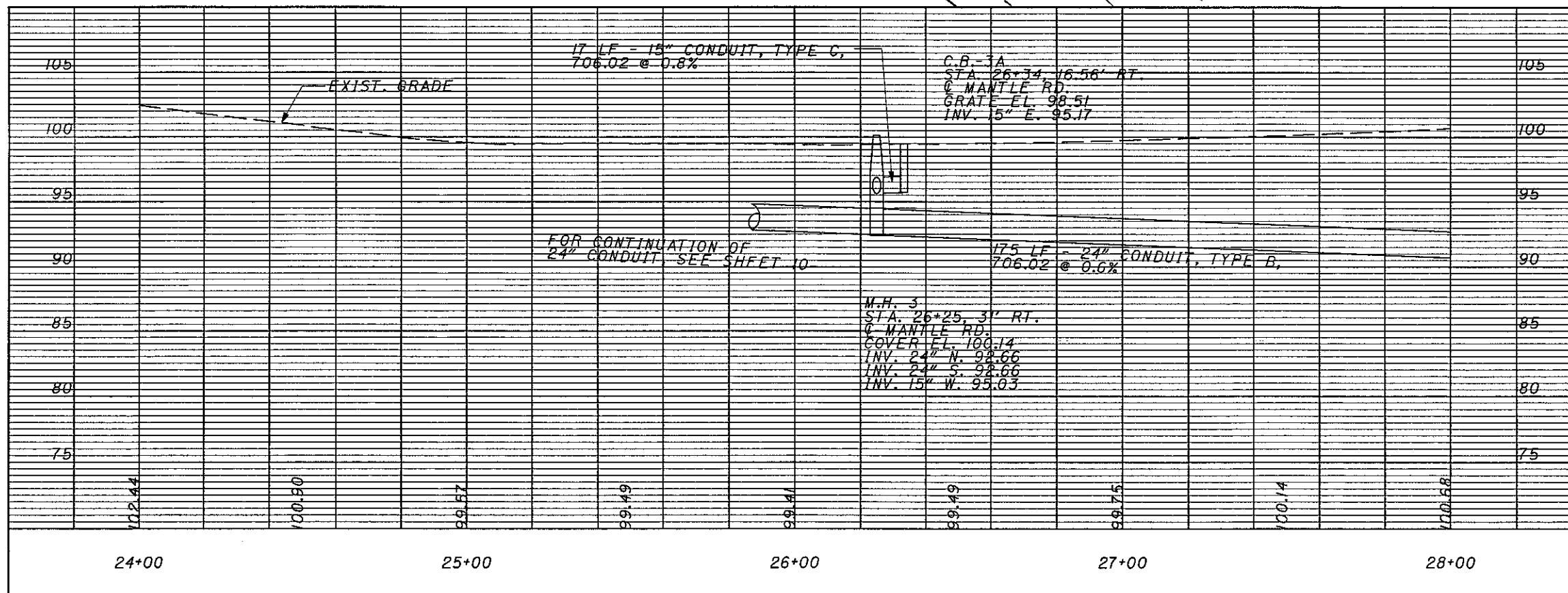

REF NO.	STATION		SIDE	ITEM	QUANTITY	UNIT
	FROM	TO				
ID	26+34	26+25	RT	CATCH BASIN REMOVED	1	EACH
2D	26+25	28+50	RT	15" CONDUIT, TYPE C	17	LIN FT
IC	26+24	26+44	RT	24" CONDUIT, TYPE B	175	LIN FT
				MANHOLE, NO. 3	1	EACH
				CATCH BASIN, NO. 3A	1	EACH
				6" SHALLOW PIPE UND. W/FABRIC WRAP	20	EACH
				CURB, TYPE 6	15	LIN FT
TOTALS CARRIED TO GENERAL SUMMARY						

**PLAN AND PROFILE - MANTLE RD.
 STA. 24+00 TO STA. 28+00**

LAK-20-17.60

11
16

CALCULATED CRP
 CHECKED BF

HORIZONTAL SCALE IN FEET