

OHIO DEPARTMENT OF TRANSPORTATION

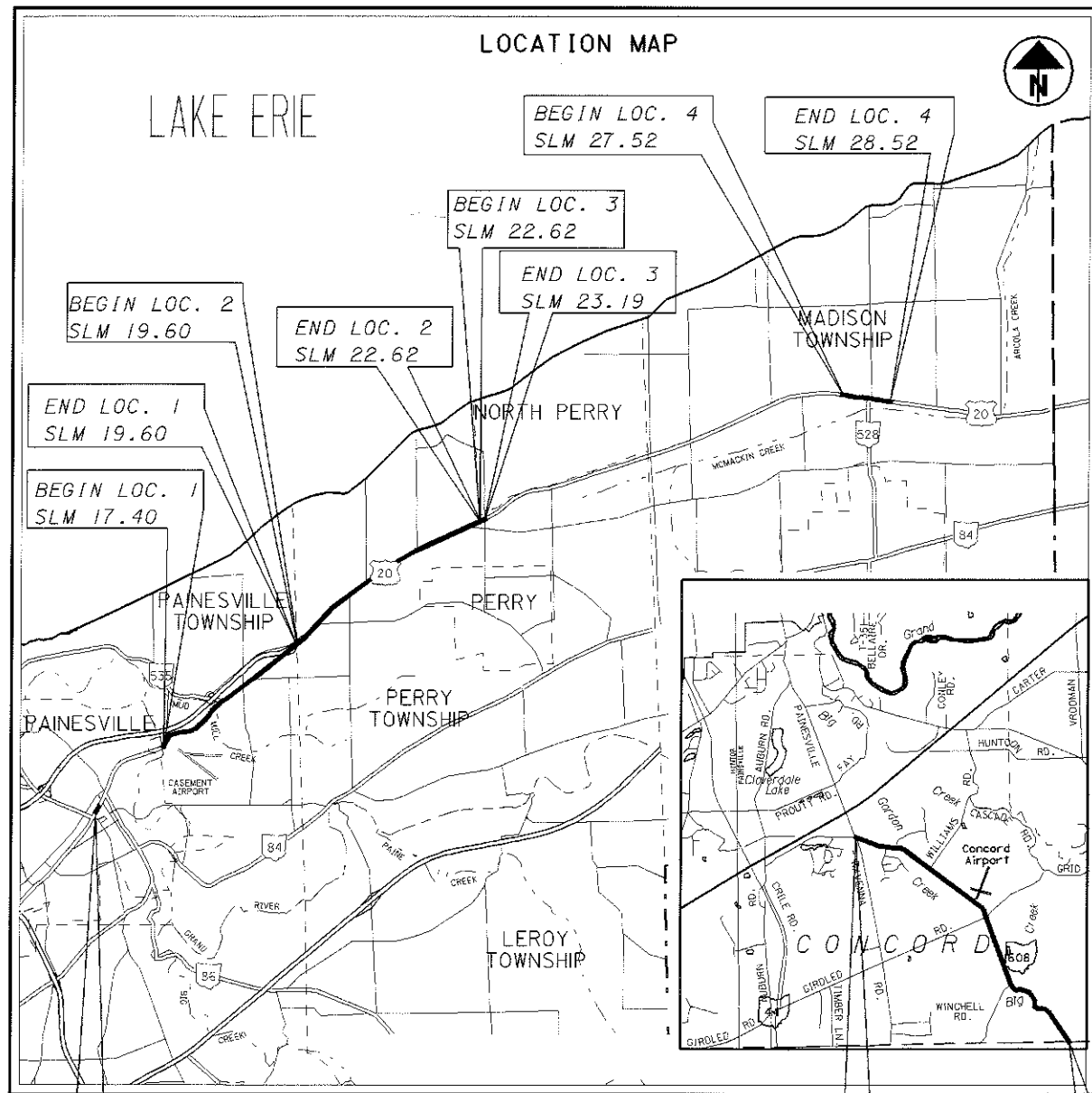

— PORTION TO BE IMPROVED
 LAT. - N 41°44'18" LONG. - W 81°13'41"

LOCATION	COUNTY	ROUTE	SECTIONS	PROJECT TERMINII		NET LENGTH MI	TOWNSHIP	VILLAGE OR MUNICIPALITY
				BEGIN	END			
1	LAK	US-20	17.40	17.40	19.60	2.20	PAINESVILLE	
2	LAK	US-20		19.60	22.62	3.02	PERRY	
3	LAK	US-20		22.62	23.19	0.57		NORTH PERRY
4	LAK	US-20		27.52	28.52	1.00	MADISON	
5	LAK	SR-608	0.00	0.00	3.57	2.96	CONCORD	
6	LAK	US-20	15.59	15.59	15.59			PAINESVILLE

INDEX OF SHEETS:

TITLE SHEET	1
TYPICAL SECTIONS	2-4
GENERAL NOTES	5-13
SUB-SUMMARIES	14-21
GENERAL SUMMARY	22

1997 SPECIFICATIONS

The standard specifications of the State of Ohio, Department of Transportation, including changes and supplemental specifications listed in the proposal shall govern this improvement.

I hereby approve these plans and declare that the making of this improvement will not require the closing to traffic of the highway and that provisions for the maintenance and safety will be as set forth on plans and estimates.

Approved: 
 Date: 3/14/00 District Deputy Director of Transportation

Approved: 
 Date: 12-7-00 Director, Department of Transportation

STANDARD DRAWINGS		STANDARD DRAWINGS		STANDARD DRAWINGS		SUPPLEMENTAL SPECIFICATIONS	
BP-3.1	07-28-00	RM-1.1	04-29-99	MT-95.31M	04-25-94	828	07-28-98
GR-1.1M	10-21-97	TC-65.10M	11-01-95	MT-95.32M	04-25-94	877	04-13-99
GR-1.2M	01-03-96	TC-65.11M	11-01-95	MT-97.10M	04-25-94	906	05-05-98
GR-1.3M	11-30-94	TC-65.12M	11-01-95	MT-97.11M	01-30-95	908	01-06-99
GR-2.1M	04-14-98	TC-71.10M	09-01-93	MT-105.10M	04-25-94		
GR-3.1M	10-21-97	TC-82.10	01-19-99	MT-105.11M	04-25-94		
GR-4.1M	11-30-94	TC-82.11	01-19-99				
GR-4.2M	10-21-97						

UNDERGROUND UTILITIES
 TWO WORKING DAYS
BEFORE YOU DIG
 CALL 1-800-362-2764 (TOLL FREE)
 OHIO UTILITIES PROTECTION SERVICE
 NON-MEMBERS
 MUST BE CALLED DIRECTLY

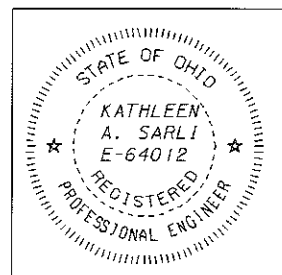

PLAN PREPARED BY:
 OHIO DEPARTMENT OF
 TRANSPORTATION
 DISTRICT 12
 PRODUCTION DEPARTMENT

LAK - USR 20 - 17.40/Variou
 010099 PID - 14200
 Dist 12 2/21/01

FEDERAL PROJECT NO. NON-FEDERAL
 PID NO. 14200
 CONSTRUCTION PROJECT NO.
 RAILROAD INVOLVEMENT NONE
 LAKE COUNTY LAK-20-17.40
 1/22