

Present & Proposed Sub-Way Clearance.
 145' Vertical.
 30' Pavement with 4' sidewalks on each side.

Sta. 2+0 to Sta. 7+25
 2200 lin. ft. 6" Drain tile in place 30" deep, cinder or gravel backfill, used as lateral or diagonal drains x 12-12"x6" Ys for drain tile connections as directed by the Engineer.

Note: Shaded area designates route for traffic while remaining portion is under construction.

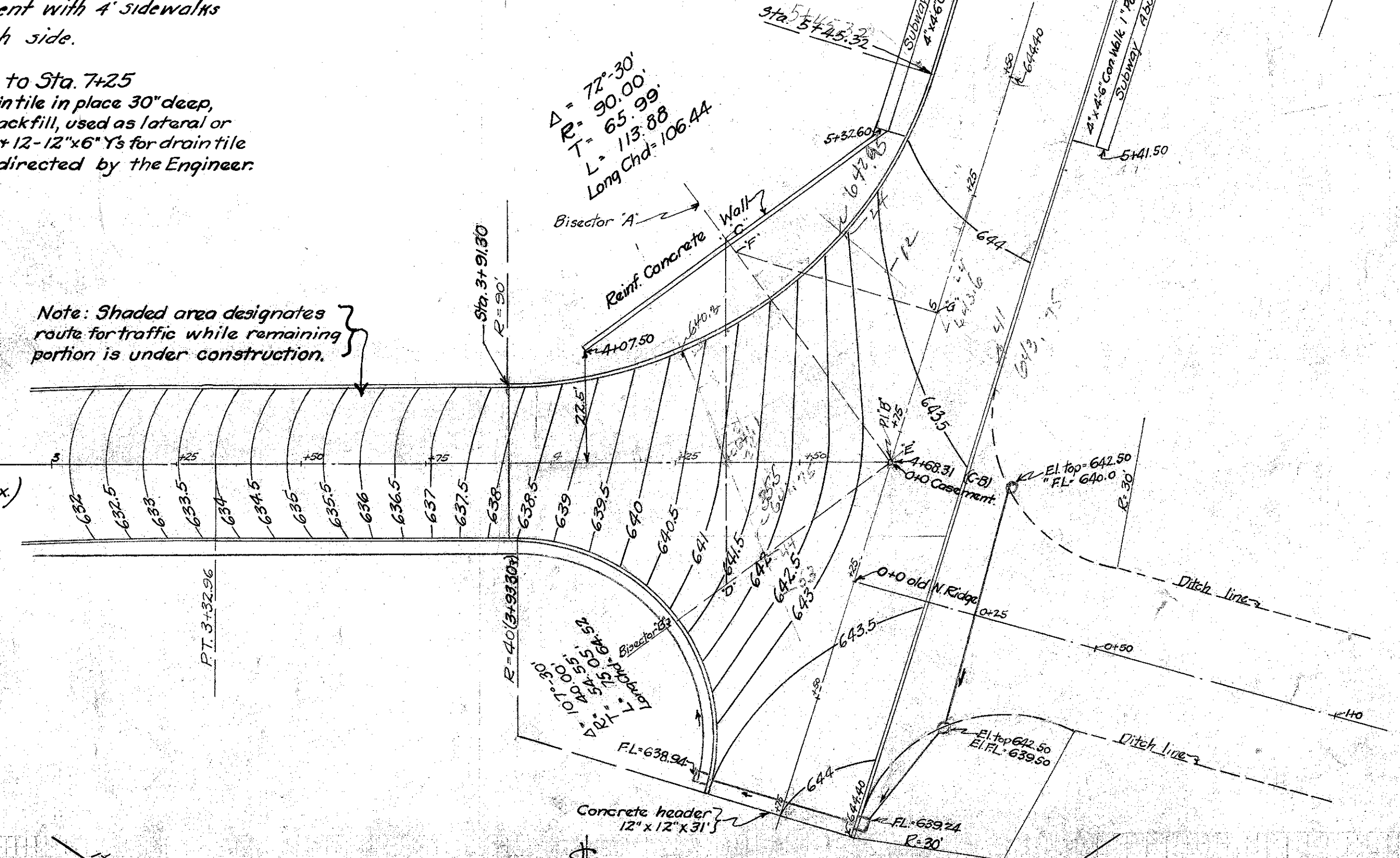

B.M. #1 Sta. 1+25
 Knob 2" Step E. Wall old tunnel
 40' L. of Φ
 Elevation 618.61

B.M. #2 Sta. 5+33
 Knob S. End West curb Subway
 14' L. of Φ
 Elevation 646.29

B.M. #3 Sta. 3+28
 Spike in T.P.
 16' R. of Φ
 Elevation 656.39

