

R/W
& CONSTRUCTION

LAKE COUNTY
LAK-20-15.75

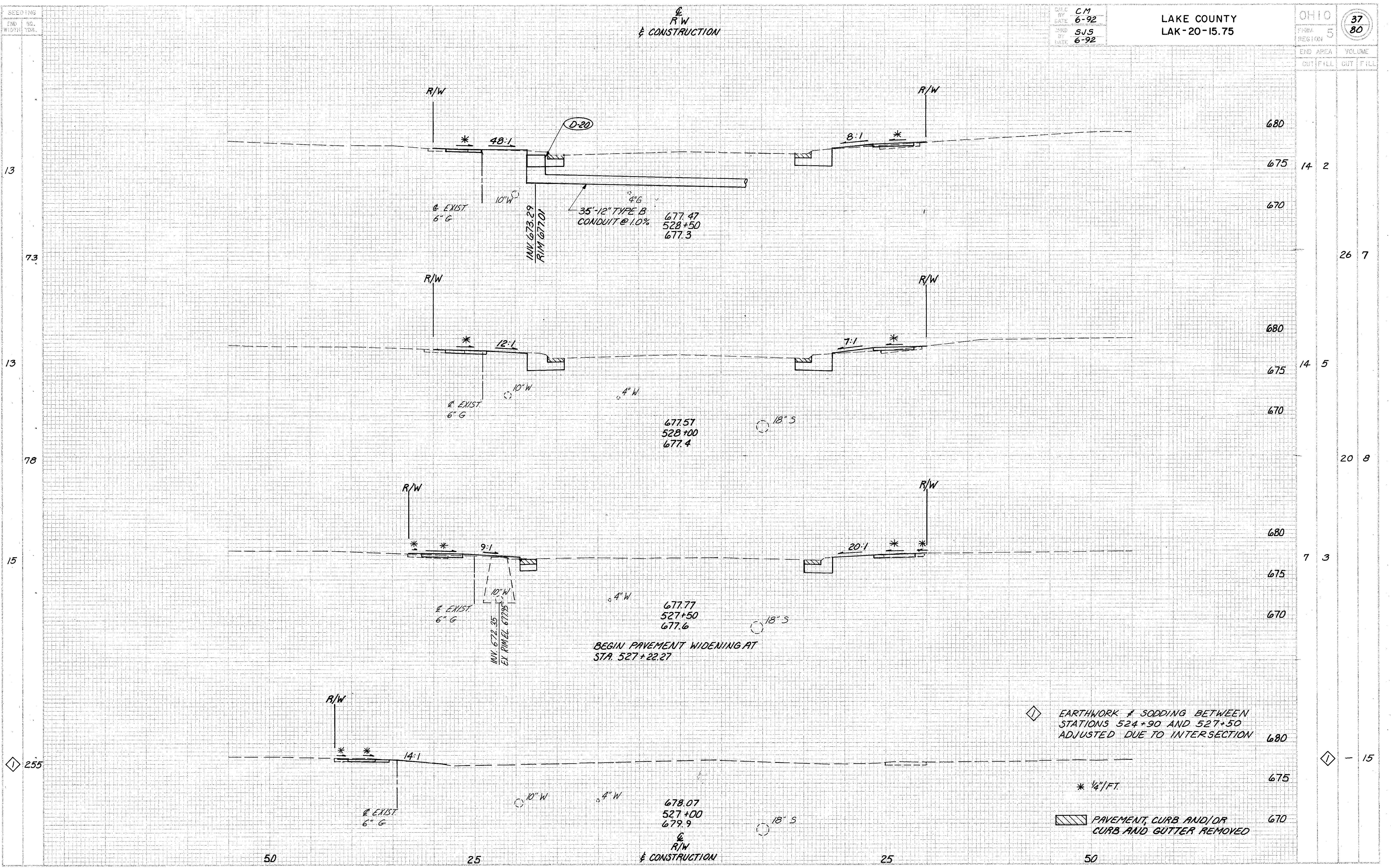

END AREA	VOLUME
CUT	FILL
14	2
26	7
14	5
20	8
7	3
	15

◇ EARTHWORK & SODDING BETWEEN STATIONS 524+90 AND 527+50 ADJUSTED DUE TO INTERSECTION

* 1/4" / FT.

▨ PAVEMENT, CURB AND/OR CURB AND GUTTER REMOVED