

- WEARING COURSE REMOVED
- PAVEMENT TRENCH, SEE DETAIL, SHEET 20

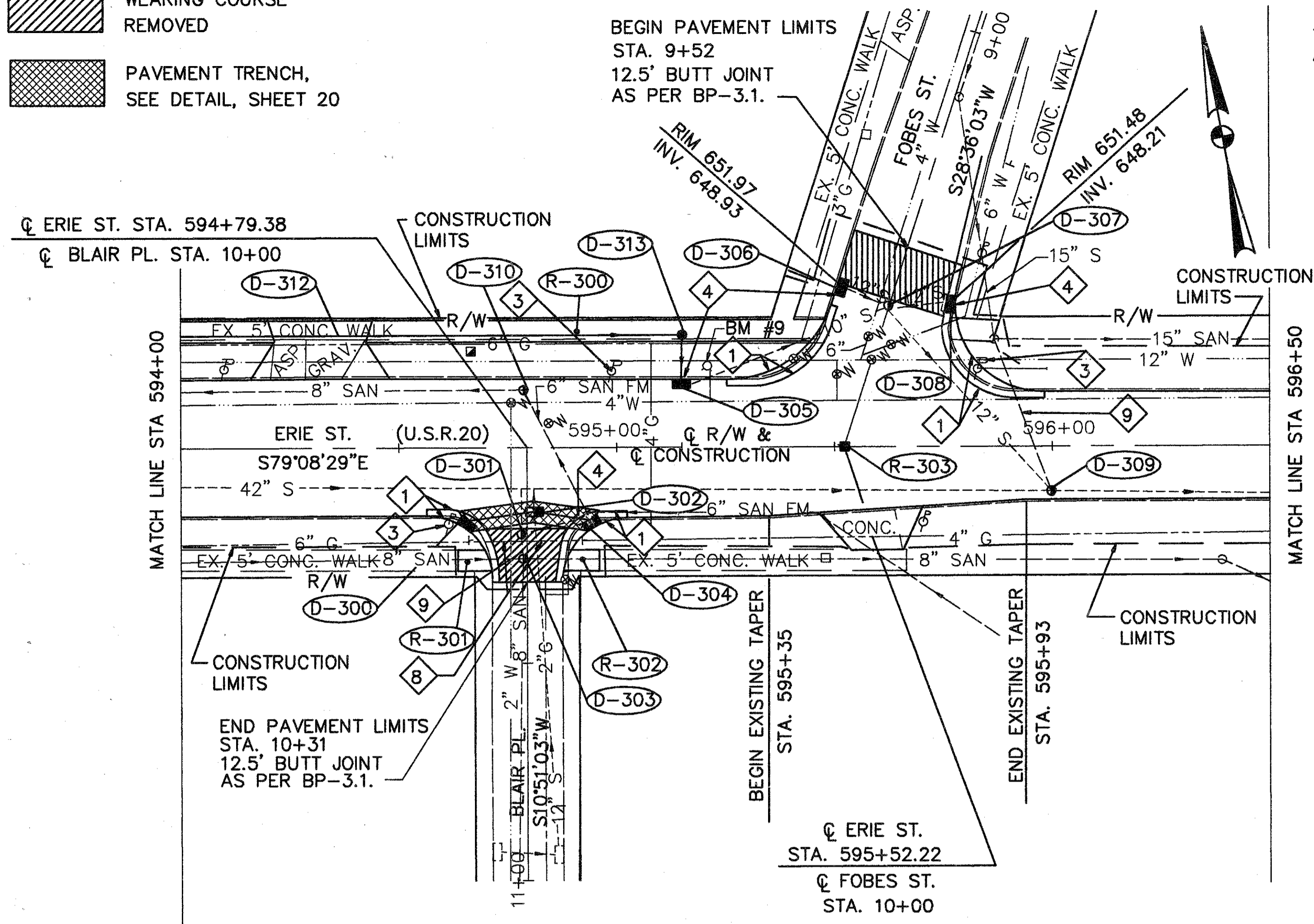

- 1 PAVEMENT WIDENING LIMITS
- 3 TO BE RELOCATED BY OTHERS
- 4 EXISTING CATCH BASIN OR MANHOLE & APPURTENANCES TO BE REMOVED. COST TO BE INCLUDED IN THE UNIT PRICE FOR THE APPROPRIATE ITEM 604 CATCH BASIN OR MANHOLE ITEM.
- 8 CONCRETE PIPE ENCASEMENT. COST TO BE INCLUDED IN UNIT PRICE BID FOR ITEM 603 12" CONDUIT, TYPE B, 706.02, AS PER PLAN. SEE DETAIL THIS SHEET.
- 9 EMERGENCY OVERFLOW. DO NOT DISTURB.

| REF. | FROM | TO | SIDE | SQ. FT. | ROADWAY | | | | | | |
|-------|-----------|--------|------|---------|--------------|--------------------|--------------------|------------------|-------------------|-------------------|----|
| | | | | | WALK REMOVED | MONUMENT BOX FRAME | MONUMENT BOX COVER | 4" CONCRETE WALK | CURB RAMP, TYPE 1 | CURB RAMP, TYPE 2 | |
| R-300 | 594+00 | 595+88 | LT. | 718 | | | | | | | |
| R-301 | 594+71 | | RT. | 31 | | | | | | | 30 |
| R-302 | 594+89 | | RT. | 36 | | | | | | | 35 |
| R-303 | 595+52.22 | | | | | 1 | 1 | | | | |
| TOTAL | | | | 785 | | 1 | 1 | 708 | 2 | | 65 |

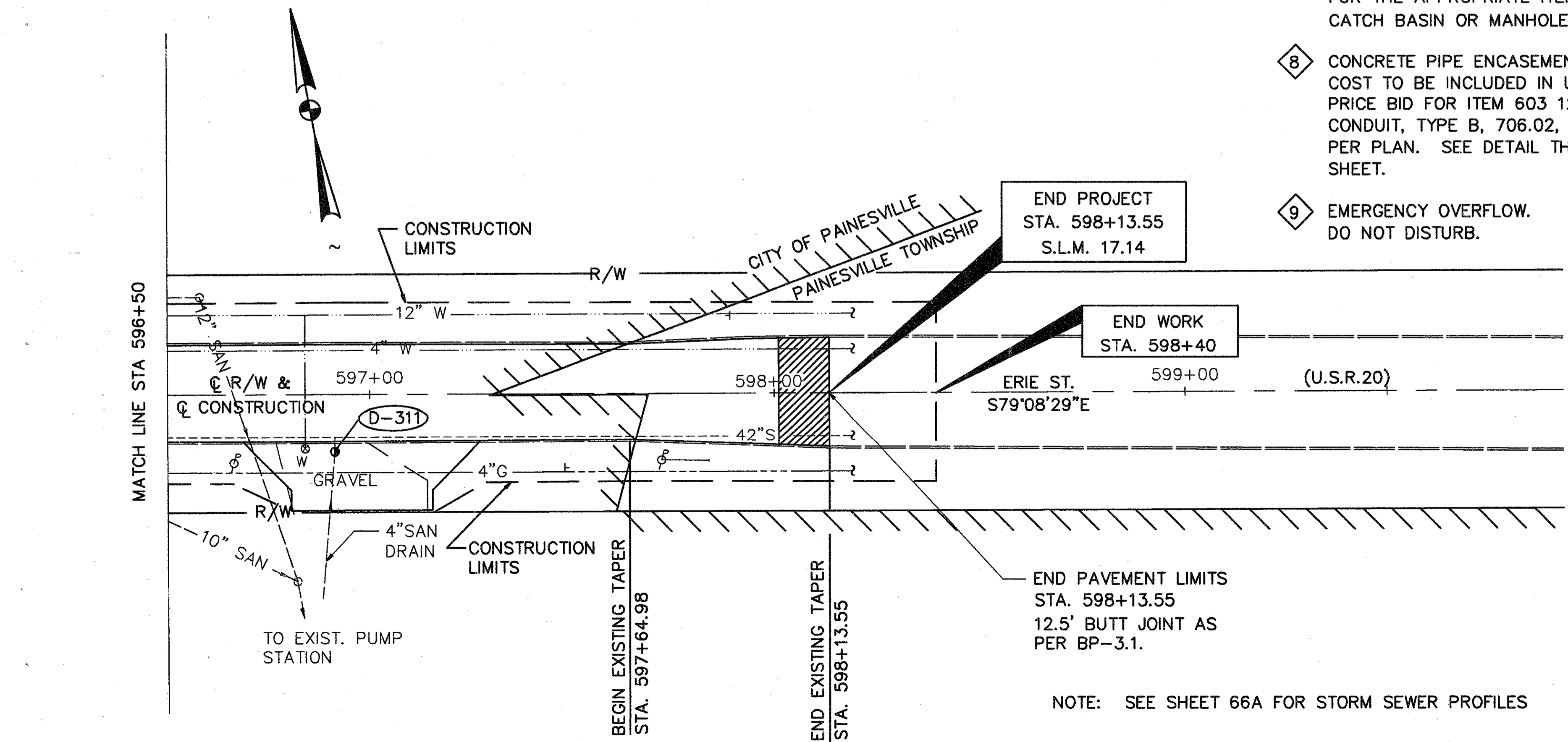

| REF. | FROM | TO | SIDE | DRAINAGE | | | | | | | | | | | |
|-------|-------------------|--------|----------|--|--|-----------------------------|----------------------------------|--|----------------|--|----------------------------------|------------------|---|-------------------------------------|----|
| | | | | 12" CONDUIT, TYPE B, 706.08, AS PER PLAN | 12" CONDUIT, TYPE B, 706.02, AS PER PLAN | 12" CONDUIT, TYPE C, 706.02 | CATCH BASIN, NO. 3A, AS PER PLAN | CATCH BASIN ADJUSTED TO GRADE, AS PER PLAN | MANHOLE, NO. 3 | MANHOLE ADJUSTED TO GRADE, AS PER PLAN | BITUMINOUS AGGREGATE BASE, AC-20 | PAVEMENT REMOVED | LOW STRENGTH MORTAR BACKFILL MATERIAL, CLASS LSM-50 | 12" CONDUIT TYPE B, 706.02, ENCASED | |
| D-300 | 594+65 | | 17.9'RT. | | | | 1 | | | | | 3.0 | 8.9 | 0.3 | 16 |
| D-301 | 594+78 | | 20'RT. | | | | | | 1 | | | 2.6 | 7.8 | | |
| D-302 | 594+81 | | 15'RT. | | | | | 1 | | | | | | | |
| D-303 | 10+26 (BLAIR PL.) | | 1'RT. | | | | | | | 1 | | | | | |
| D-304 | 594+95 | | 16.8'RT. | | | | 1 | | | | | | | | 14 |
| D-305 | 595+15 | | 14.4'LT. | 8 | | | 1 | | | | | | | 3.2 | |
| D-306 | 9+65 (FOBES ST.) | | 10.9'RT. | | 8 | | 1 | | | | | | | 2.4 | |
| D-307 | 9+65 (FOBES ST.) | | 10.9'RT. | | 8 | | | | | 1 | | | | | |
| D-308 | 9+61 (FOBES ST.) | | 10.9'RT. | | 8 | | 1 | | | | | | | 2.9 | |
| D-309 | 596+00 | | 10'RT. | | | | | | | 1 | | | | | |
| D-310 | 594+78 | | 13'RT. | | | | | | | 1 | | | | | |
| D-311 | 596+91 | | 15'RT. | | | | | | | 1 | | | | | |
| D-312 | 594+00 | 595+15 | 26'LT. | | | 115 | | | | | | | | | |
| D-313 | 595+15 | | 26'LT. | | | 12 | | | | 1 | | | | | |
| TOTAL | | | | 8 | 16 | 127 | 5 | 1 | 1 | 6 | 5.6 | 16.7 | 8.8 | 30 | |

NOTE: SEE SHEET 66A FOR STORM SEWER PROFILES