

WEARING COURSE REMOVED

PAVEMENT TRENCH, SEE DETAIL, SHEET 20.

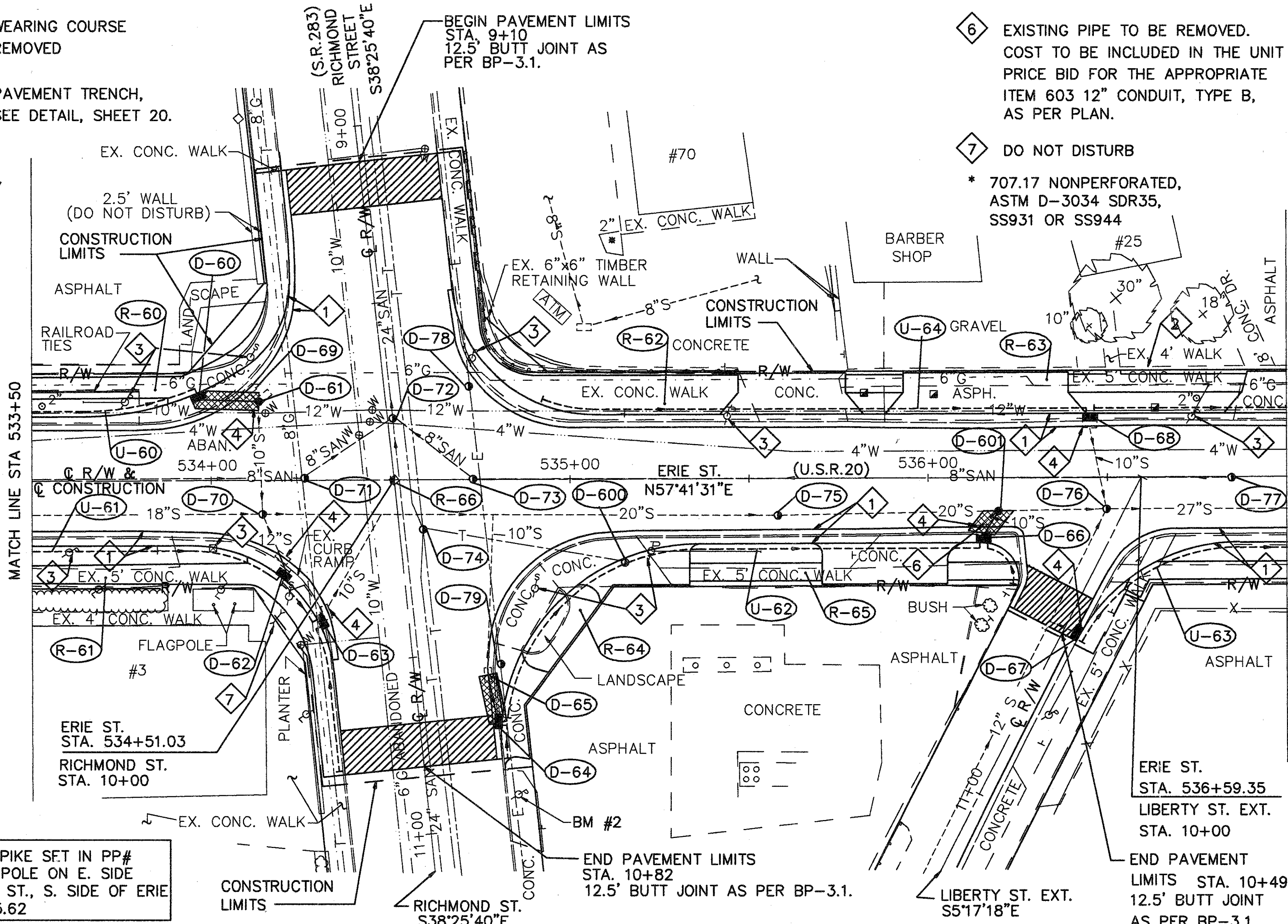
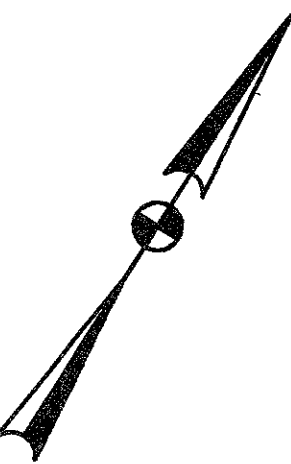

BM #2 R/R SPIKE SET IN PP# PC2029, 1st. POLE ON E. SIDE OF RICHMOND ST., S. SIDE OF ERIE ST. ELEV. 675.62

- 6 EXISTING PIPE TO BE REMOVED. COST TO BE INCLUDED IN THE UNIT PRICE BID FOR THE APPROPRIATE ITEM 603 12" CONDUIT, TYPE B, AS PER PLAN.
- 7 DO NOT DISTURB
- * 707.17 NONPERFORATED, ASTM D-3034 SDR35, SS931 OR SS944

STATION	TYPE
534+10, LT.	1
534+13, RT. (RICHMOND ST.)	2
10+28, RT. (RICHMOND ST.)	2
534+97 RT.	1
9+73, LT. (RICHMOND ST.)	2
534+98, LT.	2
536+25, RT.	2
536+60, RT.	2

- 1 PAVEMENT WIDENING LIMITS
- 2 FOR WALK REMOVAL LIMITS, SEE TYPICAL SECTIONS, SHT. 4
- 3 TO BE RELOCATED BY OTHERS
- 4 EXISTING CATCH BASIN OR MANHOLE & APPURTENANCES TO BE REMOVED. COST TO BE INCLUDED IN THE UNIT PRICE FOR THE APPROPRIATE ITEM 604 CATCH BASIN OR MANHOLE ITEM.

ROADWAY				202	604	608	608	608
REF.	FROM	TO	SIDE	SQ. YD.	EACH	SQ. YD.	EACH	EACH
R-60	533+50	534+50	LT.	824		706	1	
R-61	533+50	534+50	RT.	844		744		2
R-62	534+50	535+48	LT.	1348		1090		2
R-63	534+78	537+00	LT.	560		441		
R-64	534+86	535+10	RT.	220		262	1	
R-65	535+20	537+00	RT.	675		535		2
R-66	534+51.03							
TOTAL				4471	1	3778	2	6

DRAINAGE															
REF.	FROM	TO	SIDE	603 LIN. FT.	603 LIN. FT.	604 EACH	604 EACH	604 EACH	604 EACH	605 LIN. FT.	603 LIN. FT.	202 EACH	301 CU. YD.	202 SQ. YD.	SPEC. CU. YD.
D-60	533+96		23.1'LT.		18		1						2.1	6.3	6.3
D-61	534+14		22'LT.					1							2.6
D-62	534+20		26.2'RT.		8										4.8
D-63	534+31		39.9'RT.	8											4.8
D-64	10+70 (RICHMOND ST.)		21.9'LT.	17			1						2.6	7.8	7.4
D-65	10+57 (RICHMOND ST.)		20'LT.									1			6.2
D-66	536+15		17.7'RT.		10	1							1.9	5.7	6.3
D-67	10+47 (LIBERTY ST. EXT.)		3.9'LT.		8		1								5.4
D-68	536+44		16.9'LT.	8			1								4.2
D-69	534+11		25'LT.									1			
D-70	534+14		10'RT.					1							
D-71	534+26		1'LT.					1							
D-72	534+51		17'LT.					1							
D-73	534+73							1							
D-74	534+59		13'RT.					1							
D-75	535+59		10'RT.					1							
D-76	536+50		10'RT.					1							
D-77	536+85							1							
D-78	534+72		26'LT.					1							
D-79	10+54 (RICHMOND ST.)		24'LT.					1							
D-600	535+16		23'RT.					1							
D-601	536+19		9.5'RT.												
U-60	533+50	534+06	LT.							92	10				
U-61	533+50	10+82 (RICHMOND ST.)	RT.							134	30				
U-62	10+82 (RICHMOND ST.)	10+49 (LIB. ST. EXT.)	RT.							197	30				
U-63	536+32	537+00	RT.							68					
U-64	534+94	537+00	LT.							207	10				2.9
TOTAL				33	44	1	6	11	1	698	80	3	6.6	19.8	50.9

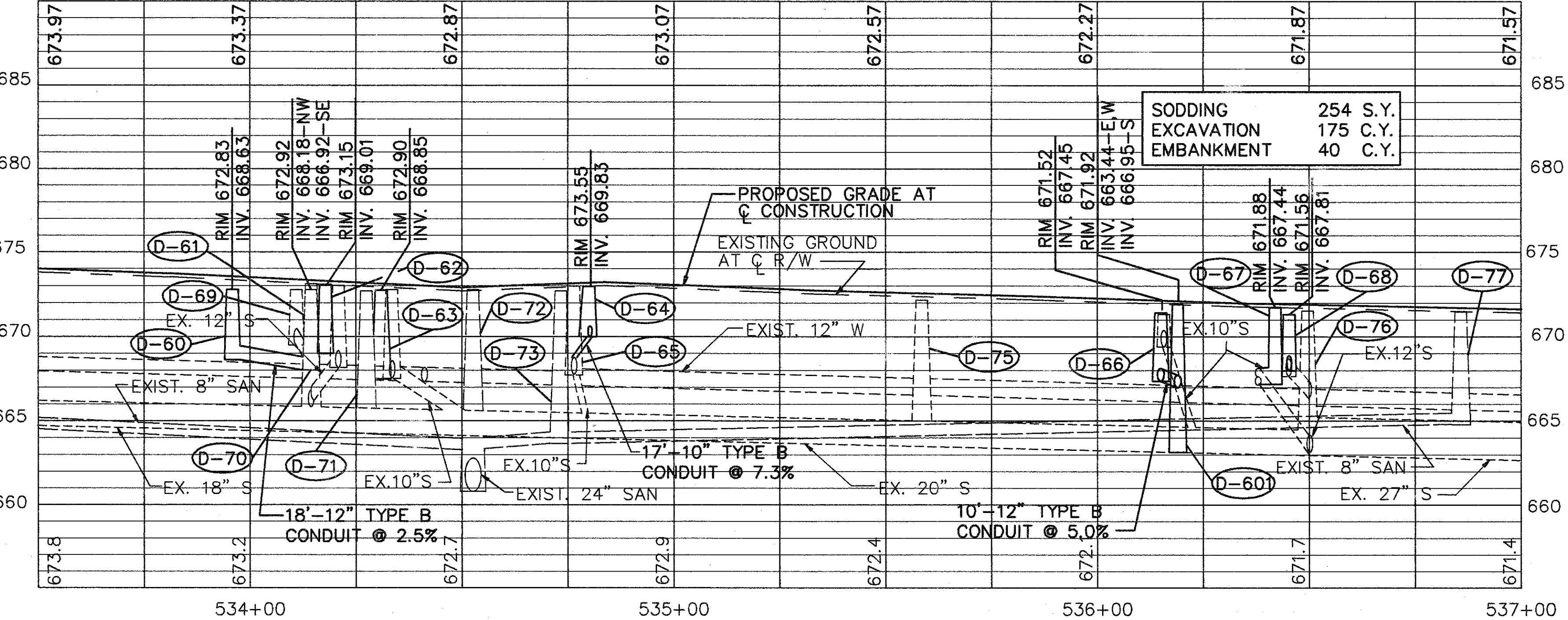

STA. 533+50 TO STA. 537+00