

- BUTT JOINT INTO BRICK PAVEMENT. SEE DETAIL ON SHEET 20.
- WEARING COURSE REMOVED

CALC BY DAS
DATE 6/92
CHKD BY SJS
DATE 6/92

LAKE COUNTY
LAK-20-15.75

OHIO
FHWA REGION 5

21
80

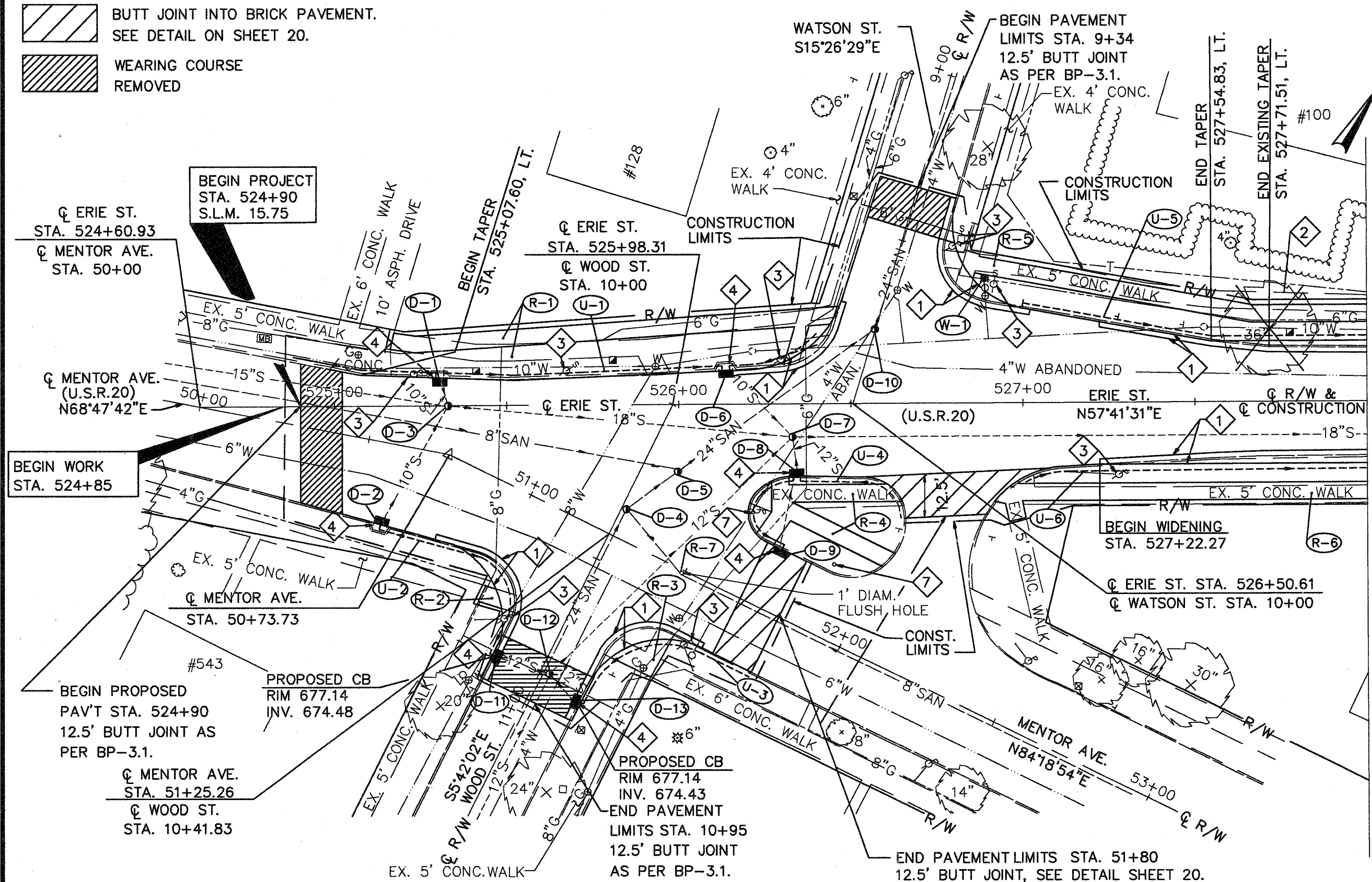

STATION	TYPE
526+34, LT.	2
9+77, RT. (WATSON ST.)	2
526+83, LT.	2
10+73, RT. (WOOD ST.)	2
10+70, LT. (WOOD ST.)	2
51+53, RT. (MENTOR AVE.)	2
526+25, RT.	2
526+29, RT.	2
526+60, RT.	2
526+63, RT.	2
526+96, RT.	1

- 1 PAVEMENT WIDENING LIMITS
- 2 FOR WALK REMOVAL LIMITS, SEE TYPICAL SECTIONS, SHEETS 3 & 4
- 3 TO BE RELOCATED BY OTHERS
- 4 EXISTING CATCH BASIN OR MANHOLE & APPURTENANCES TO BE REMOVED. COST TO BE INCLUDED IN THE UNIT PRICE FOR THE APPROPRIATE ITEM 604 CATCH BASIN OR MANHOLE ITEM
- 7 WOOD GUARD POST

REF.	LOCATION	SIDE	SO. FT.	202	SPEC.	608	608	608	638	638
				WALK REMOVED	ABANDON MISCELLANEOUS: FLUSH HOLE	4" CONCRETE WALK	CURB RAMP, TYPE 1	CURB RAMP, TYPE 2	6" WATER MAIN DUCTILE IRON PIPE ANSI CL-52, MECHANICAL JOINTS & FITTINGS, AS PER PLAN	FIRE HYDRANT REMOVED & RESET, AS PER PLAN
R-1	525+17	526+46	LT	684		685		2		
R-2	525+42	525+48	RT	50		30		1		
R-3	525+80	525+98	RT	130		105		2		
R-4	526+22	562+65	RT	557		420		4		
R-5	526+81	528+00	LT	600		600		1		
R-6	526+92	528+00	RT	616		608	1			
R-7	51+49 (MENTOR AVE.)		1'RT		1					
W-1	526+89		37'LT						6	1
TOTAL				2637	1	2448	1	10	6	1

REF.	FROM	TO	SIDE	LIN. FT.	603	603	604	604	605	603	SPECIAL
				12" CONDUIT, TYPE B 706.08, AS PER PLAN	12" CONDUIT, TYPE B, 706.02, AS PER PLAN	CATCH BASIN, NO. 3A, AS PER PLAN	MANHOLE ADJUSTED TO GRADE, AS PER PLAN	6" SHALLOW PIPE UNDER DRAIN WITH FABRIC WRAP		6" CONDUIT, TYPE F, 707.17 NONPERFORATED, ASTM D-3034 SDR35, SS931 OR SS944	LOW STRENGTH MORTAR BACKFILL MATERIAL, CLASS LSM-50
D-1	525+31		6.9'LT.	8			1				2.1
D-2	525+13		33.8'RT.	8			1				2.1
D-3	525+33							1			
D-4	525+84		30'RT.					1			
D-5	525+99		20'RT.					1			
D-6	526+14		8.9'LT.	8			1				1.4
D-7	526+33		9'RT.					1			
D-8	526+34		20.1'RT.		8		1				1.5
D-9	526+29		42.2'RT.		8		1				1.5
D-10	526+57		22'LT.					1			
D-11	10+88(WOOD ST.)		12.9'RT.		8		1				1.5
D-12	10+86(WOOD ST.)		2'LT.					1			
D-13	10+90(WOOD ST.)		12.9'LT.		8		1				1.7
U-1	524+90	526+40	LT.						142	30	
U-2	525+13	10+88 (WOOD ST.)	RT.						61	10	
U-3	10+90	51+80 (WOOD ST.)(MENTOR AVE)	RT.						60	10	
U-4	ISLAND								70	30	
U-5	527+00	528+00	LT.						100		
U-6	527+10	528+00	RT.						90		
TOTAL					24	32	7	6	523	80	11.8

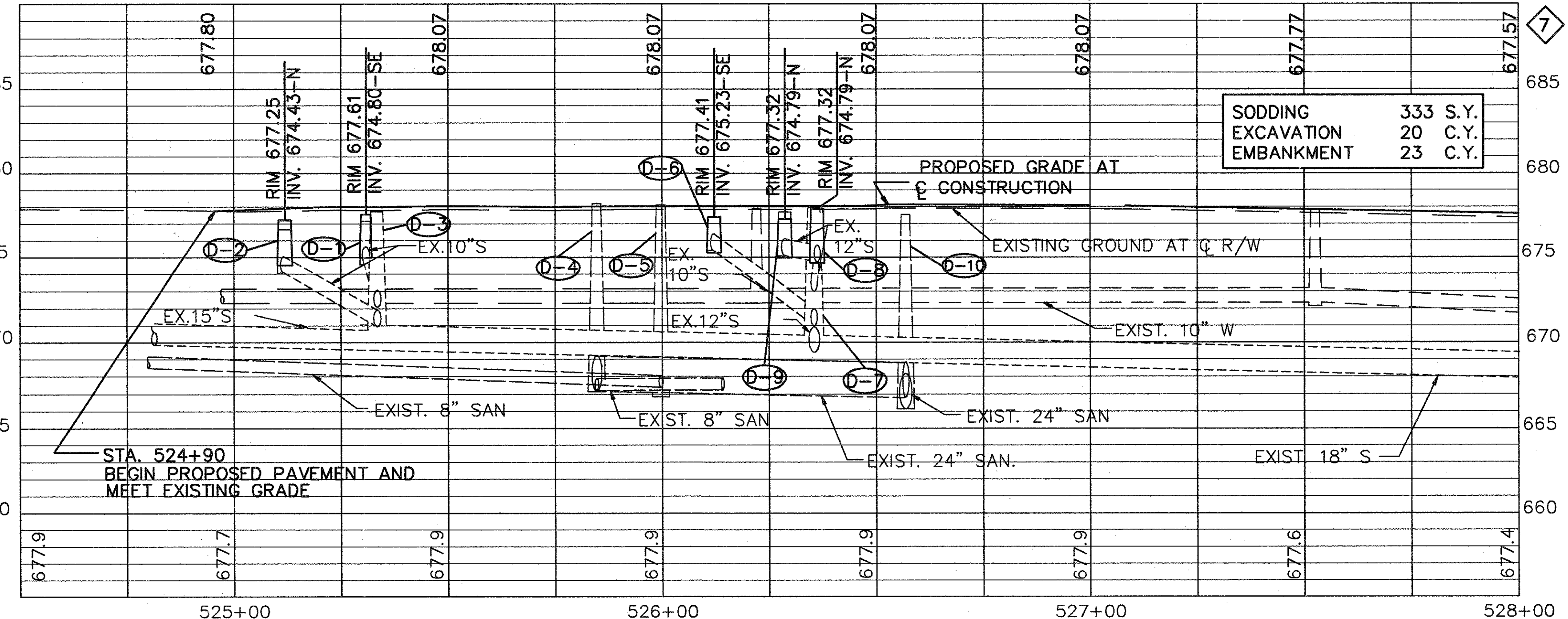

STA. 524+60 TO STA. 528+00

PR10718\SH1 2/15/93