

No.	Station	Description	Elev.
19	115+23	Spike in root 36" M. 25" R.	690.25
20	120+23	Spike in root 36" M. 25" R.	688.01
21	125+21	Spike in root 30" M. 25" R.	685.95
22	130+46	Spike in root 24" M. 25" R.	685.85
23	135+40	Spike in root 36" M. 25" R.	685.78
24	141+36	Spike in side 12" poplar 33" R.	690.00
25	144+52	X W. end gas pump found. 30" R.	687.61

MONUMENT CASTING
RESET TO GRADE
Sta. 136+71.04 on E

Item No.	From Sta.	To Sta.	R. or L.	Lin. Ft.
6-R	128+00	130+48	L	248
7-R	128+00	129+44	R	144

Item No.	Size	Type	From Sta.	To Sta.	R. or L.	Lin. Ft.
16-S	15"	V.S.P.	111+00	128+75	L	1766
17-S	12"	"	128+17	128+73	R	56
18-S	18"	"	128+75	left	L	12
19-S	12"	"	128+75	140+50	L	1168

Item No.	Station	Type	Work Required	Detail Sheet
24-C	116+00	V.S.Penc.	Build std. 12'x43' V.Penc. culvert. 1B. on R & L.	30
25-C	119+25	"	"	"
26-C	122+50	"	"	"
27-C	125+25	"	"	"
28-C	128+73	R.C.P.	Remove exist. masonry structure & build 12'x43' R.C.P. cul. 1B. on R & L. Build spillway on R. with 12" V.P. outlet for sewer & 18" V.P. thru fill on L.	"
29-C	132+17	V.S.Penc.	Build std. 12'x43' V.Penc. culvert. 1B. on R & L.	"
30-C	136+50	"	"	"
31-C	140+50	"	"	"

Sta. 128+17.02 to Sta. 132+17.11	LEFT	CENTERLINE	RIGHT		
Top Curb	E.I.L.	Station	Grade	E.I.L.	Top Curb
681.28	681.15	128+17.02	681.36	681.15	681.28
681.19	681.08	128+25	681.27	681.15	681.32
680.98	680.94	128+50	681.06	681.23	681.53
680.88	680.91	128+75	680.96	681.40	681.85
680.92	681.02	129+0	681.00	681.73	682.31
681.00	681.15	129+25	681.08	681.99	682.68
681.05	681.22	129+50	681.13	682.13	682.86
681.33	681.57	129+75	681.41	682.70	683.56
681.60	681.90	129+100	681.68	683.16	684.12
681.74	682.04	129+125	681.82	683.30	684.26
682.19	682.49	130+0	682.27	683.75	684.71
682.57	682.87	130+25	682.65	684.13	685.09
682.95	683.25	130+50	683.03	684.51	685.47
683.23	683.53	130+75	683.31	684.79	685.75
683.34	683.62	130+100	683.42	684.77	685.73
683.70	683.90	131+0	683.78	684.71	685.67
683.89	684.04	131+25	683.97	684.61	685.57
683.97	684.11	131+50	684.05	684.56	685.52
684.18	684.24	131+75	684.26	684.55	685.31
684.32	684.31	132+0	684.40	684.07	685.03
684.43	684.35	132+25	684.51	684.50	684.72
684.51	684.38	132+50	684.59	684.38	684.51

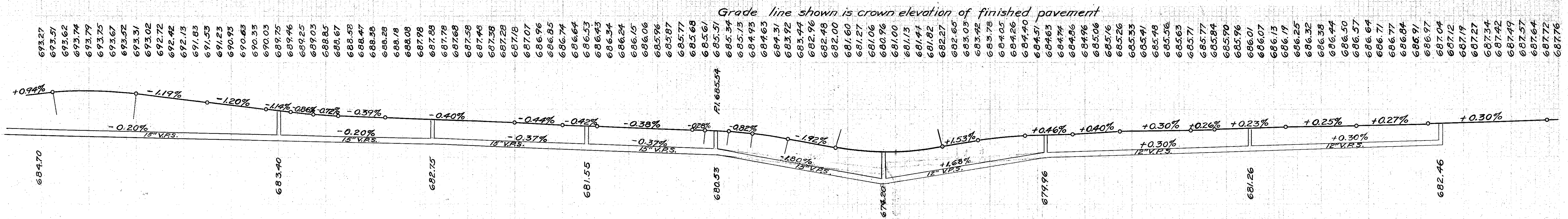

Station	Exc. Emb. Waste	cu. yds.
111		
112		
113		
114		
115		
116		
117		
118		
119		
120	Exc. Emb. Waste	1266.5
121		1054.6
122		1265.0
123		1.0
124		
125		
126		
127		
128		
129		
130		
131		
132		
133		
134		
135		
136		
137		
138	Exc. Emb. Waste	559.7
139		467.7
140		555.2
141		4.0
142		
143		