



NOT TO SCALE

CALCULATED
TKH
CHECKED
SJS

TRAFFIC SIGNAL DETAILS

LAK-20-14.34
LAK-44-5.10

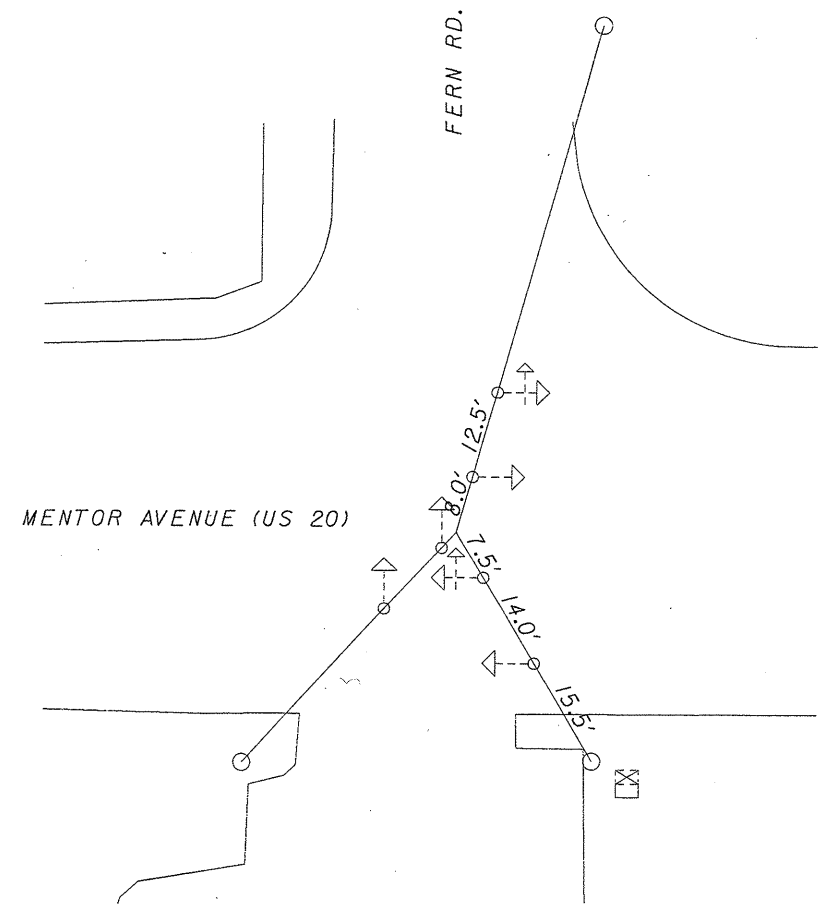

EXISTING

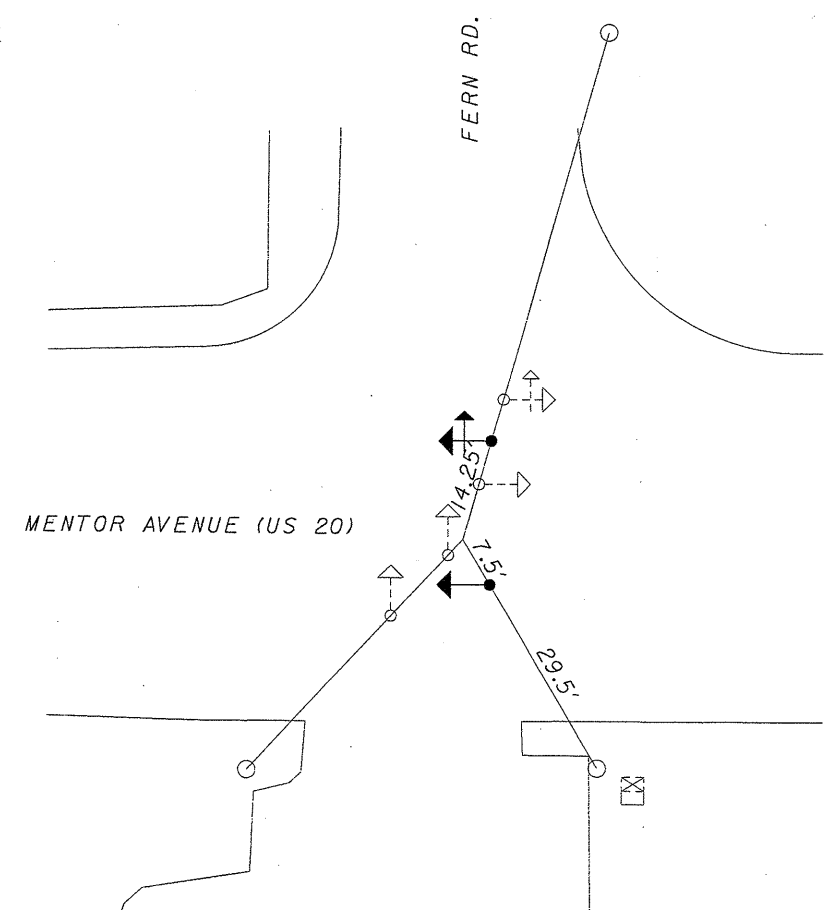

PHASE 1

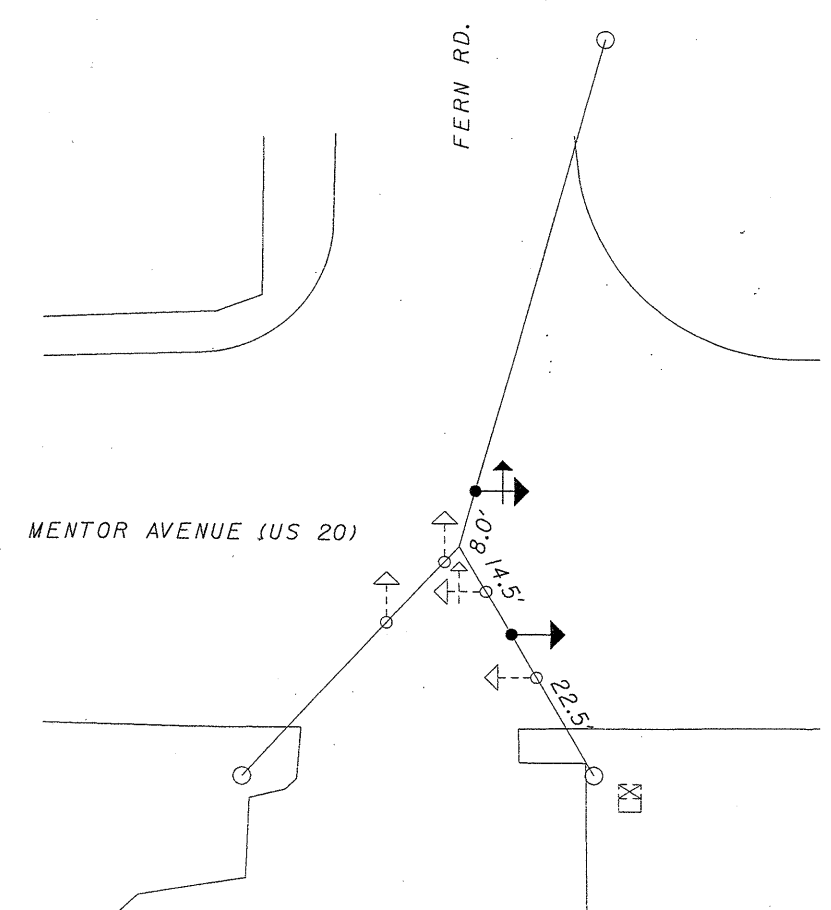

PHASE 2

- LEGEND**
- EXISTING SIGNAL HEAD
 - EXISTING SIGNAL HEAD (RELOCATED)
 - EXISTING STRAIN/POWER POLE
 - EXISTING GROUND MOUNTED CONTROLLER

- NOTES:**
1. ALL WORK ASSOCIATED WITH RELOCATION OF THE TRAFFIC SIGNAL HEADS SHALL BE PAID FOR UNDER THE LUMP SUM BID PRICE FOR ITEM 614 - MAINTAINING TRAFFIC.
 2. SEE MAINTENANCE OF TRAFFIC SIGNAL/FLASHER INSTALLATIONS NOTE ON SHEET 3.