

ITEM	DESCRIPTION	UNIT	TRAFFIC - SIGNAL QUANTITIES SUB-SUMMARY	
			QUANTITY	
816	SPAN WIRE OVERHEAD SIGN SUPPORT 40'	EA.	1	
816	CONCRETE FOR SIGN SUPPORT FND.	CY.	2.8	
816	CONCRETE FOR SIGNAL SUPPORT FND.	CY.	1	
625	TRAFFIC SIGNAL HEAD - 3 SECTION, 8" LENS 1 WAY SPAN WIRE	EA.	4	
625	INTERCONNECT CABLE 9/16" 12 AWG	LF.	115	
625	PEDEST. SIGN HEAD INCANDESCENT TYPE 12" X 12" 1 WAY VERT. POLE MOUNTED	EA.	2	
625	COVERING OF TRAFFIC SIGNAL HEADS	EA.	5	
625	SIGNAL CONTROLLER, SECONDARY, PRE-TIMED INCL. PREWIRED MTD. CAB. TYPE I	EA.	1	
625	GROUND ROD	EA.	4	
816	SIGNAL STRAIN POLE 3ga T x 4.20' x 20'	EA.	1	

625	1 1/2" WEATHERHEAD AND CONDUIT RISER	EA.	2
625	2" CONDUIT RISER W/ WEATHERHEAD	EA.	1
625	3/8", 7 STRAND, SPAN WIRE	LF.	180
625	POWER CABLE - 3C/ #8 AWG - STANDARD	LF.	30
625	SIGNAL CABLE - 5C/ #14 AWG	LF.	504
625	1/4", 3 STRAND, SPAN WIRE	LF.	91
625	2" CONDUIT 713-04	LF.	36
202	REMOVAL OF EX. SIGNAL INSTALLATION	EA.	1
621	24" WHITE STOPBAR	LF.	60
815	SIGNS, FLAT SHEET TYPE	SF.	102.25
621	8" CHANNELIZING LINE	LF.	105
621	BROAD TRANSVERSE LINES (WHITE)	LF.	70
621	8" WHITE SINGLE LANE LINE	LF.	100
625	CABLE SUPPORT ASSEMBLY	EA.	1

816	STRUCTURAL SUPPORT DRIVEN NO. 4	LF.	34
816	SPAN WIRE MOUNT SIGN ATTACHMENT	EA.	1
816	POLE MOUNTED SIGN ATTACHMENT	EA.	1
625	TRAFFIC SIGNAL HEAD, 3 SEC., 8", 2 WAY	EA.	1
816	STRUCTURAL SUPPORT NO. 6 POST DRIVEN, AS PER PLAN	LF.	32

CALC. BY E.G. DATE 11-11-74
 CKD. BY D.D. DATE 1-31-75

FED. RD. DIV.	STATE	PROJECT
5	OHIO	T-4030-(13)

16
38

LAKE COUNTY
 LAK. - 20-14.30
 LAK. - 86-0.25
 AND WASHINGTON STREET
 AND ST. CLAIR STREET

B.M.: TOP OF STEM OF HYDRANT = 681.66

MENTOR @ WASHINGTON

	60	70	15
	CYCLE CYCLE CYCLE		
ØA	67%	71%	73%
GREEN	37	47	52
YELLOW	3	3	3
RED	20	20	20

	7	7	7
	FL DW 3/4		
GREEN	17	17	17
YELLOW	3	3	3
RED	40	50	55

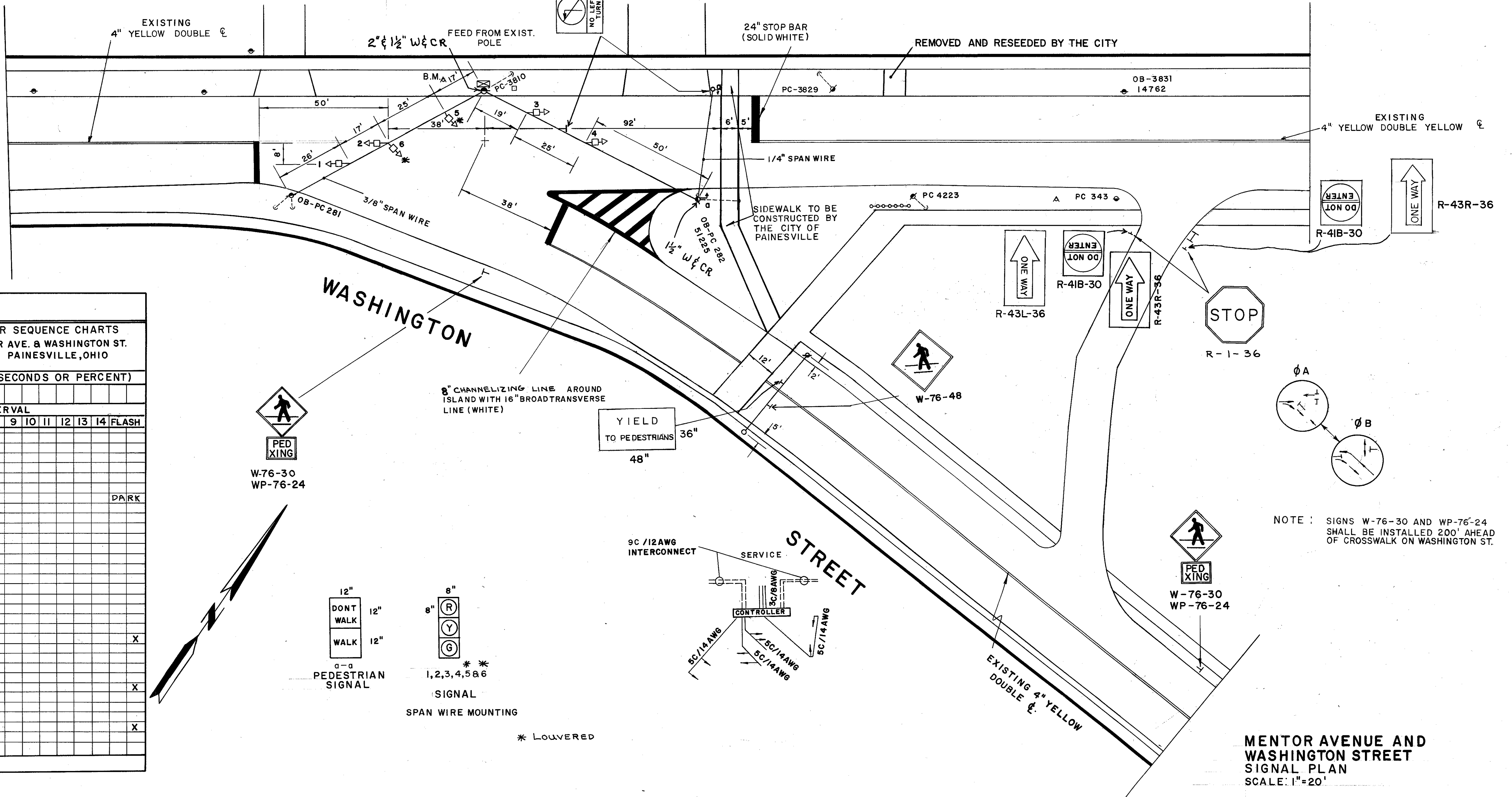

DATE	APPLIES ON CAM CHART	COLOR SEQUENCE CHARTS
DRAWN		MENTOR AVE. & WASHINGTON ST.
CHECKED		PAINESVILLE, OHIO
APPROVED		

STREETS	NUMBER OF SIGNALS	DIAL SETTINGS (SECONDS OR PERCENT)														
		Ø A		Ø B		INTERVAL										FLASH
		1	2	3	4	5	6	7	8	9	10	11	12	13	14	
MENTOR	Ø A															
MENTOR	Ø B															
MENTOR	INTERVAL															
MENTOR	FLASH															
WASHINGTON	Ø A															
WASHINGTON	Ø B															
WASHINGTON	INTERVAL															
WASHINGTON	FLASH															

NOTE: SIGNS W-76-30 AND WP-76-24 SHALL BE INSTALLED 200' AHEAD OF CROSSWALK ON WASHINGTON ST.

MENTOR AVENUE AND WASHINGTON STREET SIGNAL PLAN
 SCALE: 1"=20'