

TYPICAL SECTION BEGINNING OF PROJECT Sta. 469+15

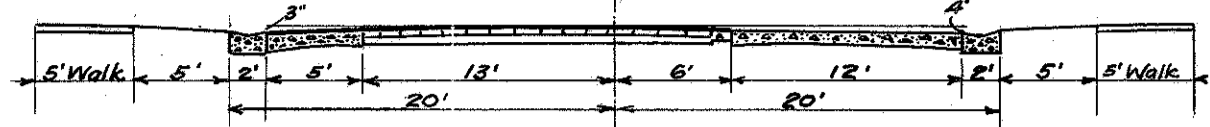

Existing pavement adjoining beginning of project consists of 12" reinforced concrete and 2 1/2" Bituminous Surface (T-30), laid on 18" brick pavement, 6" concrete base, with a 2" concrete gutter curb on each side, making a total width of roadway of 40'.

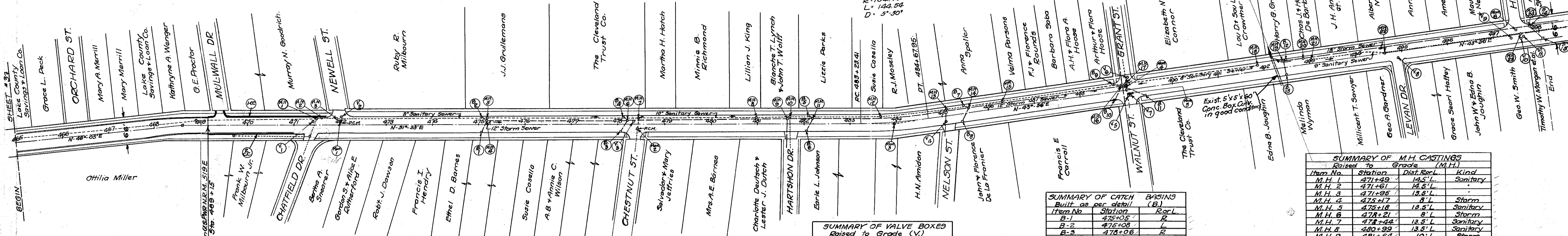

**SUMMARY OF CONCRETE CURB (C.C.)**

Item No.	From	To	Lin. Ft.	Lor. R.	Remarks
1-C.C.	469+82	471+70	188	L	Type 1-B Const. Dr. I-R.C.C.
2-C.C.	469+15	471+00	185	R	
Total			373		

For Curved Conc. Curb See Sht. No. 8

**SUMMARY OF MONUMENT CASTINGS Raised to Grade (Mon.)**

Item No.	Station	Location
Mon. 1	472+01.24	9' L of C
Mon. 2	478+41.69	9' R of C
Mon. 3	483+95.79	C
Mon. 4	489+02.71	9' L of C
Mon. 5	489+04.13	9' R of C
Mon. 6	497+32.83	9' L of C
Total		6 Mon. Cast. Raised.

**SUMMARY OF VALVE BOXES Raised to Grade (V)**

Item No.	Station	R or L
V-1	471+72	8' L
V-2	472+07	16.5' L
V-3	478+34	6.5' L
V-4	485+07	12.5' R
V-5	489+04	12' R
V-6	489+08	26' L
V-7	489+09	12' R
V-8	494+92	13.5' R
V-9	497+37	5.5' R
V-10	497+60	11' R
V-11	497+65	7' R
Total		11 Valve Boxes Raised

**SUMMARY OF CATCH BASINS Built as per detail (B)**

Item No.	Station	R or L
B-1	475+05	R
B-2	475+08	L
B-3	478+06	R
B-4	478+11	L
B-5	482+10	L
B-6	482+04	R
B-7	485+50	L
B-8	485+44	R
B-9	485+74	L
B-10	488+74	R
B-11	483+30	R
B-12	482+49	L
B-13	492+47	R
B-14	497+86	L
B-15	490+07	R
Total		15 Inlet Basins

**SUMMARY OF M.H. CASTINGS Raised to Grade (M.H.)**

Item No.	Station	Dist. R or L	Kind
M.H. 1	471+49	14.5' L	Sanitary
M.H. 2	471+61	14.5' L	Sanitary
M.H. 3	471+95	13.5' L	Storm
M.H. 4	475+17	8' L	Sanitary
M.H. 5	478+18	13.5' L	Storm
M.H. 6	478+21	8' L	Storm
M.H. 7	478+44	13.5' L	Sanitary
M.H. 8	480+39	13.5' L	Sanitary
M.H. 9	481+64	10' L	Storm
M.H. 10	481+72	15' L	Sanitary
M.H. 11	482+19	10' L	Storm
M.H. 12	483+57	15' L	Sanitary
M.H. 13	485+13	14' L	
M.H. 14	485+39	10' L	Storm
M.H. 15	486+33	14' L	Sanitary
M.H. 16	488+33	9' L	Storm
M.H. 17	488+01	14' L	Sanitary
M.H. 18	491+88	14' L	
M.H. 19	492+45	13.5' L	Storm
M.H. 20	492+88	13.5' L	
M.H. 21	493+05	7' L	Sanitary
M.H. 22	494+63	C	
M.H. 23	497+80	C	
M.H. 24	497+82	18' L	Storm
Total			24 M.H. Castings raised to grade.

Station	Surface Elevation
465	680.85
466	681.13
467	681.41
468	681.69
469	681.83
470	681.76
471	681.58
472	681.40
473	681.22
474	680.92
475	680.62
476	680.32
477	680.02
478	679.72
479	679.42
480	679.12
481	678.82
482	678.52
483	678.22
484	677.92
485	677.62
486	677.32
487	677.02
488	676.72
489	676.42
490	676.12
491	675.82
492	675.52
493	675.22
494	675.00
495	674.74
496	674.42
497	674.16
498	673.82
499	673.52
500	673.22
501	672.92
502	672.62
503	672.32
504	672.02
505	671.72
506	671.42
507	671.12
508	670.82
509	670.52
510	670.22
511	670.00

Begin U.S. R.W. N.R.M. SIDE Sta. 469+15

End Sheet #31