

I.C.H. No 2 SEC. 1 & B.  
LAKE COUNTY

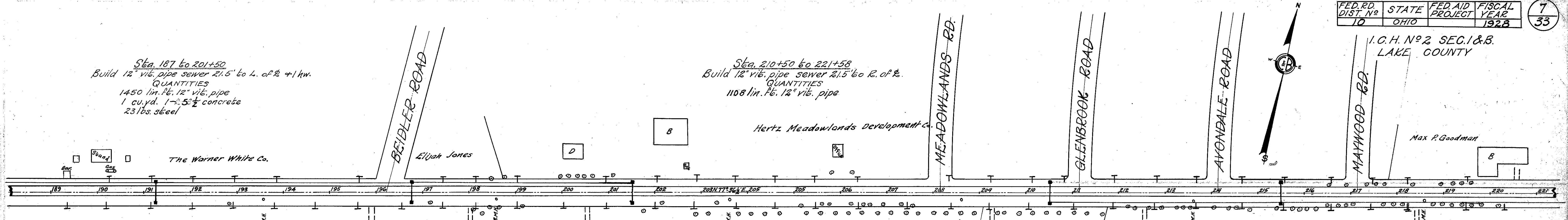

Sta. 187 to 201+50  
Build 12" vit. pipe sewer 21.5' to L. of R. +1 kw.  
QUANTITIES  
1450 lin. ft. 12" vit. pipe  
1 cu. yd. 1-5/8" concrete  
23 lbs. steel

Sta. 210+50 to 221+58  
Build 12" vit. pipe sewer 21.5' to R. of R.  
QUANTITIES  
1108 lin. ft. 12" vit. pipe

Sta. 191+25  
Build 2 steel inlet basins  
1 21.5' to R. + 1 21.5' to L. of R.  
and connect with 12" vit. pipe  
QUANTITIES  
15.5 cu. yds. excavation  
432.4 cu. yds. 1-8" concrete  
42 lin. ft. 12" vit. pipe  
2 52 yds. 4" brick pav. re-  
moved & rebuilt  
5.4 sq. yds. 6" conc. base to be  
removed & rebuilt

Sta. 196+75  
Build 2 steel inlet basins  
1 21.5' to R. + 1 21.5' to L. of R.  
and connect with 12" vit. pipe  
QUANTITIES  
15.5 cu. yds. excavation  
432.4 cu. yds. 1-8" concrete  
42 lin. ft. 12" vit. pipe  
2 52 yds. 4" brick pav. re-  
moved & rebuilt  
5.4 sq. yds. 6" conc. base re-  
moved & rebuilt

Sta. 201+50  
Build 2 steel inlet basins  
1 21.5' to R. + 1 21.5' to L. of R.  
and connect with 12" vit. pipe  
QUANTITIES  
15.2 cu. yds. excavation  
432.4 cu. yds. 1-8" concrete  
42 lin. ft. 12" vit. pipe  
2 52 yds. 4" brick pav. re-  
moved & rebuilt  
5.4 sq. yds. 6" conc. base re-  
moved & rebuilt

Sta. 210+50  
Build 2 steel inlet basins  
1 21.5' to R. + 1 21.5' to L. of R.  
and connect with 12" vit. pipe  
QUANTITIES  
16.1 cu. yds. excavation  
432.4 cu. yds. 1-8" concrete  
42 lin. ft. 12" vit. pipe  
2 52 yds. 4" brick pav. re-  
moved & rebuilt  
5.4 sq. yds. 6" conc. base re-  
moved & rebuilt

Sta. 215+50  
Build 2 steel inlet basins  
1 21.5' to R. + 1 21.5' to L. of R.  
and connect with 12" vit. pipe  
QUANTITIES  
15.2 cu. yds. excavation  
432.4 cu. yds. 1-8" concrete  
42 lin. ft. 12" vit. pipe  
2 52 yds. 4" brick pav. re-  
moved & rebuilt  
5.4 sq. yds. 6" conc. base re-  
moved & rebuilt

Sta. 210+50  
Build 2 steel inlet basins  
1 21.5' to R. + 1 21.5' to L. of R.  
and connect with 12" vit. pipe  
QUANTITIES  
15.2 cu. yds. excavation  
432.4 cu. yds. 1-8" concrete  
42 lin. ft. 12" vit. pipe  
2 52 yds. 4" brick pav. re-  
moved & rebuilt  
5.4 sq. yds. 6" conc. base re-  
moved & rebuilt

Sta. 215+50  
Build 2 steel inlet basins  
1 21.5' to R. + 1 21.5' to L. of R.  
and connect with 12" vit. pipe  
QUANTITIES  
16.1 cu. yds. excavation  
432.4 cu. yds. 1-8" concrete  
42 lin. ft. 12" vit. pipe  
2 52 yds. 4" brick pav. re-  
moved & rebuilt  
5.4 sq. yds. 6" conc. base re-  
moved & rebuilt

Sta. 215+50  
Build 2 steel inlet basins  
1 21.5' to R. + 1 21.5' to L. of R.  
and connect with 12" vit. pipe  
QUANTITIES  
16.1 cu. yds. excavation  
432.4 cu. yds. 1-8" concrete  
42 lin. ft. 12" vit. pipe  
2 52 yds. 4" brick pav. re-  
moved & rebuilt  
5.4 sq. yds. 6" conc. base re-  
moved & rebuilt

Sta. 215+50  
Build 2 steel inlet basins  
1 21.5' to R. + 1 21.5' to L. of R.  
and connect with 12" vit. pipe  
QUANTITIES  
16.1 cu. yds. excavation  
432.4 cu. yds. 1-8" concrete  
42 lin. ft. 12" vit. pipe  
2 52 yds. 4" brick pav. re-  
moved & rebuilt  
5.4 sq. yds. 6" conc. base re-  
moved & rebuilt

Sta. 215+50  
Build 2 steel inlet basins  
1 21.5' to R. + 1 21.5' to L. of R.  
and connect with 12" vit. pipe  
QUANTITIES  
16.1 cu. yds. excavation  
432.4 cu. yds. 1-8" concrete  
42 lin. ft. 12" vit. pipe  
2 52 yds. 4" brick pav. re-  
moved & rebuilt  
5.4 sq. yds. 6" conc. base re-  
moved & rebuilt

Sta. 215+50  
Build 2 steel inlet basins  
1 21.5' to R. + 1 21.5' to L. of R.  
and connect with 12" vit. pipe  
QUANTITIES  
16.1 cu. yds. excavation  
432.4 cu. yds. 1-8" concrete  
42 lin. ft. 12" vit. pipe  
2 52 yds. 4" brick pav. re-  
moved & rebuilt  
5.4 sq. yds. 6" conc. base re-  
moved & rebuilt

B.M. #25 Sta. 190+30  
x on E. end foundation to gas pump  
44' to L. of R.  
Elev. = 673.31

B.M. #26 Sta. 198+16  
Spike in root 36" willow  
38' to R. of R.  
Elev. = 684.73

B.M. #27 Sta. 203+17  
Spike in root 15" M.  
47' to R. of R.  
Elev. = 686.03

B.M. #28 Sta. 208+29  
Spike in root 24" poplar  
44' to R. of R.  
Elev. = 685.17

B.M. #29 Sta. 213+25  
Spike in root 18" M.  
31' to R. of R.  
Elev. = 687.55

B.M. #30 Sta. 218+36  
Spike in root 20" M.  
20' to L. of R.  
Elev. = 682.43

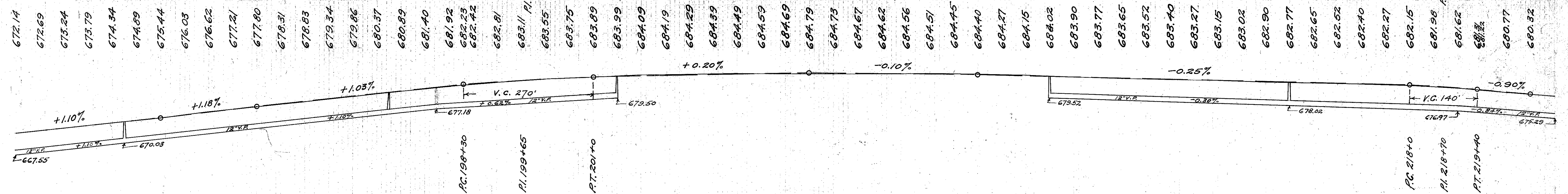

Note: - Grade line shown is 1' below crown of old pavt.

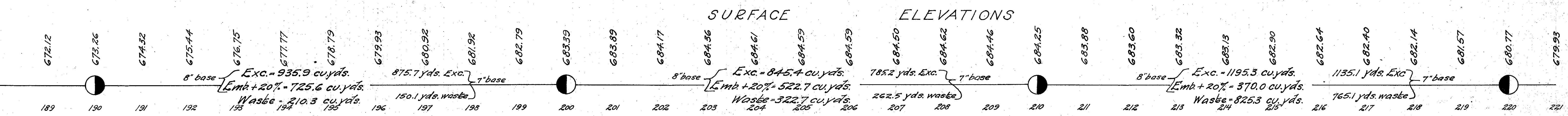

Remove 9 trees Lt.