

I.C.H. No 2 SEC. I & B. LAKE COUNTY

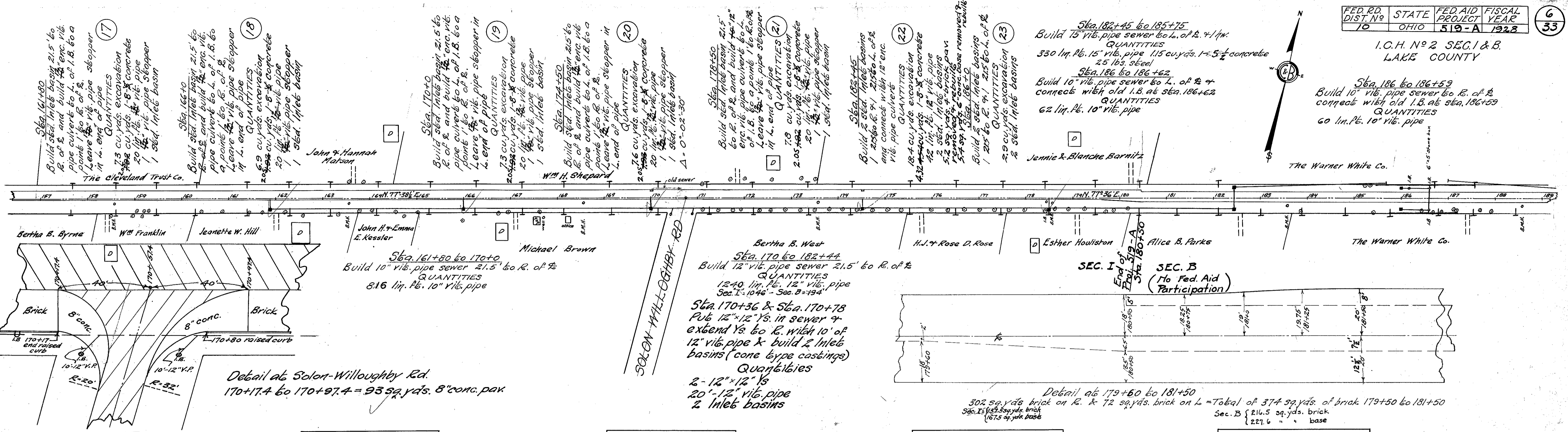

B.M. #20 Sta. 160+87  
Spike in root 8" oak  
25' to R of R  
Elev. = 680.03

B.M. #21 Sta. 166+73  
Spike in root 24" M.  
31' to R of R  
Elev. = 676.08

B.M. #22 Sta. 172+31  
Spike in root 40" M.  
26.5' to R. of R.  
Elev. = 673.50

B.M. #23 Sta. 177+65  
Spike in root 30" M. (back)  
24' to R of R  
Elev. = 675.07

B.M. #24 Sta. 185+47  
x on S.W. cor. stone wall  
29' to L of R  
Elev. = 669.71

Note: - Grade line shown is crown of old pav't.

Note: - Grade line shown is 1" below crown of old pav't.

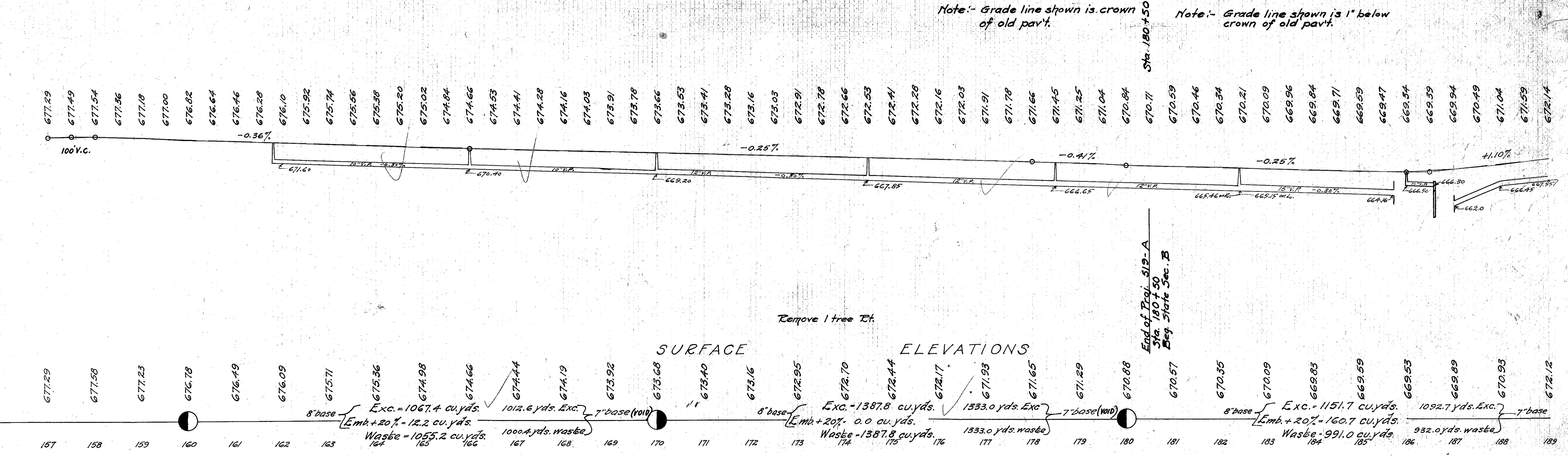

SURFACE ELEVATIONS

Exc. = 1387.8 cu. yds.  
Emb. + 20% = 0.0 cu. yds.  
Waste = 1387.8 cu. yds.

End of Proj. 519-A  
Sta. 180+50  
Beg. State Sec. B