

I.C.H. No 2 SEC. 1 & B  
LAKE COUNTY

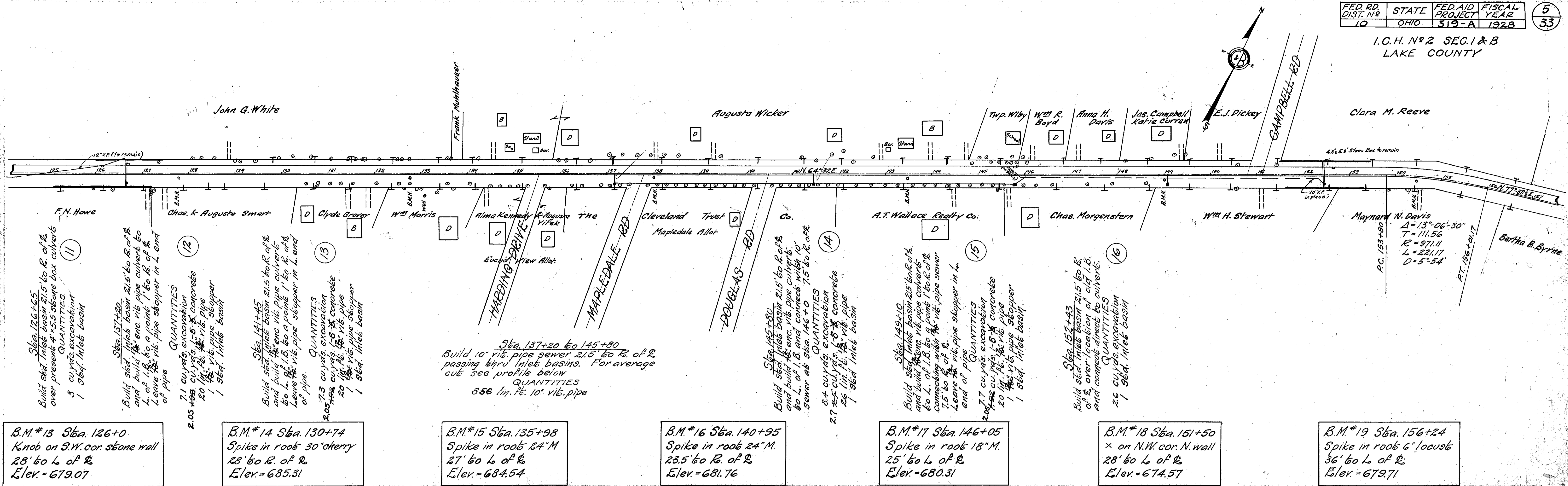

B.M.#13 Sta. 126+0  
Knob on S.W. cor. stone wall  
28' to L of R  
Elev. = 679.07

B.M.#14 Sta. 130+74  
Spike in roof 30' cherry  
28' to R. of R  
Elev. = 685.31

B.M.#15 Sta. 135+98  
Spike in roof 24' M  
27' to L of R  
Elev. = 684.54

B.M.#16 Sta. 140+95  
Spike in roof 24' M  
23.5' to R. of R  
Elev. = 681.76

B.M.#17 Sta. 146+05  
Spike in roof 18' M  
25' to L of R  
Elev. = 680.31

B.M.#18 Sta. 151+50  
x on N.W. cor. N. wall  
28' to L of R  
Elev. = 674.57

B.M.#19 Sta. 156+24  
Spike in roof 6' locust  
36' to L of R  
Elev. = 679.71

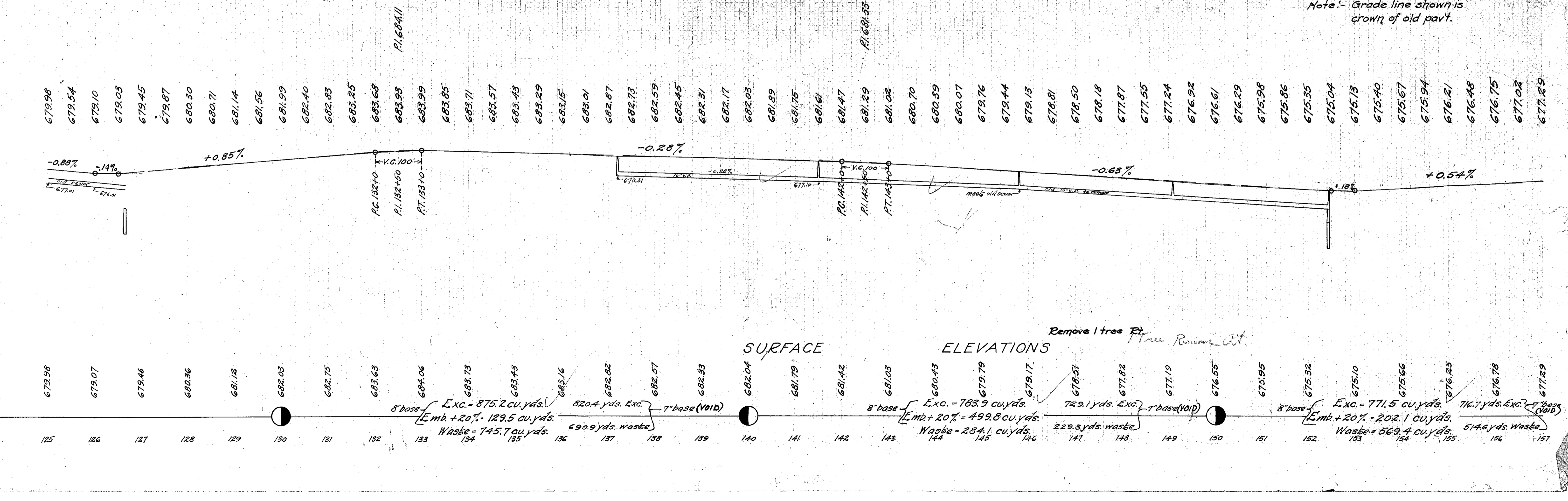

Note: - Grade line shown is crown of old pav't.