

STATE OF OHIO
DEPARTMENT OF TRANSPORTATION
LAK/ATB-20-24.89/0.00
NORTH PERRY VILLAGE AND
PERRY/MADISON/GENEVA TOWNSHIPS
LAKE/ASHTABULA COUNTIES
RIGHT OF WAY

CALC. BY: DATE:	LAK/ATB	OHIO
CHK. BY: DATE:	LAK/ATB-20-24.89/0.00	F.H.W.A. REGION 5
FEDERAL PROJECT	STATE PROJECT	

CONVENTIONAL SIGNS

CONSTRUCTION LIMIT -----	UTILITY LINES:
COUNTY LINE -----	EXIST. WATER -----W-----W-----
TOWNSHIP LINE -----	EXIST. GAS -----G-----G-----
SECTION LINE -----	EXIST. COMMUNICATIONS -----T-----T-----
CORPORATION LINE -----	EXIST. ELECTRIC -----E-----
PROPERTY LINE -----P-----	EXIST. SANITARY SEWER -----SAN-----
RIGHT OF WAY LINE:	EXIST. STORM SEWER -----S-----
EXISTING -----	PROP. STORM SEWER -----
PROPOSED -----R/W-----	
FENCE LINE:	VALVES:
EXISTING -----x-----x-----x-----	EXISTING -----o-----
PROPOSED -----x-----x-----x-----	PROPOSED -----o-----
POLES:	FIRE HYDRANTS:
GENERAL -----o----- LIGHT -----o----- POWER -----o-----	EXIST. -----o-----
TELEPHONE OR COMBINATION -----o-----	TO BE RESET -----o-----
TELEGRAPH -----o-----	PROP. -----o-----
TRAFFIC SIGNALS:	MANHOLES:
EXISTING -----o-----	EXISTING -----o-----
PROPOSED -----o-----	TO BE RESET -----o-----
SIGNS: -----	PROP. -----o-----
MAIL BOX: [MB]	INLETS OR CATCH BASINS:
GUARD RAIL:	EXISTING -----o-----
EXISTING -----	TO BE RESET -----o-----
PROPOSED -----	PROP. -----o-----
	TREES: TREE -----o----- STUMP -----o-----
	(TO BE REMOVED) -----o-----
	STREAMS:
	-INTERMITTENT -----
	-CREEK -----
	FLOW ARROW:
	EXISTING -----
	PROPOSED -----

RW ONLY | LAK/ATB-20-24.89/0.00
P.I.D. 5135 | SJN:

ACQUIRING AGENCY: STATE OF OHIO

1993 SPECIFICATIONS

THE STANDARD SPECIFICATIONS OF THE STATE OF OHIO, DEPARTMENT OF TRANSPORTATION, INCLUDING CHANGES AND SUPPLEMENTAL SPECIFICATIONS LISTED IN THE PROPOSAL SHALL GOVERN THIS IMPROVEMENT.

APPROVED _____
DATE _____ ASSISTANT DEPUTY DIRECTOR,
OFFICE OF REAL ESTATE ADMINISTRATION

APPROVED _____
DATE _____ DIRECTOR, DEPARTMENT OF
TRANSPORTATION

PROJECT DESCRIPTION

IMPROVEMENT OF 5.67 MILES OF U.S. ROUTE 20 BY WIDENING AND IMPROVING HORIZONTAL AND VERTICAL ALIGNMENTS; INCLUDING REPLACEMENT OF STRUCTURE OVER ARCOLA CREEK.

INDEX OF SHEETS

TITLE SHEET	1-4
CENTERLINE SURVEY PLATS	5-10
PROPERTY MAPS	11-26
SUMMARY OF ADDITIONAL RIGHT OF WAY REQUIRED	27-100
DETAIL PLAN SHEETS	

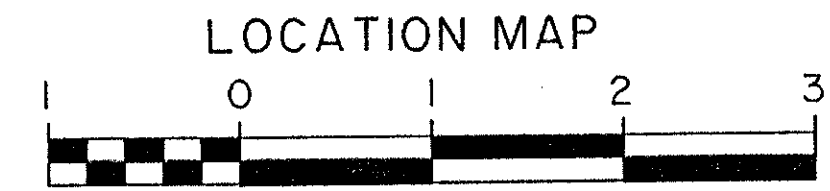
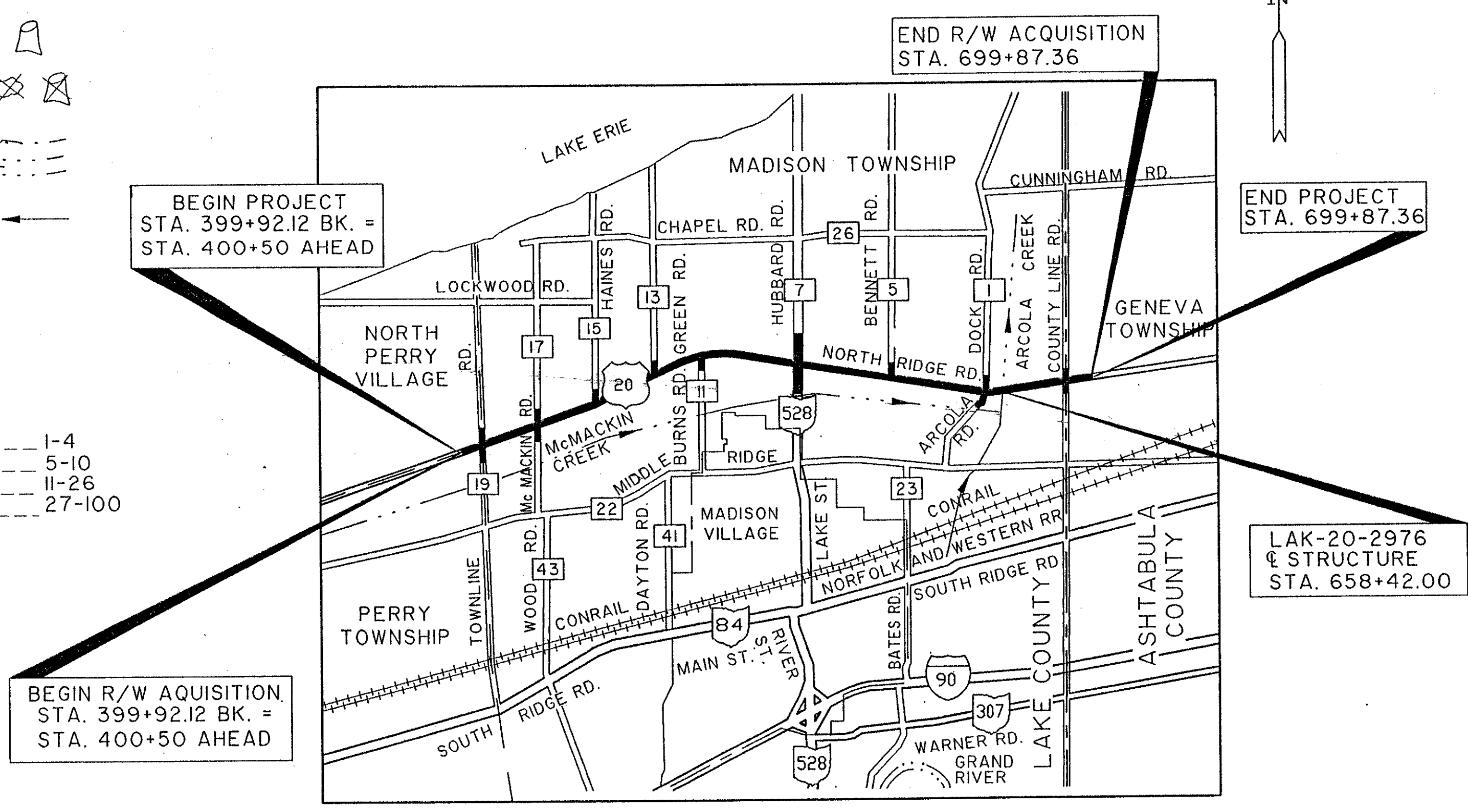

PORTION TO BE IMPROVED -----
STATE AND FEDERAL ROUTES -----
OTHER ROADS -----

SCALES

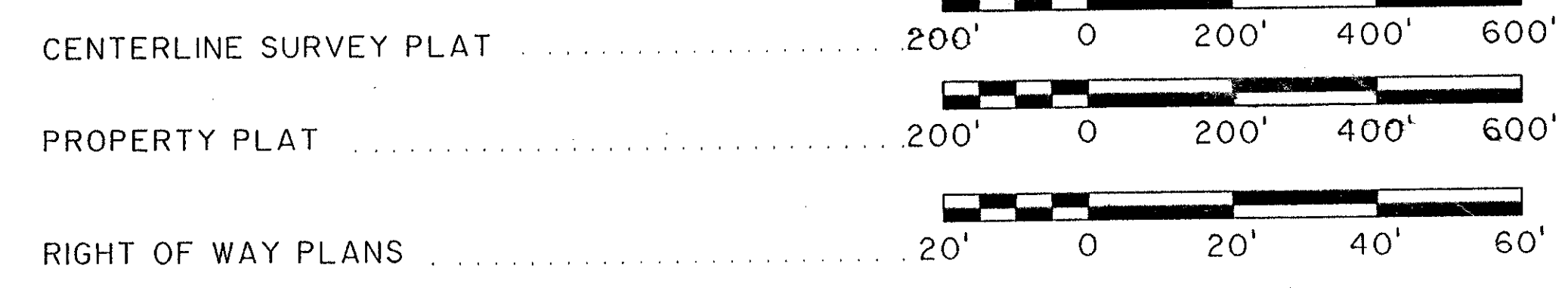

PLANS PREPARED BY:
THE OSBORN ENGINEERING COMPANY
668 EUCLID AVE. SUITE 500
CLEVELAND, OHIO 44114
216-861-2020

AND

WESTERN RESERVE ENGINEERING & SURVEYING COMPANY
5533 CANAL ROAD
CLEVELAND, OHIO 44125
216-524-0008

UNDERGROUND UTILITIES
2 WORKING DAYS
BEFORE YOU DIG
CALL 800-362-2764 (TOLL FREE)
OHIO UTILITIES
PROTECTION SERVICE
NON-MEMBER
MUST BE CALLED DIRECTLY

LAKE/ASHTABULA COUNTY LAK/ATB-20-24.89/0.00	
FILE NO.	DATE OF LETTING _____ 19____ CONTRACT NO. _____

PRELIMINARY
RIGHT OF WAY
SUBMITTAL

MARCH 1994

DEPARTMENT OF TRANSPORTATION
FEDERAL HIGHWAY ADMINISTRATION

APPROVED _____
DIVISION ADMINISTRATOR _____ DATE _____

1/2" = 1' (1/4" = 1/2')
 1/4" = 1' (1/8" = 1/2')
 1/8" = 1' (1/16" = 1/2')
 1/16" = 1' (1/32" = 1/2')
 1/32" = 1' (1/64" = 1/2')
 1/64" = 1' (1/128" = 1/2')
 1/128" = 1' (1/256" = 1/2')
 1/256" = 1' (1/512" = 1/2')
 1/512" = 1' (1/1024" = 1/2')
 1/1024" = 1' (1/2048" = 1/2')
 1/2048" = 1' (1/4096" = 1/2')
 1/4096" = 1' (1/8192" = 1/2')
 1/8192" = 1' (1/16384" = 1/2')
 1/16384" = 1' (1/32768" = 1/2')
 1/32768" = 1' (1/65536" = 1/2')
 1/65536" = 1' (1/131072" = 1/2')
 1/131072" = 1' (1/262144" = 1/2')
 1/262144" = 1' (1/524288" = 1/2')
 1/524288" = 1' (1/1048576" = 1/2')
 1/1048576" = 1' (1/2097152" = 1/2')
 1/2097152" = 1' (1/4194304" = 1/2')
 1/4194304" = 1' (1/8388608" = 1/2')
 1/8388608" = 1' (1/16777216" = 1/2')
 1/16777216" = 1' (1/33554432" = 1/2')
 1/33554432" = 1' (1/67108864" = 1/2')
 1/67108864" = 1' (1/134217728" = 1/2')
 1/134217728" = 1' (1/268435456" = 1/2')
 1/268435456" = 1' (1/536870912" = 1/2')
 1/536870912" = 1' (1/1073741824" = 1/2')
 1/1073741824" = 1' (1/2147483648" = 1/2')
 1/2147483648" = 1' (1/4294967296" = 1/2')
 1/4294967296" = 1' (1/8589934592" = 1/2')
 1/8589934592" = 1' (1/17179869184" = 1/2')
 1/17179869184" = 1' (1/34359738368" = 1/2')
 1/34359738368" = 1' (1/68719476736" = 1/2')
 1/68719476736" = 1' (1/137438953472" = 1/2')
 1/137438953472" = 1' (1/274877906944" = 1/2')
 1/274877906944" = 1' (1/549755813888" = 1/2')
 1/549755813888" = 1' (1/1099511627776" = 1/2')
 1/1099511627776" = 1' (1/2199023255552" = 1/2')
 1/2199023255552" = 1' (1/4398046511104" = 1/2')
 1/4398046511104" = 1' (1/8796093022208" = 1/2')
 1/8796093022208" = 1' (1/17592186044416" = 1/2')
 1/17592186044416" = 1' (1/35184372088832" = 1/2')
 1/35184372088832" = 1' (1/70368744177664" = 1/2')
 1/70368744177664" = 1' (1/140737488355328" = 1/2')
 1/140737488355328" = 1' (1/281474976710656" = 1/2')
 1/281474976710656" = 1' (1/562949953421312" = 1/2')
 1/562949953421312" = 1' (1/1125899906842624" = 1/2')
 1/1125899906842624" = 1' (1/2251799813685248" = 1/2')
 1/2251799813685248" = 1' (1/4503599627370496" = 1/2')
 1/4503599627370496" = 1' (1/9007199254740992" = 1/2')
 1/9007199254740992" = 1' (1/18014398509481984" = 1/2')
 1/18014398509481984" = 1' (1/36028797018963968" = 1/2')
 1/36028797018963968" = 1' (1/72057594037927936" = 1/2')
 1/72057594037927936" = 1' (1/144115188075855872" = 1/2')
 1/144115188075855872" = 1' (1/288230376151711744" = 1/2')
 1/288230376151711744" = 1' (1/576460752303423488" = 1/2')
 1/576460752303423488" = 1' (1/1152921504606846976" = 1/2')
 1/1152921504606846976" = 1' (1/2305843009213693952" = 1/2')
 1/2305843009213693952" = 1' (1/4611686018427387904" = 1/2')
 1/4611686018427387904" = 1' (1/9223372036854775808" = 1/2')
 1/9223372036854775808" = 1' (1/18446744073709551616" = 1/2')
 1/18446744073709551616" = 1' (1/36893488147419103232" = 1/2')
 1/36893488147419103232" = 1' (1/73786976294838206464" = 1/2')
 1/73786976294838206464" = 1' (1/147573952589676412928" = 1/2')
 1/147573952589676412928" = 1' (1/295147905179352825856" = 1/2')
 1/295147905179352825856" = 1' (1/590295810358705651712" = 1/2')
 1/590295810358705651712" = 1' (1/1180591620717411303424" = 1/2')
 1/1180591620717411303424" = 1' (1/2361183241434822606848" = 1/2')
 1/2361183241434822606848" = 1' (1/4722366482869645213696" = 1/2')
 1/4722366482869645213696" = 1' (1/9444732965739290427392" = 1/2')
 1/9444732965739290427392" = 1' (1/18889465931478580854784" = 1/2')
 1/18889465931478580854784" = 1' (1/37778931862957161709568" = 1/2')
 1/37778931862957161709568" = 1' (1/75557863725914323419136" = 1/2')
 1/75557863725914323419136" = 1' (1/151115727451828646838272" = 1/2')
 1/151115727451828646838272" = 1' (1/302231454903657293676544" = 1/2')
 1/302231454903657293676544" = 1' (1/604462909807314587353088" = 1/2')
 1/604462909807314587353088" = 1' (1/1208925819614629174706176" = 1/2')
 1/1208925819614629174706176" = 1' (1/2417851639229258349412352" = 1/2')
 1/2417851639229258349412352" = 1' (1/4835703278458516698824704" = 1/2')
 1/4835703278458516698824704" = 1' (1/9671406556917033397649408" = 1/2')
 1/9671406556917033397649408" = 1' (1/19342813113834066795298816" = 1/2')
 1/19342813113834066795298816" = 1' (1/38685626227668133590597632" = 1/2')
 1/38685626227668133590597632" = 1' (1/77371252455336267181195264" = 1/2')
 1/77371252455336267181195264" = 1' (1/154742504910672534362390528" = 1/2')
 1/154742504910672534362390528" = 1' (1/309485009821345068724781056" = 1/2')
 1/309485009821345068724781056" = 1' (1/618970019642690137449562112" = 1/2')
 1/618970019642690137449562112" = 1' (1/1237940039285380274899124224" = 1/2')
 1/1237940039285380274899124224" = 1' (1/2475880078570760549798248448" = 1/2')
 1/2475880078570760549798248448" = 1' (1/4951760157141521099596496896" = 1/2')
 1/4951760157141521099596496896" = 1' (1/9903520314283042199192993792" = 1/2')
 1/9903520314283042199192993792" = 1' (1/19807040628566084398385987584" = 1/2')
 1/19807040628566084398385987584" = 1' (1/39614081257132168796771975168" = 1/2')
 1/39614081257132168796771975168" = 1' (1/79228162514264337593543950336" = 1/2')
 1/79228162514264337593543950336" = 1' (1/158456325028528675187087900672" = 1/2')
 1/158456325028528675187087900672" = 1' (1/316912650057057350374175801344" = 1/2')
 1/316912650057057350374175801344" = 1' (1/633825300114114700748351602688" = 1/2')
 1/633825300114114700748351602688" = 1' (1/1267650600228229401496703205376" = 1/2')
 1/1267650600228229401496703205376" = 1' (1/2535301200456458802993406410752" = 1/2')
 1/2535301200456458802993406410752" = 1' (1/5070602400912917605986812821504" = 1/2')
 1/5070602400912917605986812821504" = 1' (1/10141204801825835211973625643008" = 1/2')
 1/10141204801825835211973625643008" = 1' (1/20282409603651670423947251286016" = 1/2')
 1/20282409603651670423947251286016" = 1' (1/40564819207303340847894502572032" = 1/2')
 1/40564819207303340847894502572032" = 1' (1/81129638414606681695789005144064" = 1/2')
 1/81129638414606681695789005144064" = 1' (1/162259276829213363391578010288128" = 1/2')
 1/162259276829213363391578010288128" = 1' (1/324518553658426726783156020576256" = 1/2')
 1/324518553658426726783156020576256" = 1' (1/649037107316853453566312041152512" = 1/2')
 1/649037107316853453566312041152512" = 1' (1/1298074214633706907132624082305024" = 1/2')
 1/1298074214633706907132624082305024" = 1' (1/2596148429267413814265248164610048" = 1/2')
 1/2596148429267413814265248164610048" = 1' (1/5192296858534827628530496329220096" = 1/2')
 1/5192296858534827628530496329220096" = 1' (1/10384593717069655257060992658440192" = 1/2')
 1/10384593717069655257060992658440192" = 1' (1/20769187434139310514121985316880384" = 1/2')
 1/20769187434139310514121985316880384" = 1' (1/41538374868278621028243970633760768" = 1/2')
 1/41538374868278621028243970633760768" = 1' (1/83076749736557242056487941267521536" = 1/2')
 1/83076749736557242056487941267521536" = 1' (1/166153499473114484112975882535043072" = 1/2')
 1/166153499473114484112975882535043072" = 1' (1/332306998946228968225951765070086144" = 1/2')
 1/332306998946228968225951765070086144" = 1' (1/664613997892457936451903530140172288" = 1/2')
 1/664613997892457936451903530140172288" = 1' (1/1329227995784915872903807060280344576" = 1/2')
 1/1329227995784915872903807060280344576" = 1' (1/2658455991569831745807614120560689152" = 1/2')
 1/2658455991569831745807614120560689152" = 1' (1/5316911983139663491615228241121378304" = 1/2')
 1/5316911983139663491615228241121378304" = 1' (1/10633823966279326983230456482242756608" = 1/2')
 1/10633823966279326983230456482242756608" = 1' (1/21267647932558653966460912964485513216" = 1/2')
 1/21267647932558653966460912964485513216" = 1' (1/42535295865117307932921825928971026432" = 1/2')
 1/42535295865117307932921825928971026432" = 1' (1/85070591730234615865843651857942052864" = 1/2')
 1/85070591730234615865843651857942052864" = 1' (1/170141183460469231731687303715884105728" = 1/2')
 1/170141183460469231731687303715884105728" = 1' (1/340282366920938463463374607431768211456" = 1/2')
 1/340282366920938463463374607431768211456" = 1' (1/680564733841876926926749214863536422912" = 1/2')
 1/680564733841876926926749214863536422912" = 1' (1/1361129467683753853853498429727072845824" = 1/2')
 1/1361129467683753853853498429727072845824" = 1' (1/2722258935367507707706996859454145691648" = 1/2')
 1/2722258935367507707706996859454145691648" = 1' (1/5444517870735015415413993718908291383296" = 1/2')
 1/5444517870735015415413993718908291383296" = 1' (1/10889035741470030830827987437816582766592" = 1/2')
 1/10889035741470030830827987437816582766592" = 1' (1/21778071482940061661655974875633165533184" = 1/2')
 1/21778071482940061661655974875633165533184" = 1' (1/43556142965880123323311949751266331066368" = 1/2')
 1/43556142965880123323311949751266331066368" = 1' (1/87112285931760246646623899502532662132736" = 1/2')
 1/87112285931760246646623899502532662132736" = 1' (1/174224571863520493293247799005065242664672" = 1/2')
 1/174224571863520493293247799005065242664672" = 1' (1/348449143727040986586495598010130485329344" = 1/2')
 1/348449143727040986586495598010130485329344" = 1' (1/696898287454081973172991196020260970658688" = 1/2')
 1/696898287454081973172991196020260970658688" = 1' (1/1393796574908163946345982392040521941177376" = 1/2')
 1/1393796574908163946345982392040521941177376" = 1' (1/278759314981632789269196478408104388