

L-5

F-12

FED. RD. DIVISION	STATE	PROJECT
2	OHIO	F-329 (16)

239  
268

MICROFIL  
DEC 5 1986

LAKE COUNTY  
SEC. LAK-2-7.39  
2 1/2 miles N.E. of Cleveland

B.M. #32 Lag Bolt in P.P. #599743  
175' Rt. Sta. 401+40  
B.M. #32A Lag Bolt in 12" Maple  
195' Rt. Sta. 401+00 El. 634.740

FOUNDATION SOUNDINGS  
Foundation design and foundation quantities are based on a study of rod soundings and soil sampling soundings made at the site. This sounding information may be inspected in the Interstate Project Office or in the Division Office but the State does not guarantee the accuracy thereof.

PROPOSED STRUCTURES  
TYPE: 4 Span Continuous Concrete (Reinf.) Deck with Reinforced Concrete Substructure.  
SPANS: North Bridge 38'-0" 38'-0"  
South Bridge 30'-0" 47'-6" 47'-6" 36'-0"  
ROADWAY: 42'-0" 1/4 of Parapets.  
LOAD FREQUENCY: CF 2000 Adequate for AASHTO Alternate Loading  
SKEW: 14° 56' 30" L.F.  
WEARING SURFACE: 1" Monolithic Concrete  
APPROACH SLAB: 25'-0" Long (AS-1-5A)  
ALIGNMENT: SR-2 Tangent  
SR-615 Tangent

Traffic SR-2 Reloc. 34,750 ADT (1975)  
SR-615 Reloc. 5800 ADT (1975)

Revised 1-21-59

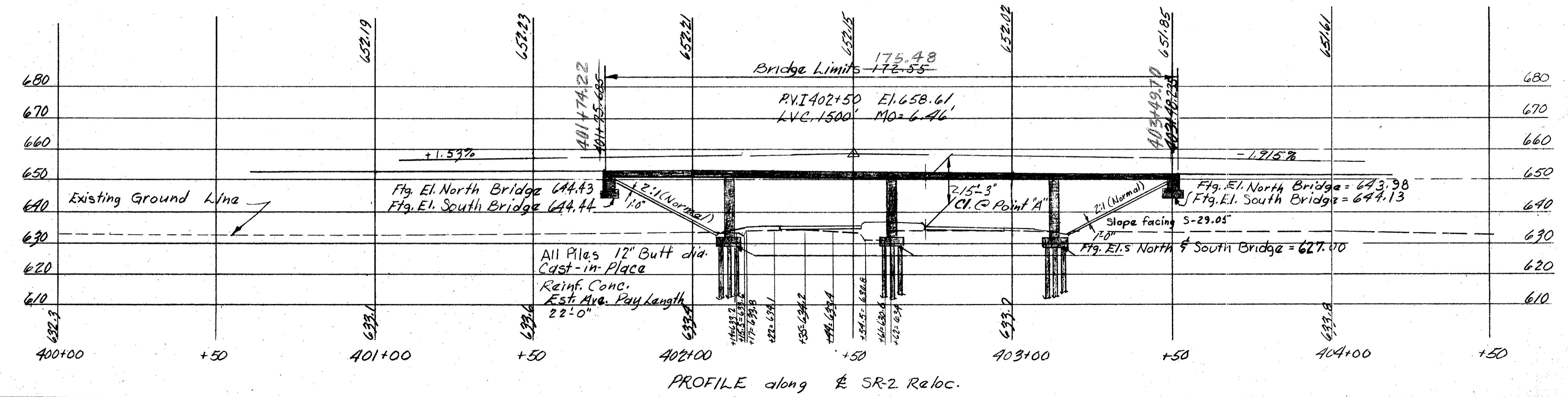
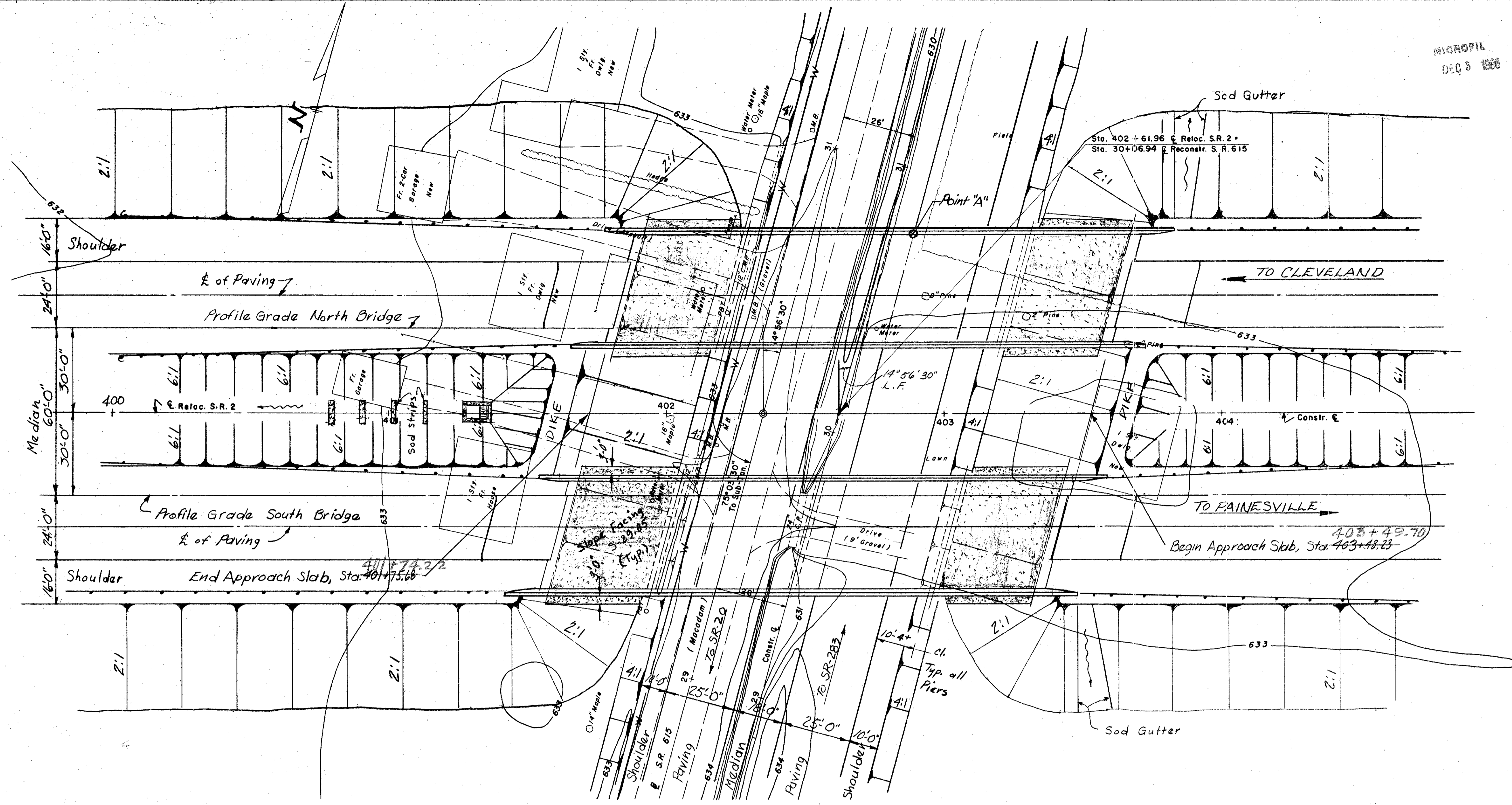

PREPARED BY CAPITOL ENGINEERING ASSOCIATES, DILLSBURG, PA. FOR					
STATE OF OHIO DEPARTMENT OF HIGHWAYS DIVISION OF DESIGN AND CONSTRUCTION BUREAU OF BRIDGES					
SITE PLAN BRIDGE NO. LAK-2-1006 RELOC. S R 2 OVER S.R. 615 LAKE COUNTY STA. 402 + 61.96					
DESIGNED	DRAWN	TRACED	CHECKED	REVISED	DATE
DRT	DRT				