

LAKE COUNTY  
SEC. LAK-2-7.39  
SHEET 235 NOT USED

MICROFIL  
DEC 5 1986

**FOUNDATION SOUNDINGS:**  
Foundation design and foundation quantities are based on a study of borings and soil-samplings made at the site. This sounding information may be inspected in the Interstate Projects Office and in the Division Office, but the State does not guarantee the accuracy thereof.

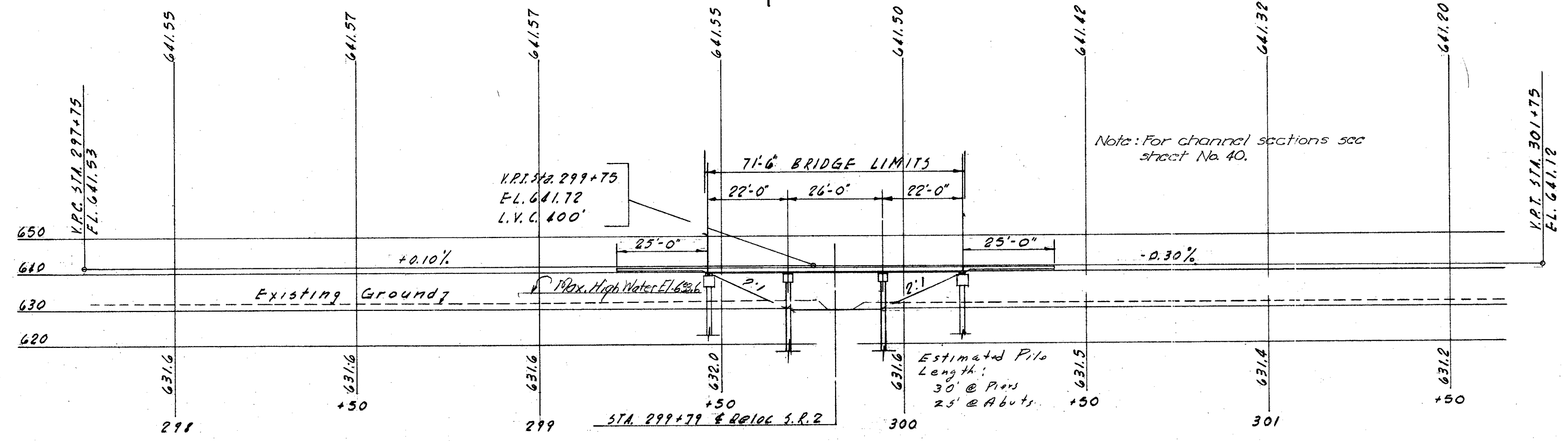
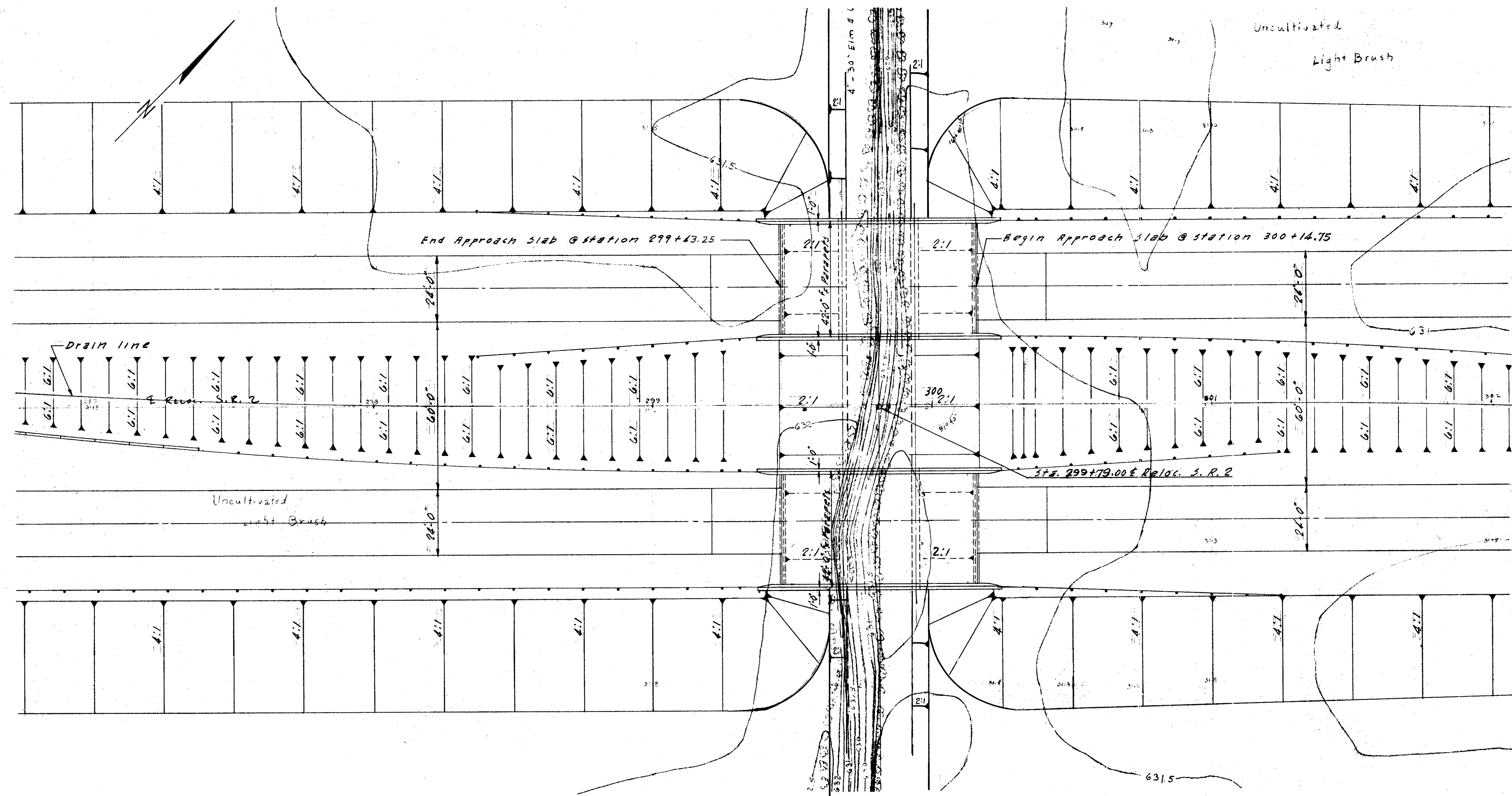

**PROPOSED STRUCTURE**  
TYPE: 3 Span Contin. Reinforced Concrete Slab & Pile Bents.  
SPANS: 22'-0", 26'-0" & 22'-0"  
ROADWAY: Two-42'-0" & Parapet  
LOAD FREQUENCY: CF-2000  
SKEW: 0°-00'-00"  
WEARING SURFACE: 1' Monolithic  
APPROACH SLAB: 25'-0" Long  
ALIGNMENT: Tangent  
DRAINAGE AREA - 3.13 SQ. MILES  
25 YEAR Q = 725 C.F.S.

Note: For channel sections see sheet No. 40.

PREPARED BY CAPITOL ENGINEERING ASSOCIATES, DILLSBURG, PA. FOR					
STATE OF OHIO DEPARTMENT OF HIGHWAYS DIVISION OF DESIGN AND CONSTRUCTION BUREAU OF BRIDGES					
SITE PLAN BRIDGE NO. LAK-2-0757 S.R. 2 OVER NEWELL CREEK LAKE COUNTY STA. 299+79.00					
DESIGNED P.J.P.	DRAWN R.V.P.	TRACED	CHECKED	REVISED DATE	REVISION

PROFILE ALONG & RELOC. S.R. 2