

LAKE COUNTY
LAK - 2 - 7.39

Controlled by Relocated Hopkins Rd. Shoulder Slope or Pav't Edge of Existing Hopkins Rd. & Stabilized Shoulder Edge of Relocated Hopkins Rd.

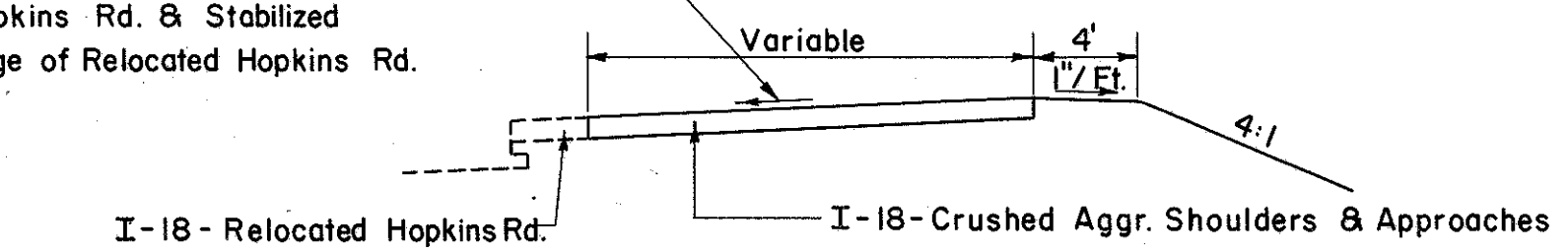

TYPICAL SECTION
HOPKINS ROAD TEMPORARY CONNECTION

CONSTR. C
CURVE DATA
P.I. Sta. 36 + 88.92
Δ = 56° 40' 00"
D = 8° 00'
R = 716.20'
L = 708.37'
T = 386.17'

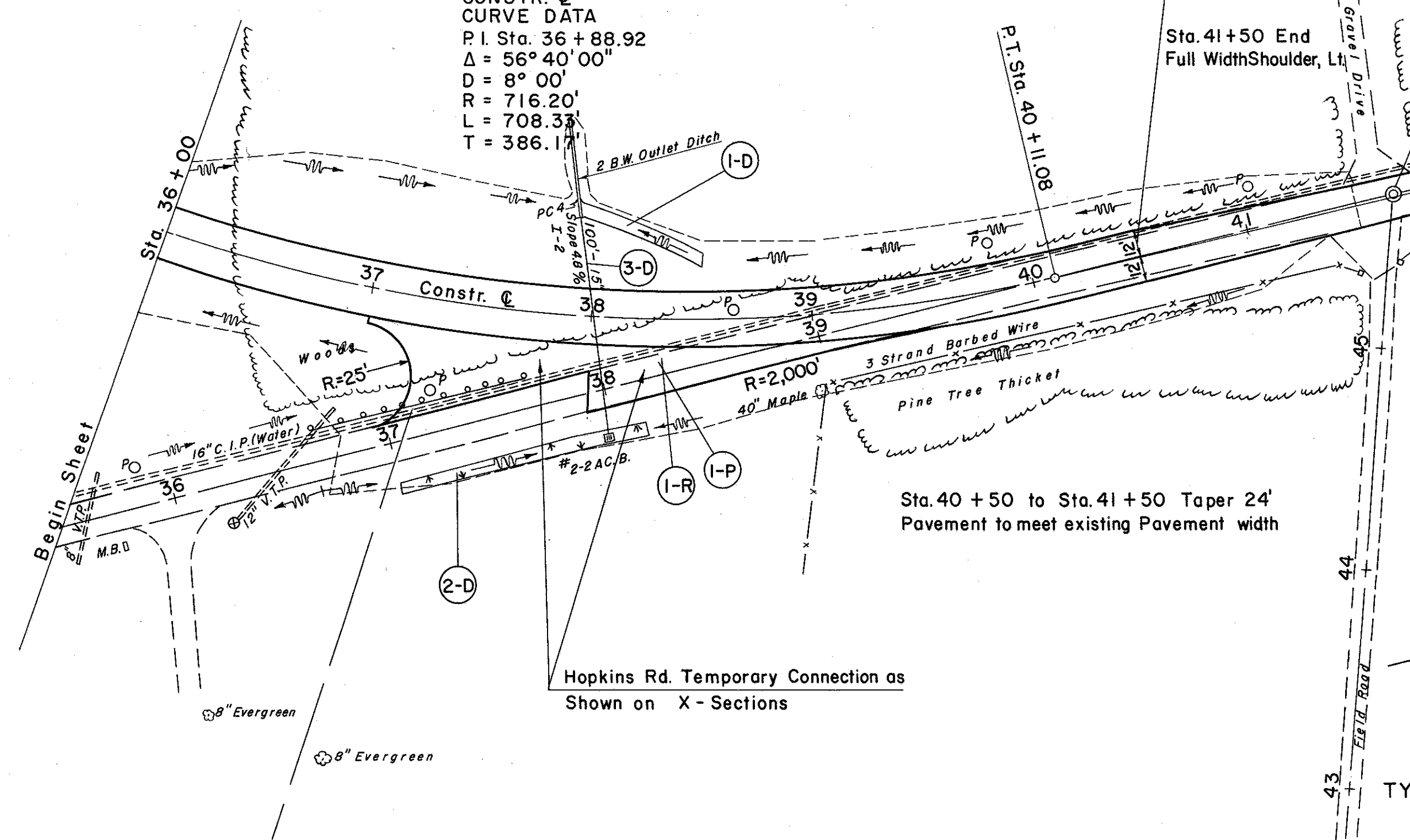

Sta. 40 + 50
End Typical Section

Sta. 41 + 50 End
Full Width Shoulder, Lt.

Sta. 41 + 68.44 @ Hopkins Road =
Sta. 45 + 70.90 @ Field Road

Sta. 41 + 80
Limit of Work

Sta. 41 + 50 to Sta. 41 + 80
Feather T-35 to meet existing
Pavement Surface.

Sta. 41 + 35 End Full Width Shoulder Rt.

Sta. 40 + 50 to Sta. 41 + 50 Taper 24'
Pavement to meet existing Pavement width

STATION	Transition		Superelevation
	ELEV. LEFT	PROFILE GRELEV. RIGHT	
40 + 75	631.51	631.84	631.77
41 + 00	631.49	631.74	631.56
41 + 25	631.38	631.56	631.28
41 + 50	631.16	631.27	630.91

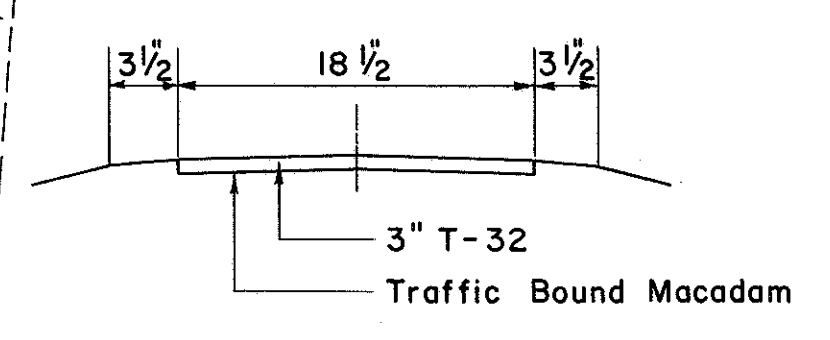

TYPICAL SECTION FOR EXISTING HOPKINS RD.

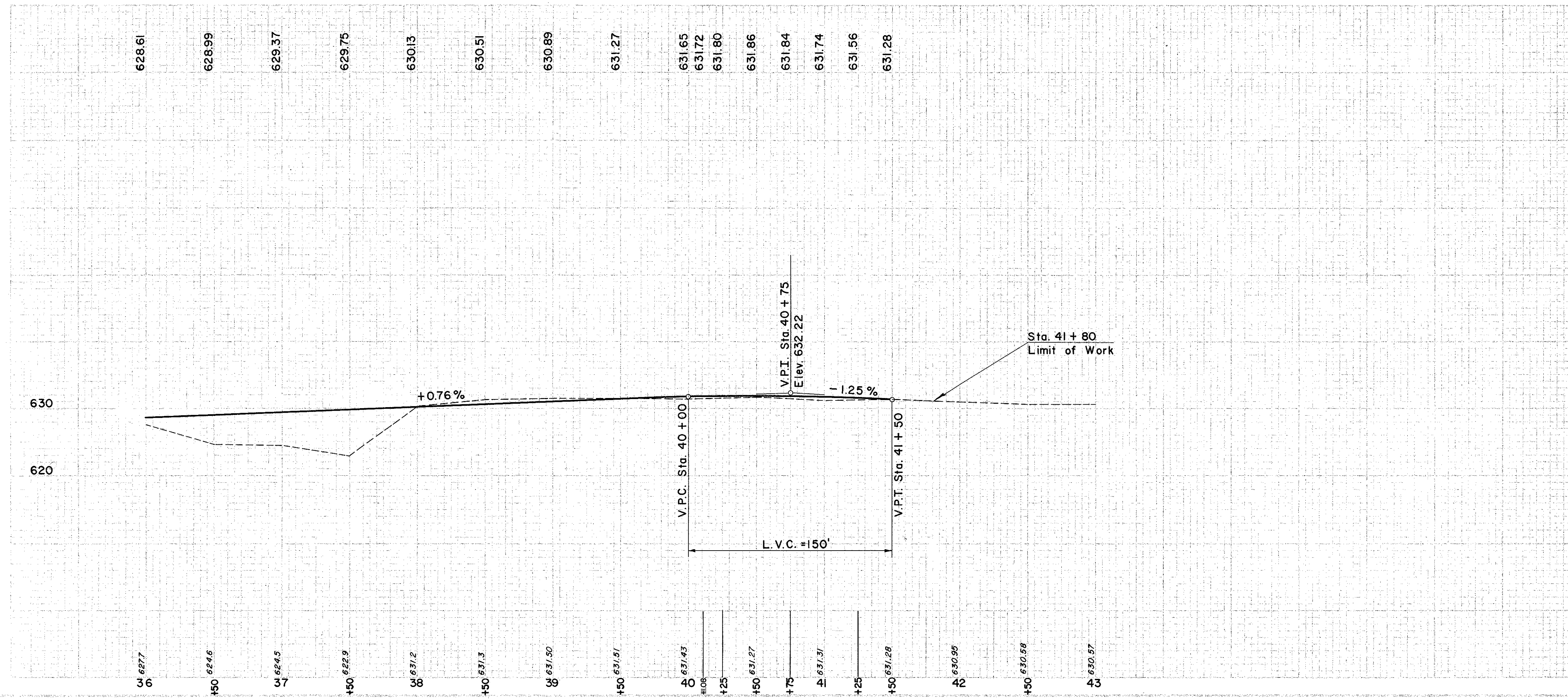

(D) DRAINAGE

REF. NO.	STATION	SIDE	SODDING CEMENT STABILIZED SW/UNDER INLET		SY.	L.Y.	EA.	CONC. FOR STRUCT. C.I. E.	S-1	E-2
			FROM	TO						
I-D	37+92	LT.	38+50	43						
2-D	37+29	RT.	38+27	77	100	1	0.26			
3-D	38+00									

(P) PAVEMENT

REF. NO.	STATION	SIDE	I-18 SIDE CRUSHED AGGR. SHOULDER & APPR.		C.Y.
			FROM	TO	
I-P	37+00	RT.	39+00	70	70

EXCAVATION	1,150 C.Y.
EMBANKMENT	2,018 C.Y.
EMBANKMENT	2,422 C.Y.

(R) ROADWAY

REF. NO.	STATION	SIDE	E-101 SIDE COMPACTED SUBGRADE		S.Y.
			FROM	TO	
I-R	37+00	RT.	39+00	422	422