

LAKE COUNTY  
LAK-2-739

FOR OTHER DETAILS  
SEE SHEET NO. 147 & 165

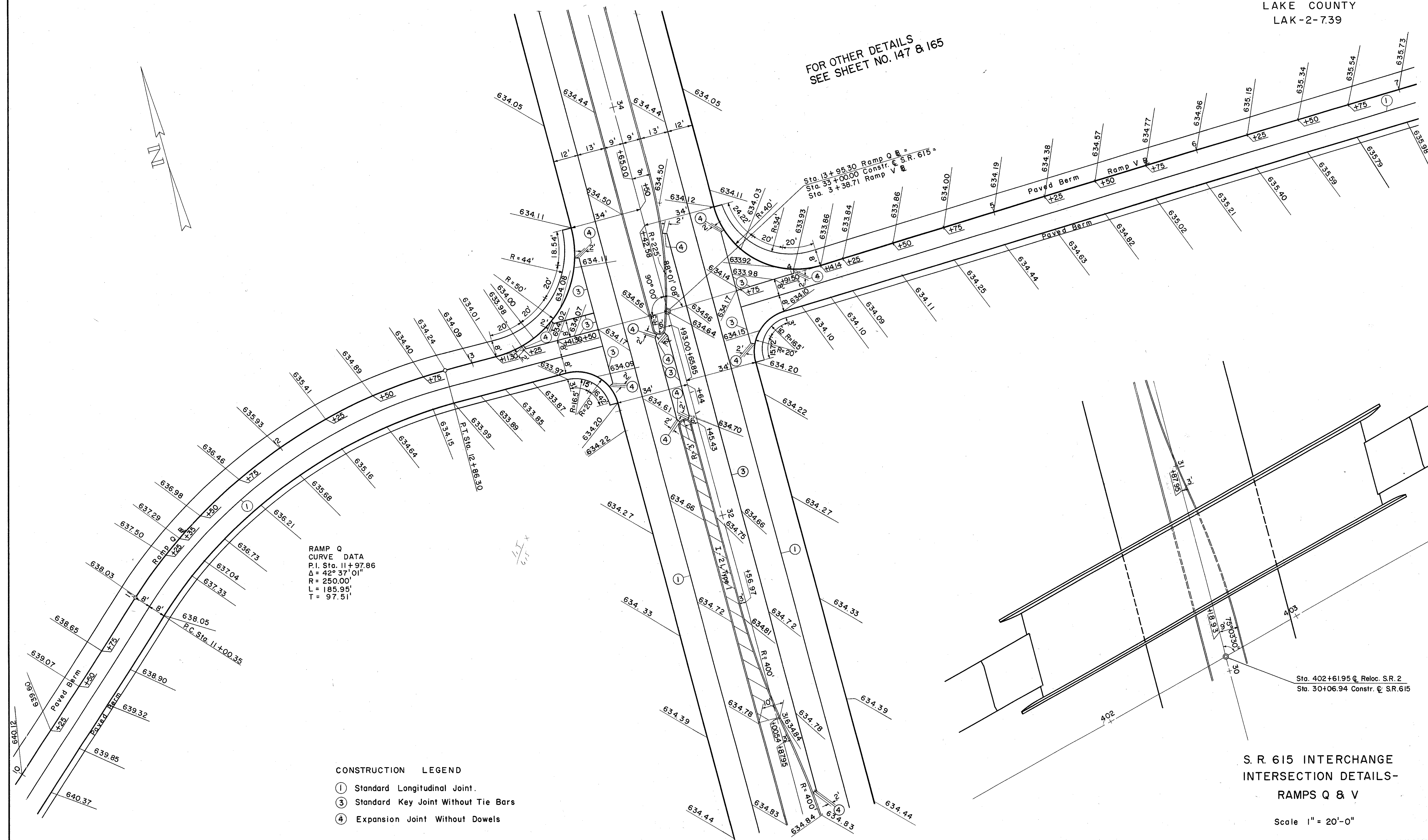
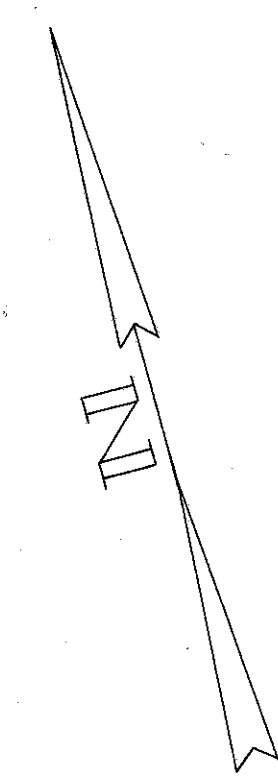

RAMP Q  
CURVE DATA  
P.I. Sta. 11+97.86  
 $\Delta = 42^\circ 37' 01''$   
R = 250.00'  
L = 185.95'  
T = 97.51'

CONSTRUCTION LEGEND

- ① Standard Longitudinal Joint.
- ③ Standard Key Joint Without Tie Bars
- ④ Expansion Joint Without Dowels

S. R. 615 INTERCHANGE  
INTERSECTION DETAILS-  
RAMPS Q & V

Scale 1" = 20'-0"