

LAKE COUNTY
LAK-2-7.39

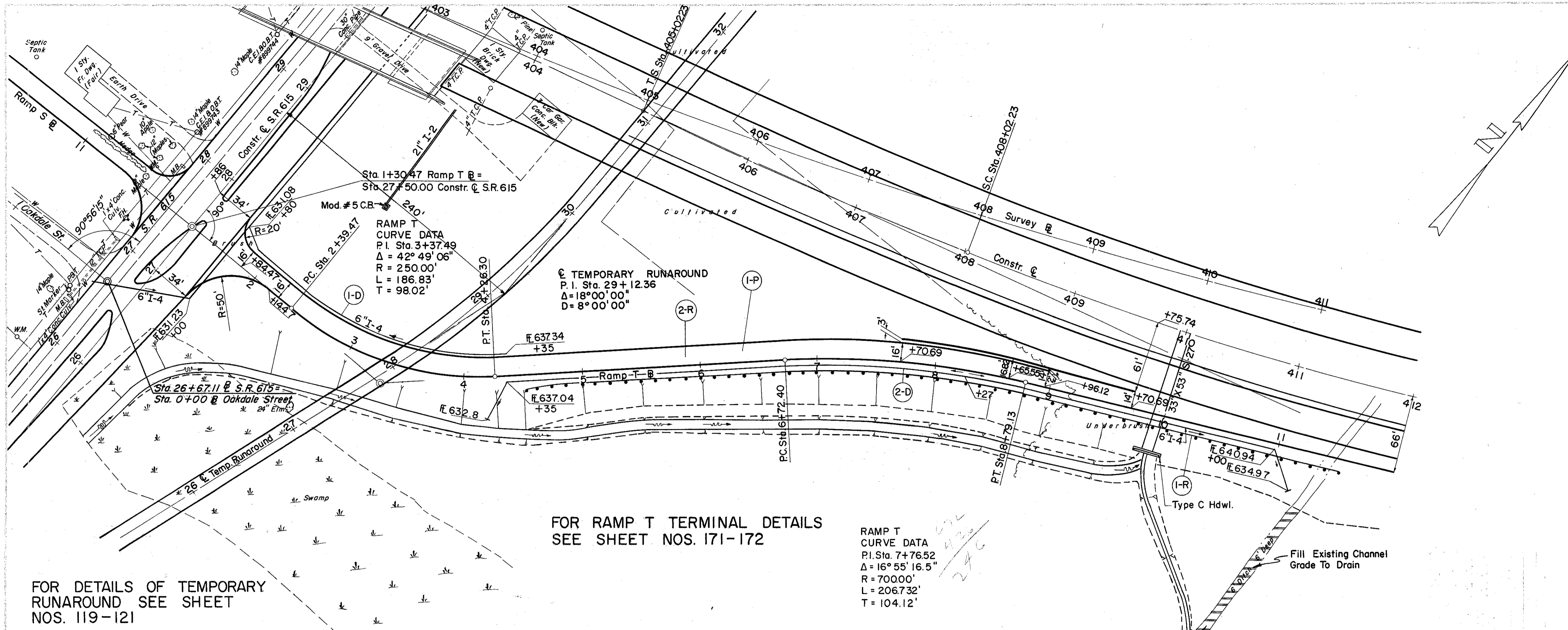

FOR DETAILS OF TEMPORARY RUNAROUND SEE SHEET NOS. 119-121

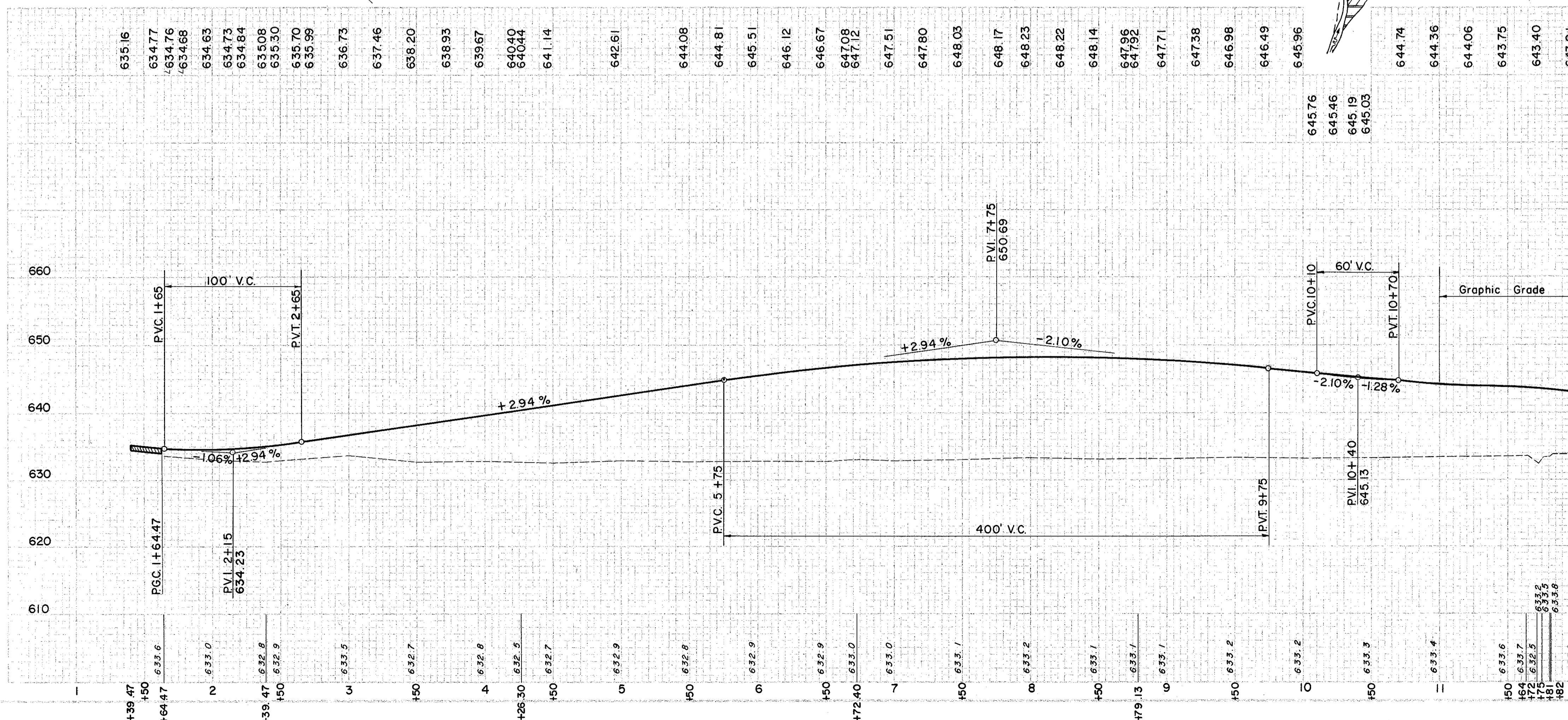

(D) DRAINAGE

REF. NO.	STATION	SIDE	DESCRIPTION	DEPTH	LENGTH	RT.	EA
I-4	4+35	UNDER-LET	6" PIPE DRAIN SHALLOW M-64(0)	265	710	20	2
I-5	6+60	BEND	6" - 30" BEND				

(P) PAVEMENT

REF. NO.	STATION	SIDE	DESCRIPTION	DEPTH	LENGTH	C.Y.	EA
I-12	1+12	SPCL	4' CONC. MEDIAN TYPE 6 CONC. CURB				
I-21	1+21	CONC.	10" CONC. SUB-BASE				
I-22	1+22	CONC.	5" CONC. AGGR.				
T-31	NO. 46	BIT. MATL.	NO. 46 BIT. MATL. AGGR.				
I-18	206	S.Y.	206 S.Y. GAL				
I-71	1862.56	S.Y.	1862.56 S.Y. GAL				

(R) ROADWAY

REF. NO.	STATION	SIDE	DESCRIPTION	DEPTH	LENGTH	RT.	EA
I-15	4+47	GUARD RAIL	GUARD RAIL	700	700		3645
E-101	12+00	COMP. SUB-GRADE	COMP. SUB-GRADE				

EXCAVATION	503 C.Y.
EMBANKMENT	22,533 C.Y.
EMBANKMENT + 20'	27,040 C.Y.