

LAKE COUNTY
LAK-2-7.39

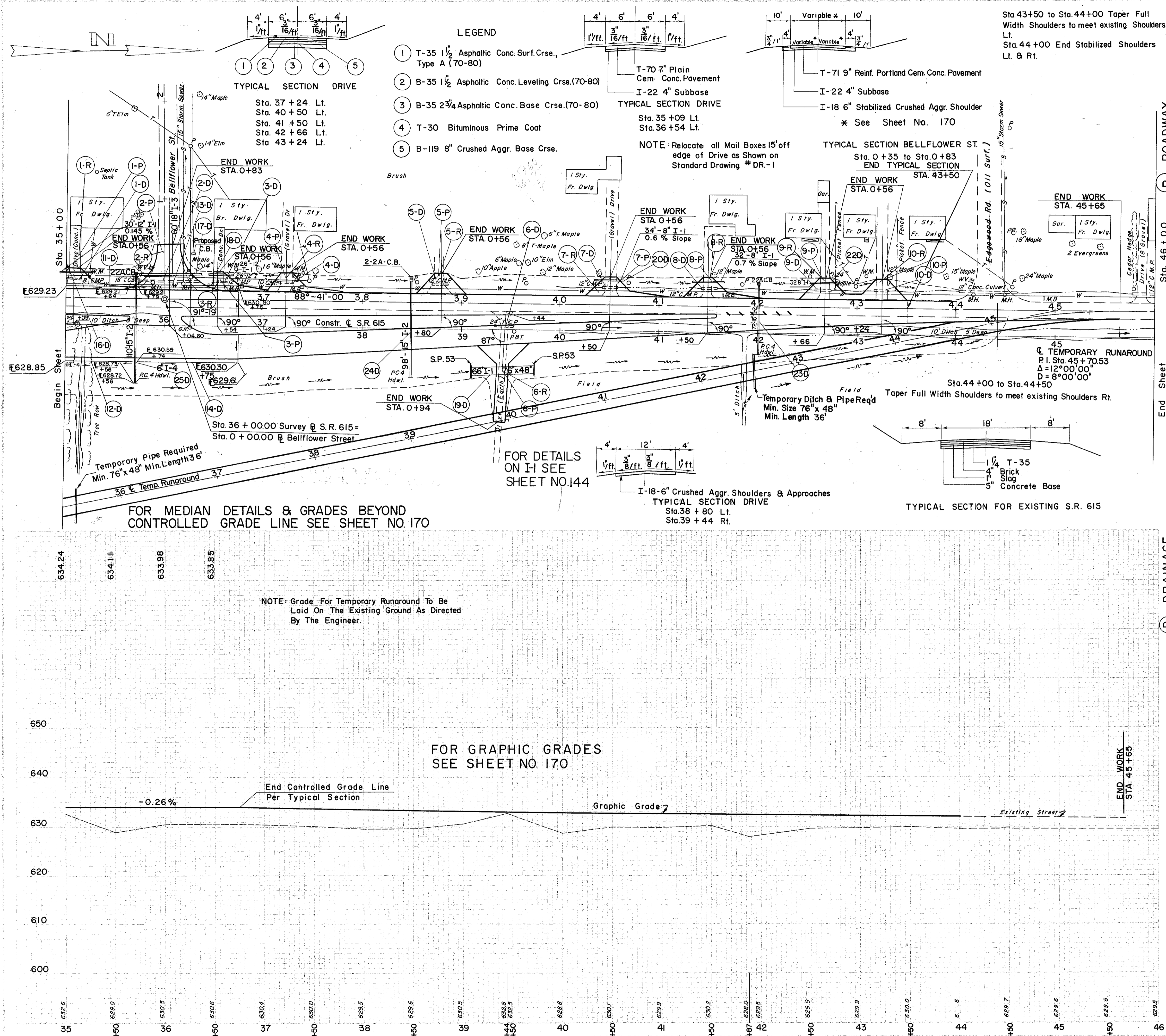

- LEGEND**
- 1 T-35 1 1/2" Asphaltic Conc. Surf. Crse., Type A (70-80)
 - 2 B-35 1 1/2" Asphaltic Conc. Leveling Crse. (70-80)
 - 3 B-35 2 3/4" Asphaltic Conc. Base Crse. (70-80)
 - 4 T-30 Bituminous Prime Coat
 - 5 B-119 8" Crushed Aggr. Base Crse.
- TYPICAL SECTION DRIVE**
- 1 4" 1/ft
 - 2 6" 16/ft
 - 3 6" 16/ft
 - 4 4" 1/ft
 - 5 1/ft
- TYPICAL SECTION BELLFLOWER ST.**
- 10' Variable x 10'
 - 10' Variable x 10'
 - 10' Variable x 10'
 - 10' Variable x 10'
- TYPICAL SECTION DRIVE**
- T-70 7" Plain Cem. Conc. Pavement
 - I-22 4" Subbase
 - T-71 9" Reinf. Portland Cem. Conc. Pavement
 - I-22 4" Subbase
 - I-18 6" Stabilized Crushed Aggr. Shoulder
 - * See Sheet No. 170
- NOTE:** Relocate all Mail Boxes 15' off edge of Drive as Shown on Standard Drawing # DR.-1

REF. NO.	STATION	FROM	TO	TYPE	QTY
E-8	ROADWAY	35+00	46+00	REMOVAL & DISPOSAL EXISTING PAVEMENT	25
E-101	ROADWAY	35+00	46+00	COMP. SUB-GRADE PAVEMENT	929
TOTAL					954

REF. NO.	STATION	ITEM	QTY	
			FROM	TO
I-1	35+00	PIPE FOR DRIVEWAY	3.0	26
I-2	35+00	PIPE FOR DRIVEWAY	24	32
I-3	35+00	PIPE FOR DRIVEWAY	26	76
I-4	35+00	PIPE FOR DRIVEWAY	0.26	0.26
I-5	35+00	PIPE FOR DRIVEWAY	0.26	0.26
I-6	35+00	PIPE FOR DRIVEWAY	0.26	0.26
I-7	35+00	PIPE FOR DRIVEWAY	0.26	0.26
I-8	35+00	PIPE FOR DRIVEWAY	0.26	0.26
I-9	35+00	PIPE FOR DRIVEWAY	0.26	0.26
I-10	35+00	PIPE FOR DRIVEWAY	0.26	0.26
I-11	35+00	PIPE FOR DRIVEWAY	0.26	0.26
I-12	35+00	PIPE FOR DRIVEWAY	0.26	0.26
I-13	35+00	PIPE FOR DRIVEWAY	0.26	0.26
I-14	35+00	PIPE FOR DRIVEWAY	0.26	0.26
I-15	35+00	PIPE FOR DRIVEWAY	0.26	0.26
I-16	35+00	PIPE FOR DRIVEWAY	0.26	0.26
I-17	35+00	PIPE FOR DRIVEWAY	0.26	0.26
I-18	35+00	PIPE FOR DRIVEWAY	0.26	0.26
I-19	35+00	PIPE FOR DRIVEWAY	0.26	0.26
I-20	35+00	PIPE FOR DRIVEWAY	0.26	0.26
I-21	35+00	PIPE FOR DRIVEWAY	0.26	0.26
I-22	35+00	PIPE FOR DRIVEWAY	0.26	0.26
I-23	35+00	PIPE FOR DRIVEWAY	0.26	0.26
I-24	35+00	PIPE FOR DRIVEWAY	0.26	0.26
I-25	35+00	PIPE FOR DRIVEWAY	0.26	0.26
I-26	35+00	PIPE FOR DRIVEWAY	0.26	0.26
I-27	35+00	PIPE FOR DRIVEWAY	0.26	0.26
I-28	35+00	PIPE FOR DRIVEWAY	0.26	0.26
I-29	35+00	PIPE FOR DRIVEWAY	0.26	0.26
I-30	35+00	PIPE FOR DRIVEWAY	0.26	0.26
I-31	35+00	PIPE FOR DRIVEWAY	0.26	0.26
I-32	35+00	PIPE FOR DRIVEWAY	0.26	0.26
I-33	35+00	PIPE FOR DRIVEWAY	0.26	0.26
I-34	35+00	PIPE FOR DRIVEWAY	0.26	0.26
I-35	35+00	PIPE FOR DRIVEWAY	0.26	0.26
I-36	35+00	PIPE FOR DRIVEWAY	0.26	0.26
I-37	35+00	PIPE FOR DRIVEWAY	0.26	0.26
I-38	35+00	PIPE FOR DRIVEWAY	0.26	0.26
I-39	35+00	PIPE FOR DRIVEWAY	0.26	0.26
I-40	35+00	PIPE FOR DRIVEWAY	0.26	0.26
I-41	35+00	PIPE FOR DRIVEWAY	0.26	0.26
I-42	35+00	PIPE FOR DRIVEWAY	0.26	0.26
I-43	35+00	PIPE FOR DRIVEWAY	0.26	0.26
I-44	35+00	PIPE FOR DRIVEWAY	0.26	0.26
I-45	35+00	PIPE FOR DRIVEWAY	0.26	0.26
I-46	35+00	PIPE FOR DRIVEWAY	0.26	0.26
I-47	35+00	PIPE FOR DRIVEWAY	0.26	0.26
I-48	35+00	PIPE FOR DRIVEWAY	0.26	0.26
I-49	35+00	PIPE FOR DRIVEWAY	0.26	0.26
I-50	35+00	PIPE FOR DRIVEWAY	0.26	0.26
I-51	35+00	PIPE FOR DRIVEWAY	0.26	0.26
I-52	35+00	PIPE FOR DRIVEWAY	0.26	0.26
I-53	35+00	PIPE FOR DRIVEWAY	0.26	0.26
I-54	35+00	PIPE FOR DRIVEWAY	0.26	0.26
I-55	35+00	PIPE FOR DRIVEWAY	0.26	0.26
I-56	35+00	PIPE FOR DRIVEWAY	0.26	0.26
I-57	35+00	PIPE FOR DRIVEWAY	0.26	0.26
I-58	35+00	PIPE FOR DRIVEWAY	0.26	0.26
I-59	35+00	PIPE FOR DRIVEWAY	0.26	0.26
I-60	35+00	PIPE FOR DRIVEWAY	0.26	0.26
I-61	35+00	PIPE FOR DRIVEWAY	0.26	0.26
I-62	35+00	PIPE FOR DRIVEWAY	0.26	0.26
I-63	35+00	PIPE FOR DRIVEWAY	0.26	0.26
I-64	35+00	PIPE FOR DRIVEWAY	0.26	0.26
I-65	35+00	PIPE FOR DRIVEWAY	0.26	0.26
I-66	35+00	PIPE FOR DRIVEWAY	0.26	0.26
I-67	35+00	PIPE FOR DRIVEWAY	0.26	0.26
I-68	35+00	PIPE FOR DRIVEWAY	0.26	0.26
I-69	35+00	PIPE FOR DRIVEWAY	0.26	0.26
I-70	35+00	PIPE FOR DRIVEWAY	0.26	0.26
I-71	35+00	PIPE FOR DRIVEWAY	0.26	0.26
I-72	35+00	PIPE FOR DRIVEWAY	0.26	0.26
I-73	35+00	PIPE FOR DRIVEWAY	0.26	0.26
I-74	35+00	PIPE FOR DRIVEWAY	0.26	0.26
I-75	35+00	PIPE FOR DRIVEWAY	0.26	0.26
I-76	35+00	PIPE FOR DRIVEWAY	0.26	0.26
I-77	35+00	PIPE FOR DRIVEWAY	0.26	0.26
I-78	35+00	PIPE FOR DRIVEWAY	0.26	0.26
I-79	35+00	PIPE FOR DRIVEWAY	0.26	0.26
I-80	35+00	PIPE FOR DRIVEWAY	0.26	0.26
I-81	35+00	PIPE FOR DRIVEWAY	0.26	0.26
I-82	35+00	PIPE FOR DRIVEWAY	0.26	0.26
I-83	35+00	PIPE FOR DRIVEWAY	0.26	0.26
I-84	35+00	PIPE FOR DRIVEWAY	0.26	0.26
I-85	35+00	PIPE FOR DRIVEWAY	0.26	0.26
I-86	35+00	PIPE FOR DRIVEWAY	0.26	0.26
I-87	35+00	PIPE FOR DRIVEWAY	0.26	0.26
I-88	35+00	PIPE FOR DRIVEWAY	0.26	0.26
I-89	35+00	PIPE FOR DRIVEWAY	0.26	0.26
I-90	35+00	PIPE FOR DRIVEWAY	0.26	0.26
I-91	35+00	PIPE FOR DRIVEWAY	0.26	0.26
I-92	35+00	PIPE FOR DRIVEWAY	0.26	0.26
I-93	35+00	PIPE FOR DRIVEWAY	0.26	0.26
I-94	35+00	PIPE FOR DRIVEWAY	0.26	0.26
I-95	35+00	PIPE FOR DRIVEWAY	0.26	0.26
I-96	35+00	PIPE FOR DRIVEWAY	0.26	0.26
I-97	35+00	PIPE FOR DRIVEWAY	0.26	0.26
I-98	35+00	PIPE FOR DRIVEWAY	0.26	0.26
I-99	35+00	PIPE FOR DRIVEWAY	0.26	0.26
I-100	35+00	PIPE FOR DRIVEWAY	0.26	0.26

REF. NO.	STATION	ITEM	QTY	
			FROM	TO
P-1	35+00	PAVEMENT	67	10
P-2	35+00	PAVEMENT	78	10
P-3	35+00	PAVEMENT	27	10
P-4	35+00	PAVEMENT	127	10
P-5	35+00	PAVEMENT	67	10
P-6	35+00	PAVEMENT	78	10
P-7	35+00	PAVEMENT	27	10
P-8	35+00	PAVEMENT	127	10
P-9	35+00	PAVEMENT	67	10
P-10	35+00	PAVEMENT	78	10
P-11	35+00	PAVEMENT	27	10
P-12	35+00	PAVEMENT	127	10
P-13	35+00	PAVEMENT	67	10
P-14	35+00	PAVEMENT	78	10
P-15	35+00	PAVEMENT	27	10
P-16	35+00	PAVEMENT	127	10
P-17	35+00	PAVEMENT	67	10
P-18	35+00	PAVEMENT	78	10
P-19	35+00	PAVEMENT	27	10
P-20	35+00	PAVEMENT	127	10
P-21	35+00	PAVEMENT	67	10
P-22	35+00	PAVEMENT	78	10
P-23	35+00	PAVEMENT	27	10
P-24	35+00	PAVEMENT	127	10
P-25	35+00	PAVEMENT	67	10
P-26	35+00	PAVEMENT	78	10
P-27	35+00	PAVEMENT	27	10
P-28	35+00	PAVEMENT	127	10
P-29	35+00	PAVEMENT	67	10
P-30	35+00	PAVEMENT	78	10
P-31	35+00	PAVEMENT	27	10
P-32	35+00	PAVEMENT	127	10
P-33	35+00	PAVEMENT	67	10
P-34	35+00	PAVEMENT	78	10
P-35	35+00	PAVEMENT	27	10
P-36	35+00	PAVEMENT	127	10
P-37	35+00	PAVEMENT	67	10
P-38	35+00	PAVEMENT	78	10
P-39	35+00	PAVEMENT	27	10
P-40	35+00	PAVEMENT	127	10
P-41	35+00	PAVEMENT	67	10
P-42	35+00	PAVEMENT	78	10
P-43	35+00	PAVEMENT	27	10
P-44	35+00	PAVEMENT	127	10
P-45	35+00	PAVEMENT	67	10
P-46	35+00	PAVEMENT	78	10
P-47	35+00	PAVEMENT	27	10
P-48	35+00	PAVEMENT	127	10
P-49	35+00	PAVEMENT	67	10
P-50	35+00	PAVEMENT	78	10

EXCAVATION	3714 C.Y.
EMBANKMENT	1439 C.Y.
TOTAL	20 1727