

FOR DETAILS ON 8" I-3  
SEE SHEET NOS. 27-28

FOR DETAILS ON I-2 & MANHOLES  
SEE SHEET NO. 27

NOTE: 15" x 18" Tee is to be used as a Flush Hole and is to be capped as directed by the Engineer

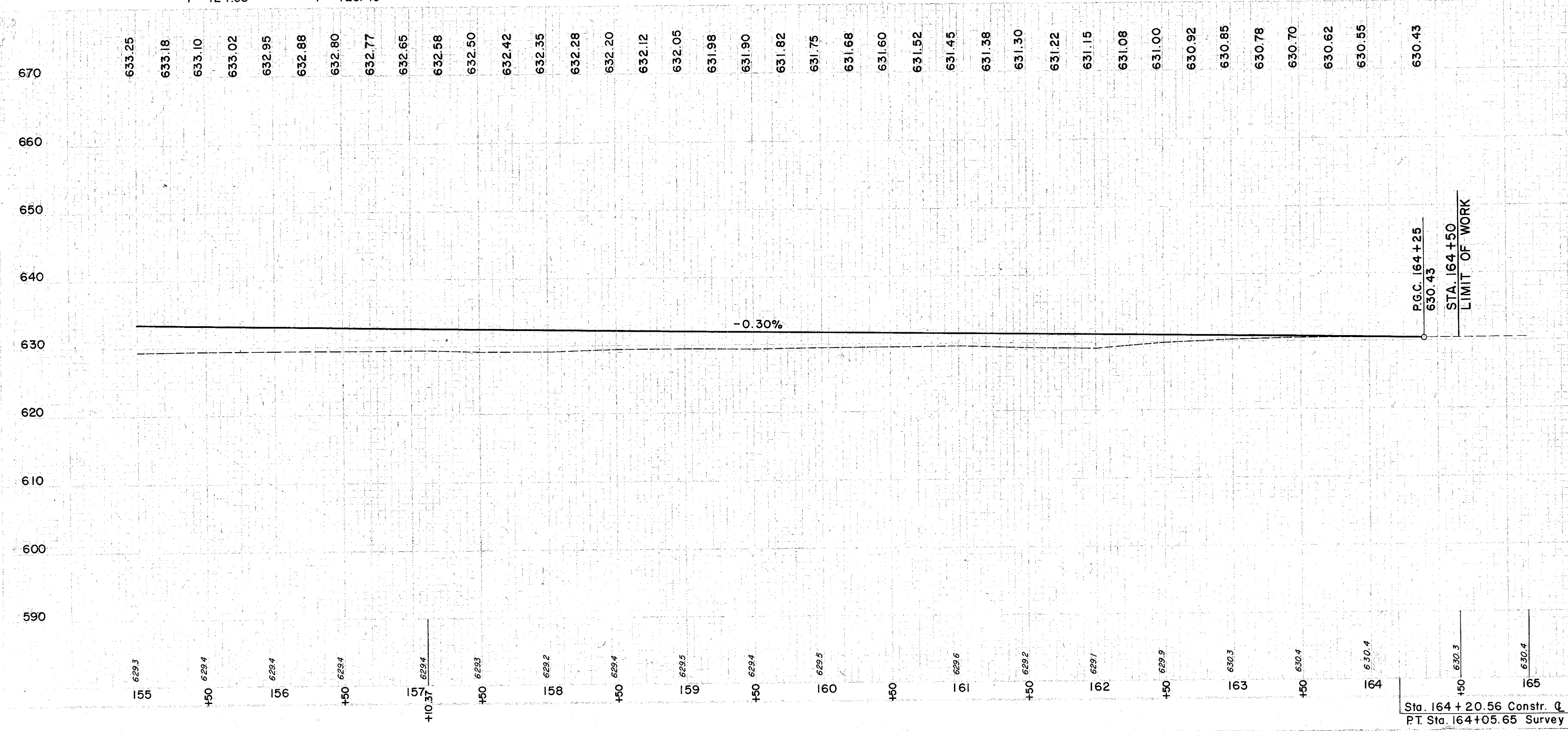
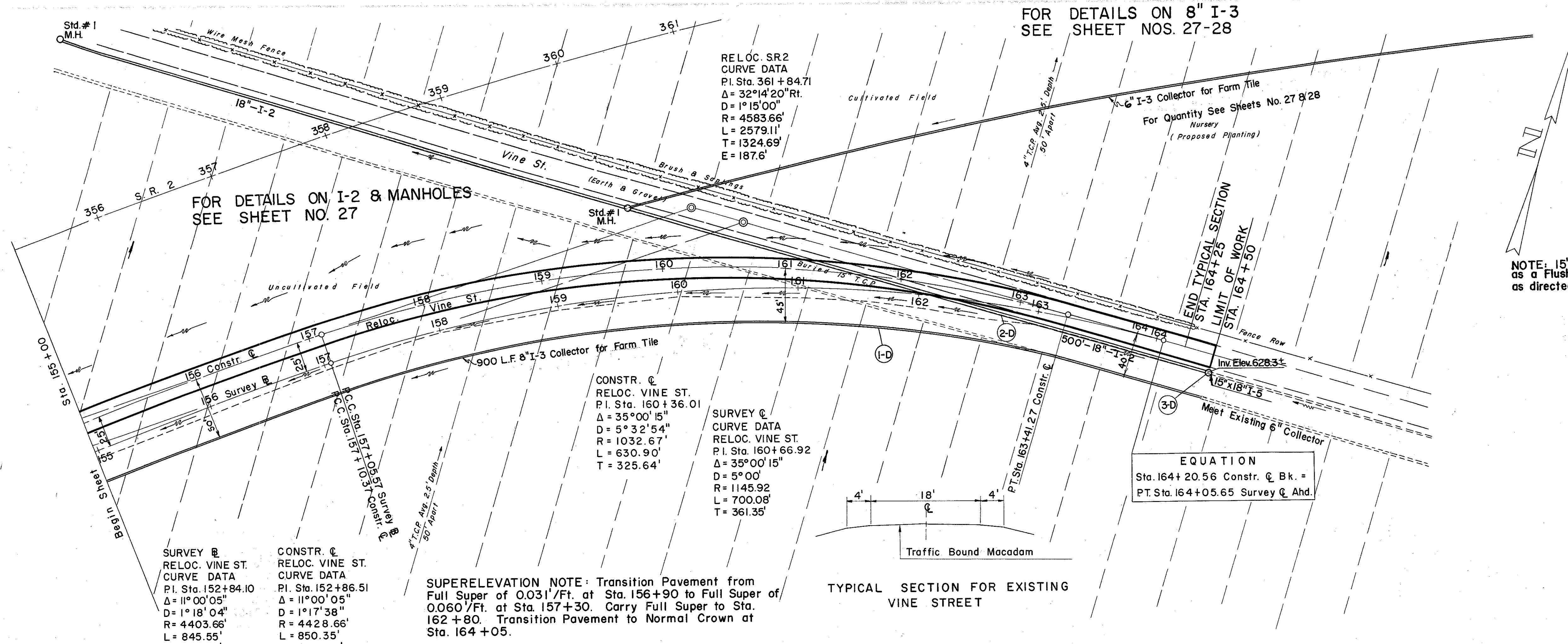

① DRAINAGE

REF. NO.	STATION	SIDE	8" ROADWAY DRAINAGE	I-3	I-5	I-2	E-12
1-D	FROM 155+00 TO 164+50	RT.	L.F.	EA	EA	L.F.	L.F.
2-D	159+80 TO 164+65	RT.	L.F.	EA	EA	L.F.	L.F.
3-D	164+50	RT.	L.F.	EA	EA	L.F.	L.F.

PIPE SPECIAL 18" x 15" TEE  
PIPE SPECIAL 8" x 4" TEE  
PIPE SPECIAL 15" x 4" TEE UNDER P.C. STR. SMRS. UNDER P.C. STR. SMRS. UNDER P.C. STR. SMRS.

Excavation	379 C.Y.
Backfill	2,630 C.Y.
Gravel	3,156 C.Y.

Sta. 164+20.56 Constr. C Bk. =  
PT. Sta. 164+05.65 Survey C Ahd.

RELOC. VINE ST. STA. 155+00 TO STA. 164+50