

LAKE COUNTY
 LAK-2-7.39

REV. 11-4-58
 This sheet replaces
 Sheet No. 82 of the
 original plans.

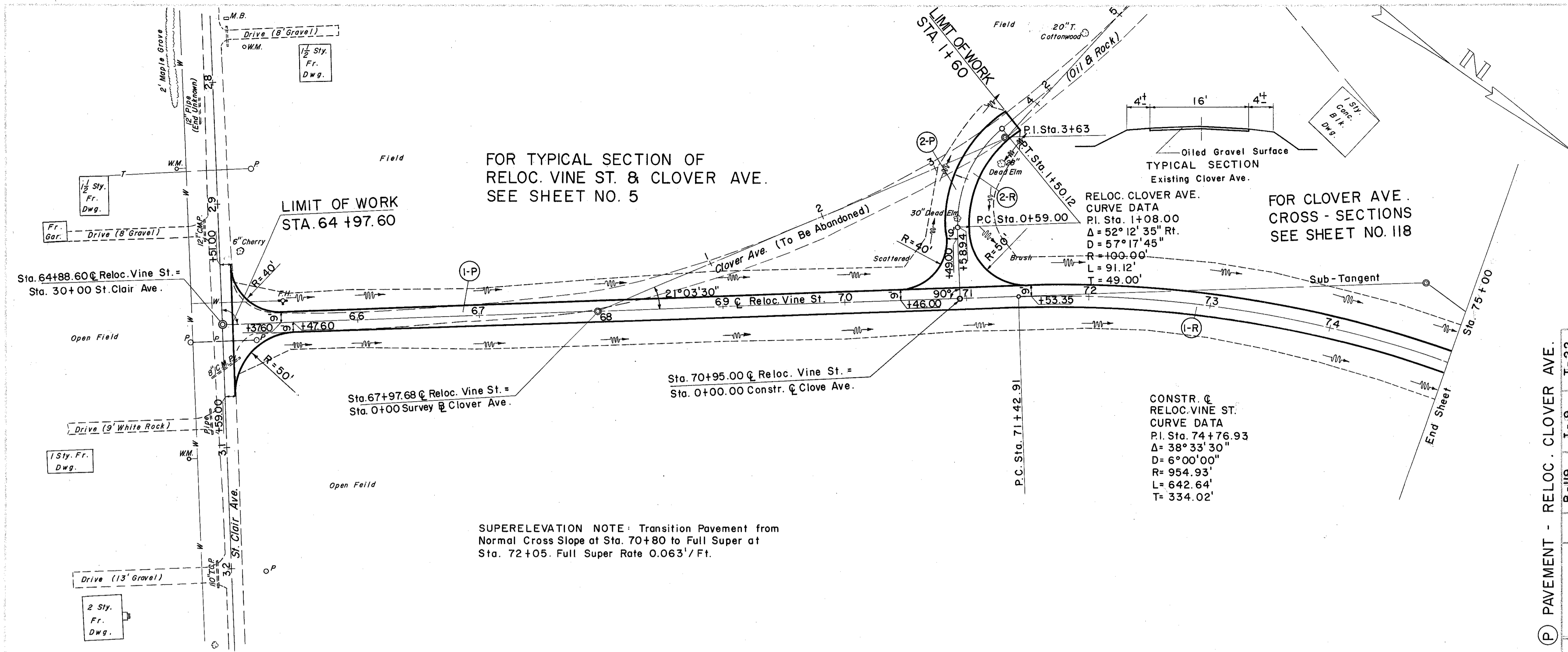

SUPERELEVATION NOTE: Transition Pavement from Normal Cross Slope at Sta. 70+80 to Full Super at Sta. 72+05. Full Super Rate 0.063'/Ft.

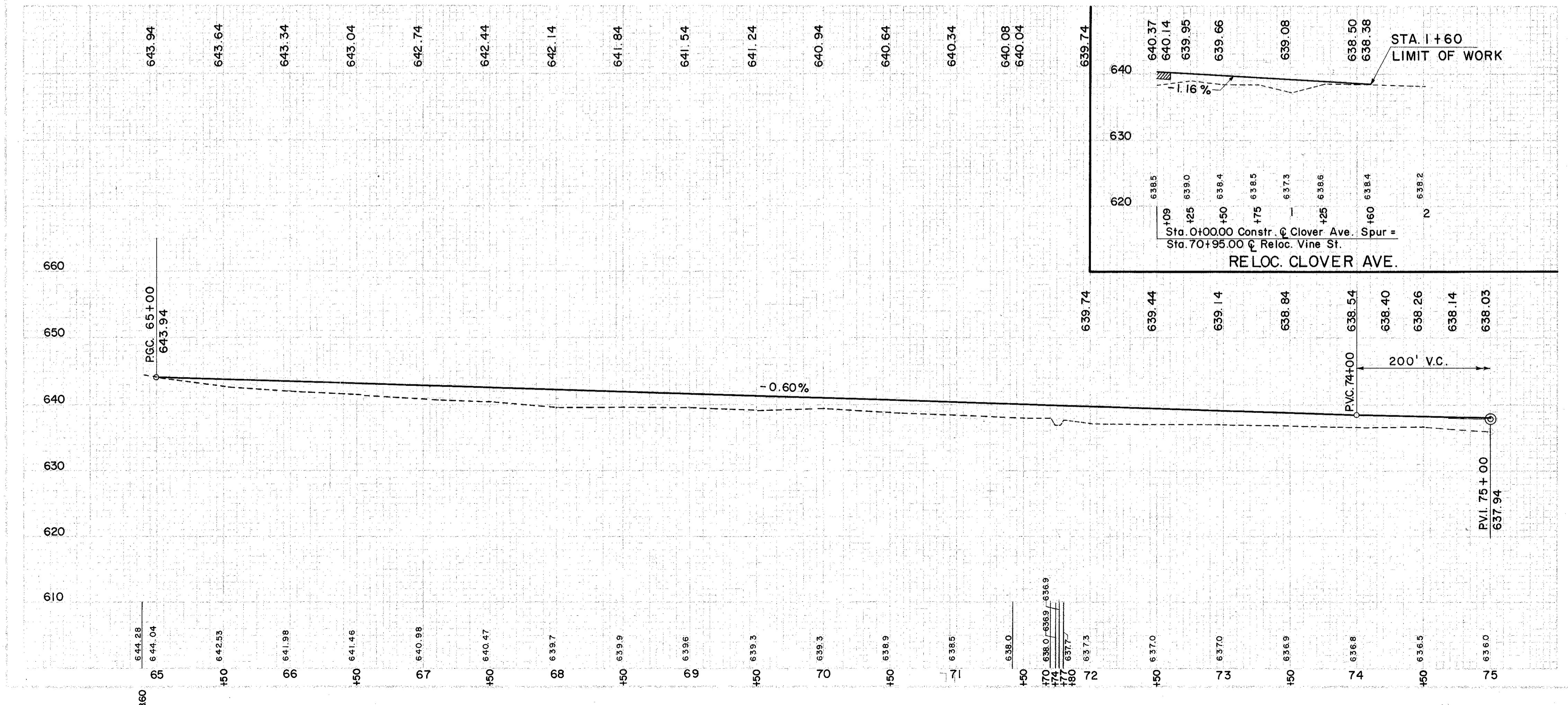

(P) PAVEMENT - RELOC. CLOVER AVE.

REF. STATION NO.	FROM TO	5" CRUSHED AGGR. BASE (NO.2)	STONE U-DRAIN SUBBASE	4" SUBBASE	I-9	I-22
2-P	0+09	1+60	5.6	4.0	4.0	4.7

(R) ROADWAY - RELOC. CLOVER AVE.

REF. STATION NO.	FROM TO	SIDE	COMPACTED SUBGRADE	CALCIUM CHLORIDE	S.Y.	TONS
2-R	0+09	1+60	4.20	0.4		

(P) PAVEMENT - RELOC. VINE ST.

REF. STATION NO.	FROM TO	5" CRUSHED AGGR. BASE (NO.2)	STONE U-DRAIN SUBBASE	4" SUBBASE	I-9	I-22
1-P	64+97.60	64+50	2.771	2.550	2.348	2.348

(R) ROADWAY - RELOC. VINE ST.

REF. STATION NO.	FROM TO	SIDE	COMMERCIAL SEEDING & FERTILIZER PROTECT.	CALCIUM CHLORIDE	S.Y.	TONS
1-R	64+97.60	64+50	5	52.750	21.169	1.0

* Includes Clover Ave.

EXCAVATION	= 565 C.Y.
EMBANKMENT	= 1682 C.Y.
EMBANKMENT <20%	= 2018 C.Y.