

Seeding
End
Width
So.
Yes.

LAKE COUNTY
LAK-2-7.39
REV. 3-17-59

End	Area	Cu. Yds.	
Cut	Fill	Cut	Fill
62	927		
138	752		
174	830		
134	1167		
82	1171		
79	1299		

NOTE:
This sheet supersedes
Sheet No. 79.

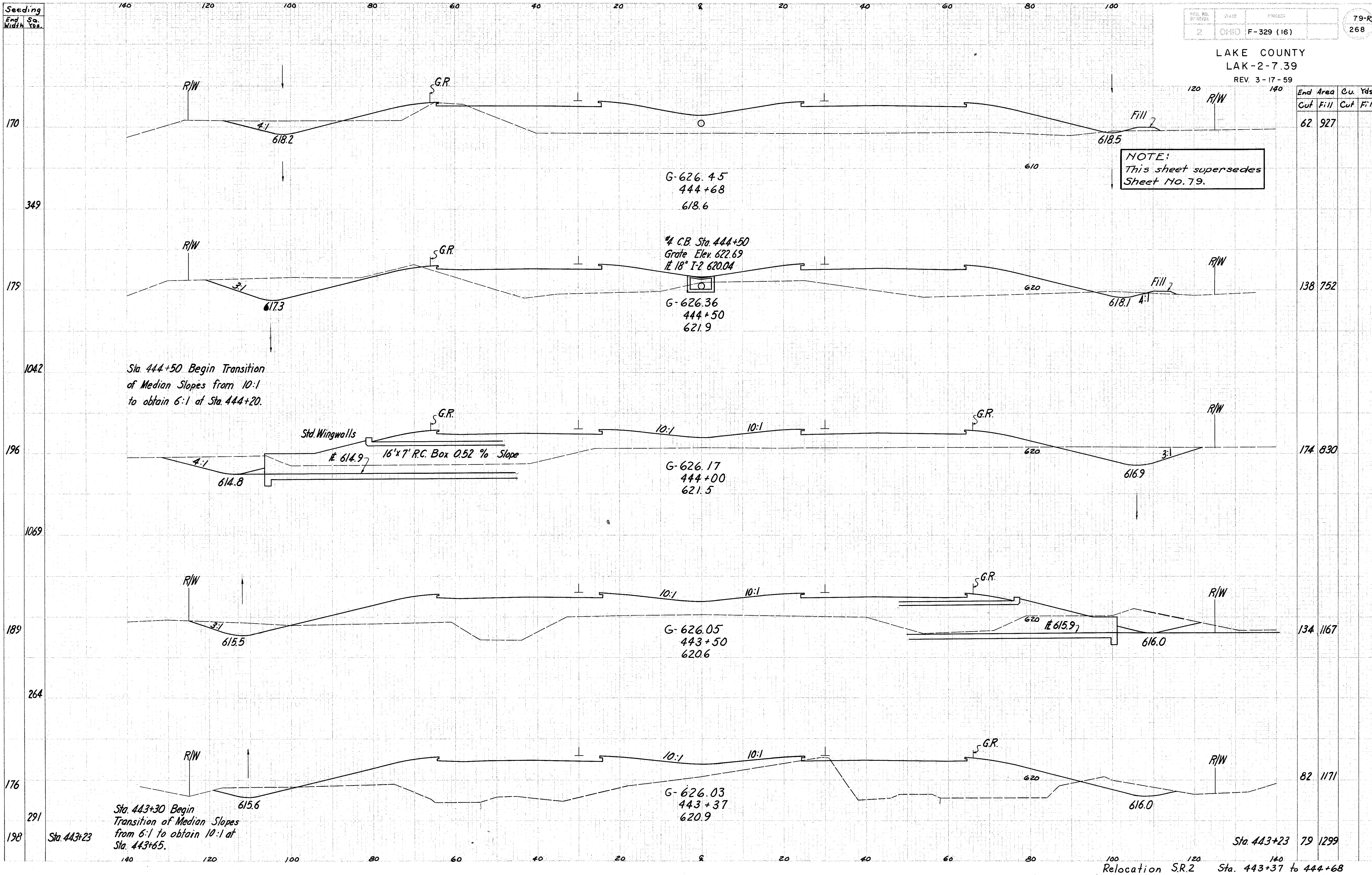

Sta. 444+50 Begin Transition
of Median Slopes from 10:1
to obtain 6:1 at Sta. 444+20.

Sta. 443+30 Begin
Transition of Median Slopes
from 6:1 to obtain 10:1 at
Sta. 443+65.

Relocation S.R.2 Sta. 443+37 to 444+68