

SEEDING
 END W/ 27th YRS.
 SO. YRS.

LAKE COUNTY
 LAK-2-7.39

STA. 383+25 END MEDIAN SLOPE
 TRANSITION 10:1 TO 6:1
 BEGIN TRANSITION TO OBTAIN
 10:1 AT STA. 388+34

STA 380+50 END MEDIAN SLOPE TRANSITION
 6:1 TO 10:1. BEGIN TRANSITION TO OBTAIN
 6:1 AT STA. 383+25.

GRATE EL # 4.C.B.
 INVERT EL 15" I-4
 635.97
 635.64
 633.54

Templated by
 J. R. F. 1/16/58
 A. D. S. 1/16-58
 m. 9-16-58

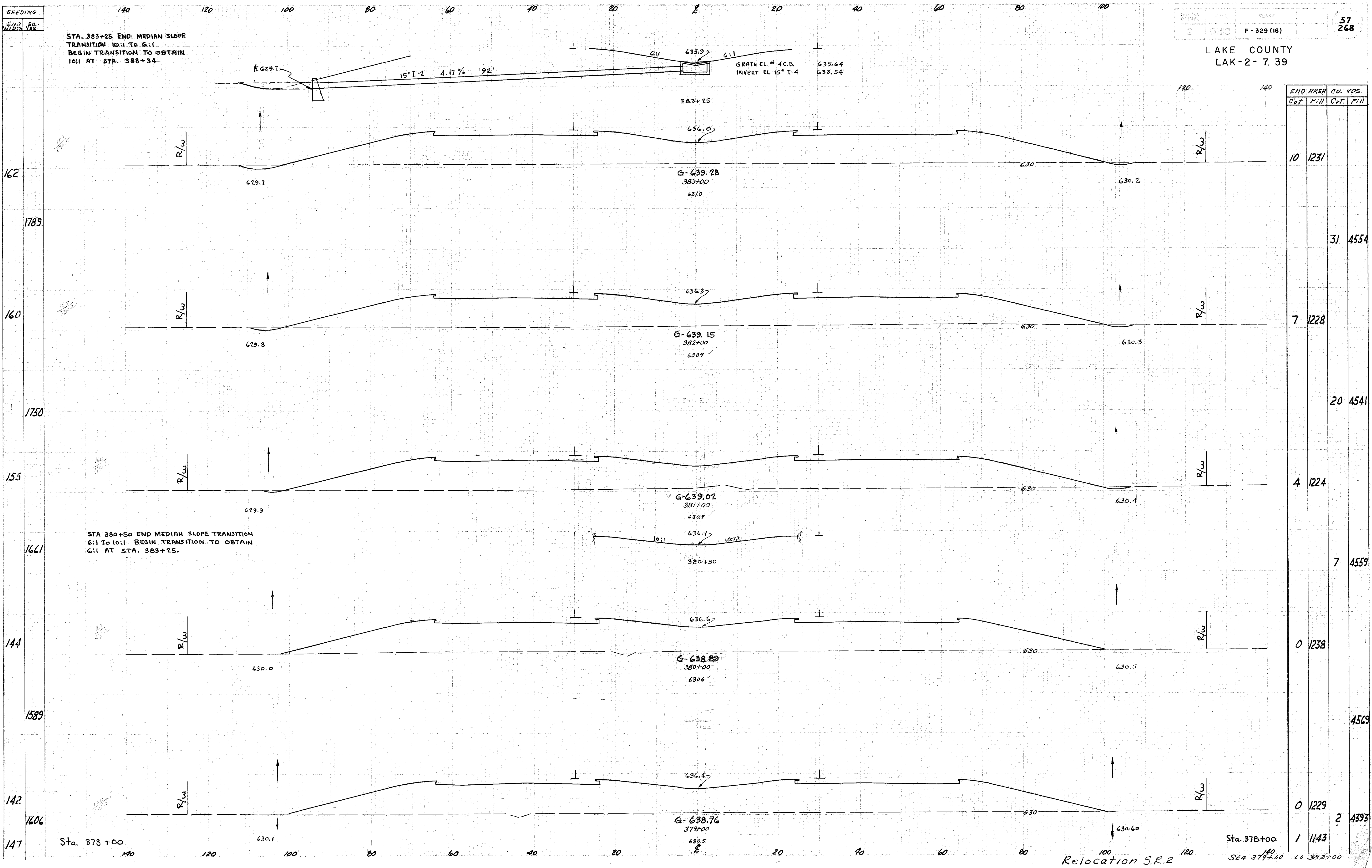

| END AREA | | CU. YDS. | |
|----------|------|----------|------|
| Cut | Fill | Cut | Fill |
| 10 | 1231 | | |
| | | 31 | 4554 |
| 7 | 1228 | | |
| | | 20 | 4541 |
| 4 | 1224 | | |
| | | 7 | 4559 |
| 0 | 1238 | | |
| | | | 4569 |
| 0 | 1229 | | |
| | | 2 | 4393 |
| 1 | 1143 | | |

Relocation S.R.2
 Sta. 378+00
 Sta. 379+00 to 383+00