

SEEDING
 STA. 351+26 END MEDIAN
 SLOPE TRANSITION TO G:11
 BEGIN TRANSITION FROM G:11
 TO OBTAIN 10:1 AT STA. 354+22

LAKE COUNTY
 LAK-2-7.39

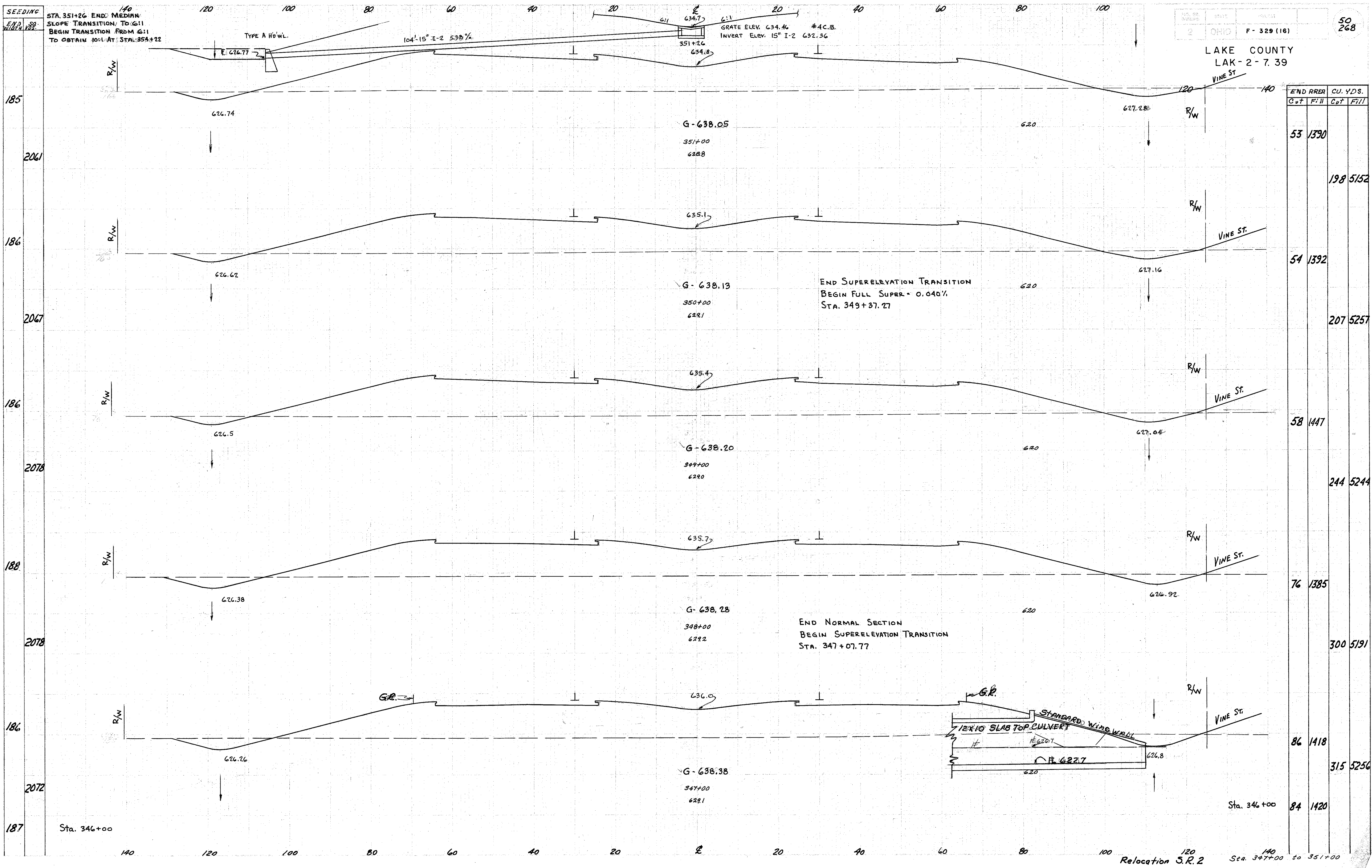

END CUT	RRER F:11	CU. YDS.	
		CUT	FILL
53	1390	198	5152
54	1392	207	5257
58	1447	244	5244
76	1385	300	5191
86	1418	315	5256
84	1420		

Revisions to R
 1-2-58
 1-12
 Check Book 9-11-58

140 120 100 80 60 40 20 0 20 40 60 80 100 120
 Sta. 346+00 Relocation S.R.2 Sta. 347+00 to 351+00