

FED. RD. DIVISION	STATE	PROJECT	
2	OHIO	F-329 (16)	

36R
258

LAKE COUNTY
LAK-2-7.39

REV. 3-17-59

NOTE:
This sheet supersedes
Sheet No. 36.

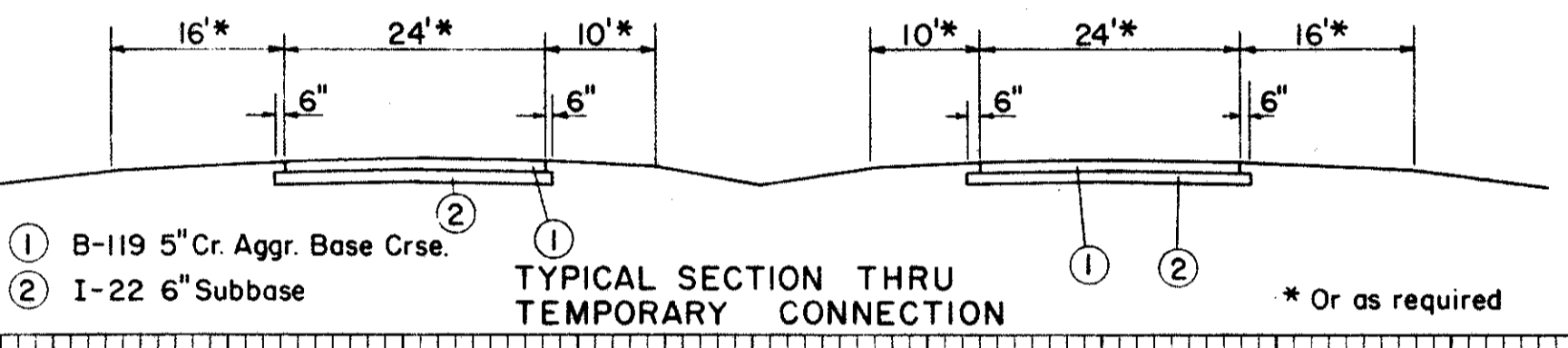
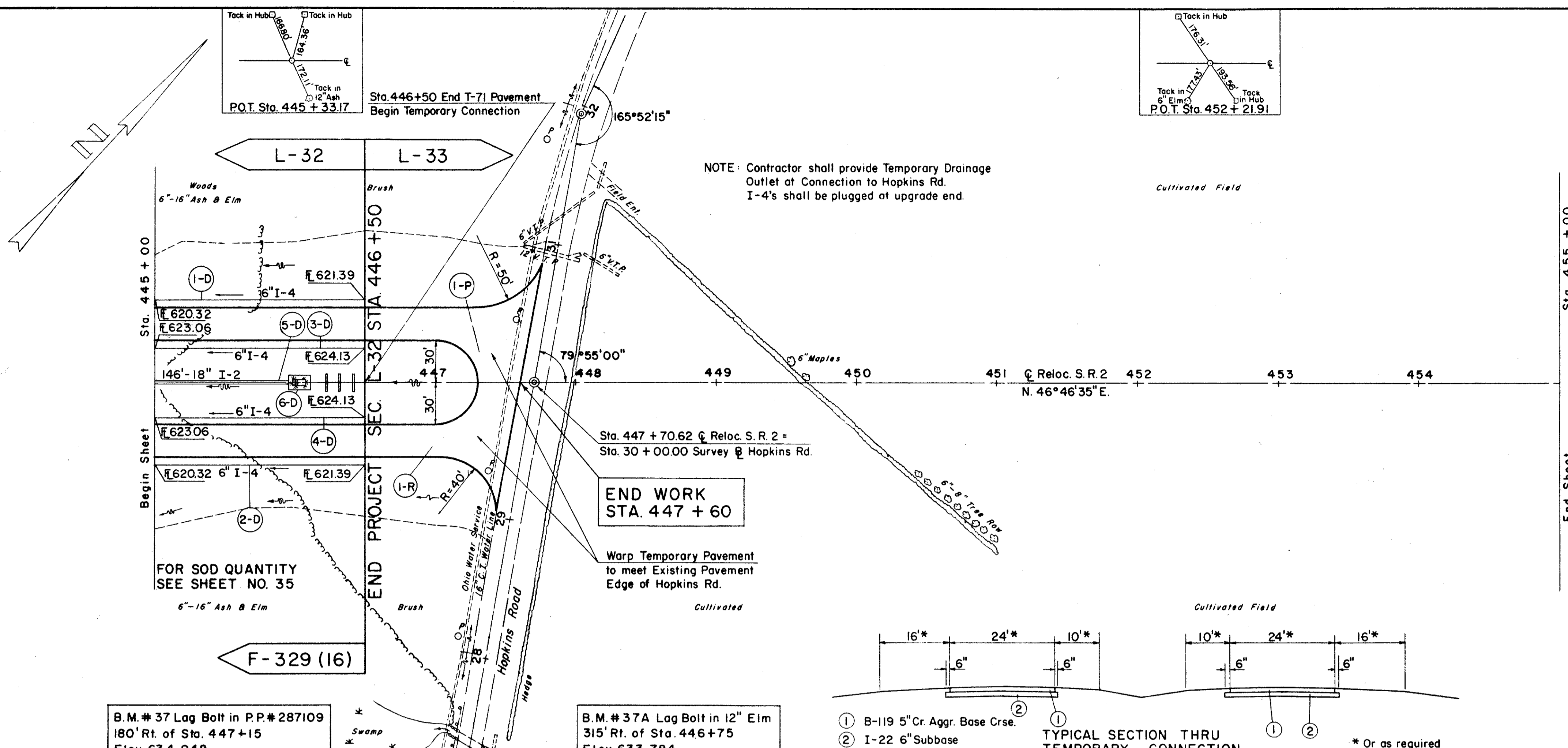

B.M. #37 Lag Bolt in P.P. #287109
180' Rt. of Sta. 447+15
Elev. 634.948

B.M. #37A Lag Bolt in 12" Elm
315' Rt. of Sta. 446+75
Elev. 633.784

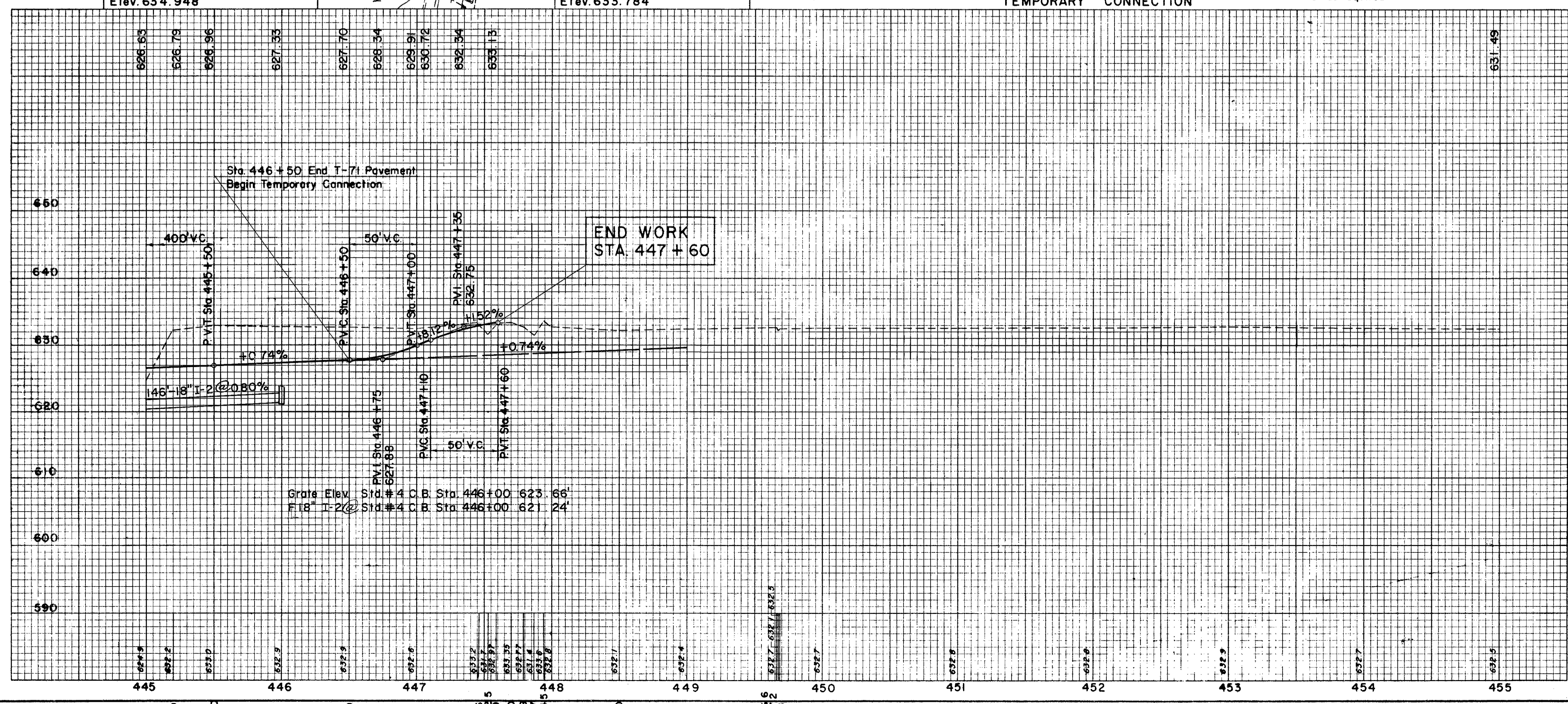

(D) DRAINAGE

REF NO.	STATION	SIDE DRAIN		UNDER DRAIN		L.F.	EA.	S.Y.
		DEEP	SHALLOW	DEEP	SHALLOW			
I-4	445+00 to 446+50					150		
I-2	445+00 to 446+50					150		
I-4	445+00 to 446+50					150		
I-4	445+00 to 446+50					150		
I-4	445+00 to 446+50					96		
I-10	446+50 to 447+60							22.5

(P) PAVEMENT

REF NO.	STATION	SIDE AGGR. BASE		SUBBASE		C.Y.	C.Y.
		FROM	TO	FROM	TO		
B-119	447+60 to 448+00					131	161
I-22	447+60 to 448+00						

(R) ROADWAY

REF NO.	STATION	SIDE		C.Y.
		FROM	TO	
I-10	446+50 to 447+60			1015

EXCAVATION = 7,340 C.Y.
EMBANKMENT = 757 C.Y.
EMBANKMENT +20% = 908 C.Y.