

LAKE COUNTY
LAK-2-739

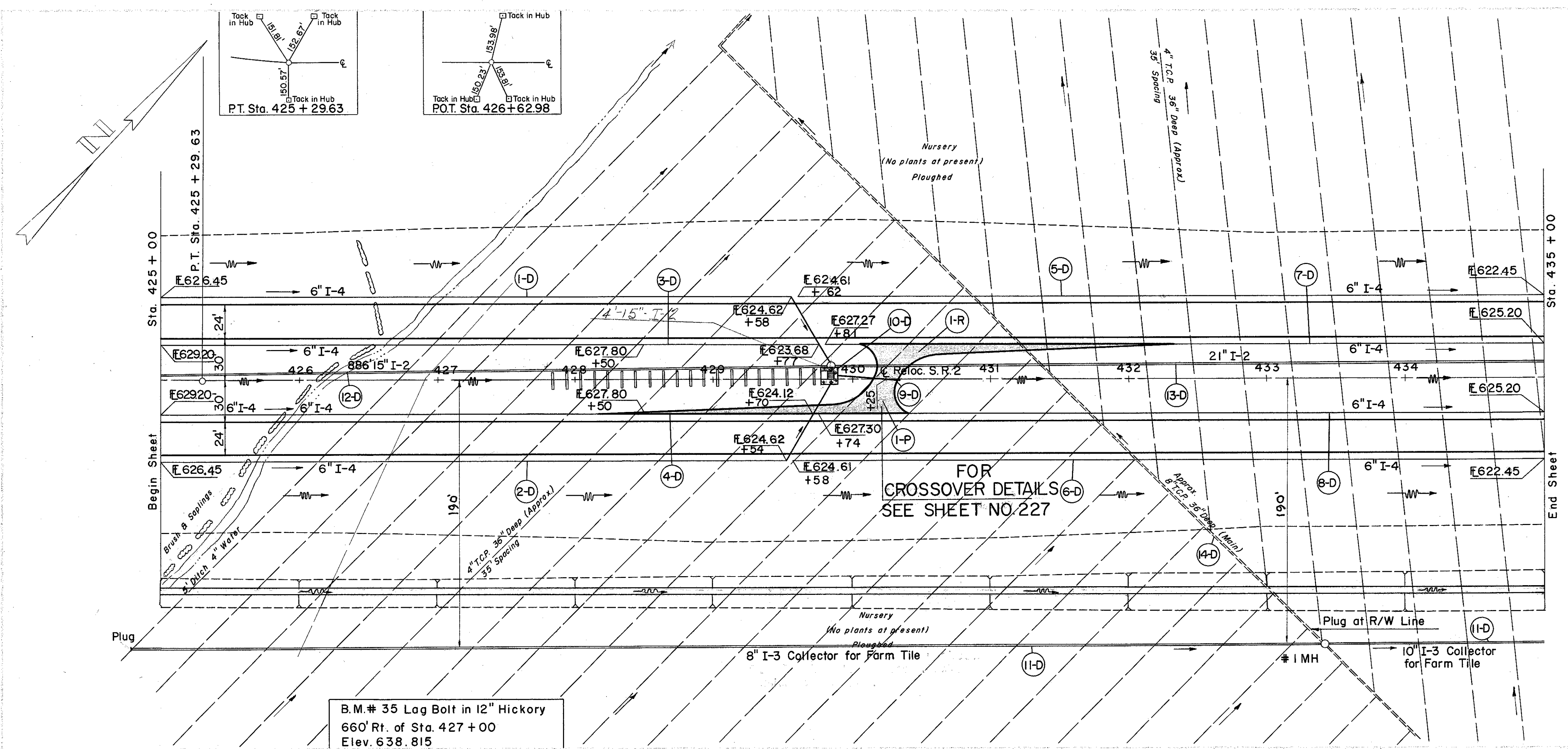

B.M. # 35 Log Bolt in 12" Hickory
660' Rt. of Sta. 427+00
Elev. 638.815

FOR
CROSSOVER DETAILS
SEE SHEET NO. 227

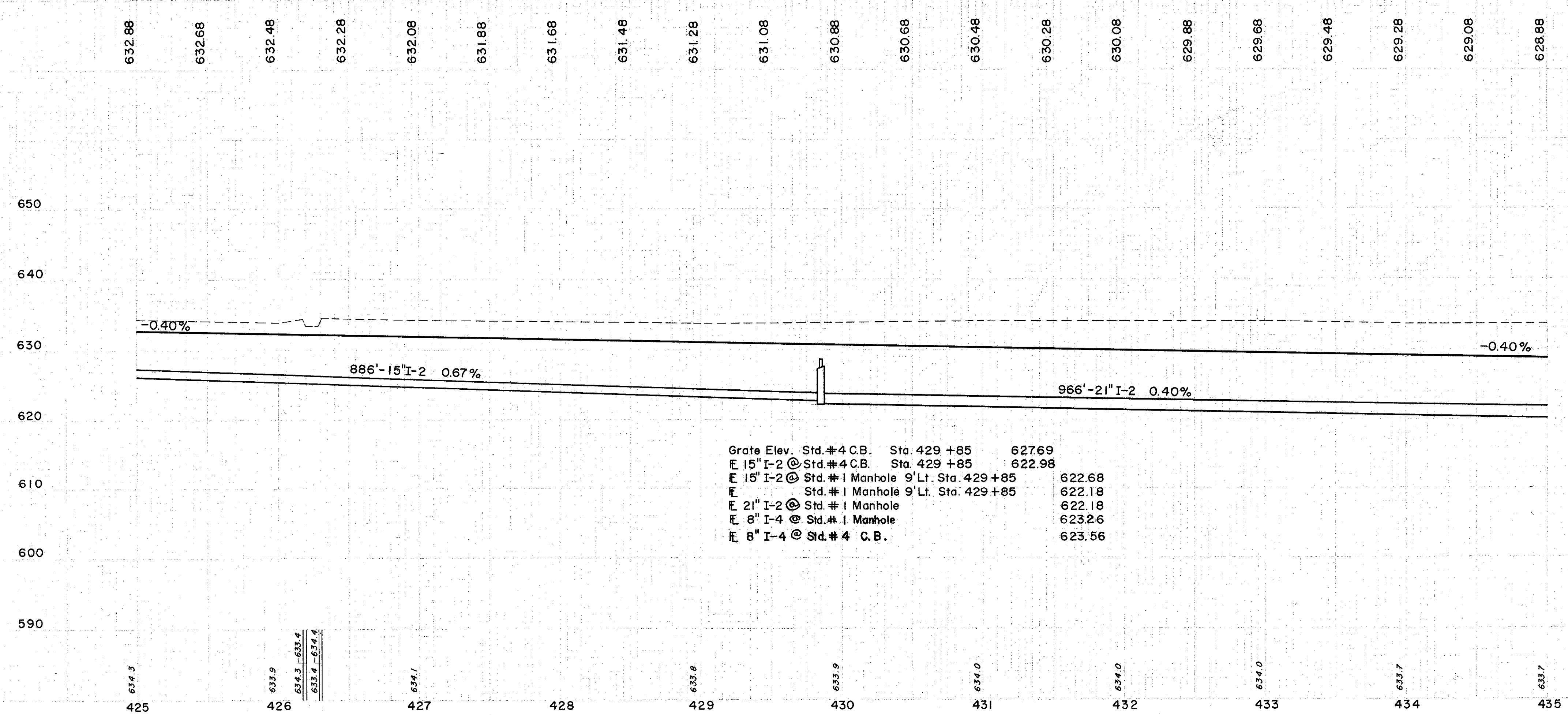

Grate Elev.	Std. #4 C.B.	Sta. 429+85	627.69
Elev.	15" I-2 @ Std. #4 C.B.	Sta. 429+85	622.98
Elev.	15" I-2 @ Std. #1 Manhole	9' Lt. Sta. 429+85	622.68
Elev.	Std. #1 Manhole	9' Lt. Sta. 429+85	622.18
Elev.	21" I-2 @ Std. #1 Manhole		622.18
Elev.	8" I-4 @ Std. #1 Manhole		623.26
Elev.	8" I-4 @ Std. #4 C.B.		623.56

(D) DRAINAGE

REF NO.	STATION	FROM	TO	6" PIPE 8" OUT-6" PIPE UNDER DRAIN DEEP		6" 60° WYE		8"X4" 10"X4" TEE		6" 60° BEND		STD.#1 M.H.		STD.#4 CATCH BASIN		CLASS "N" STORM SEWER SEC. M.G.S (2) OR M.G.S (4)		8" ROADWAY DRAIN-AGE		10" ROADWAY DRAIN-AGE		E-12 PIPE REMOVAL	
				L.F.	L.F.	L.F.	L.F.	L.F.	L.F.	L.F.	L.F.	L.F.	L.F.	L.F.	L.F.	L.F.	L.F.	L.F.	L.F.	L.F.	L.F.	L.F.	L.F.
I-D	425+00	429+58	432																				
I-D	425+00	429+54	487																				
I-D	425+00	429+77	480																				
I-D	425+00	429+70	486																				
I-D	429+62	435+00	536																				
I-D	429+58	435+00	542																				
I-D	429+81	435+00	519																				
I-D	429+74	435+00	526																				
I-D	429+87	430+25	19																				
I-D	429+85	435+00	18																				
I-D	424+80	435+00																					
I-D	425+00	429+85																					
I-D	429+85	435+00																					
I-D	432+50	432+87																					

(P) PAVEMENT

EXCAVATION	34,711	C.Y.
EMBANKMENT	0	C.Y.
PAVEMENT	20	C.Y.

(R) ROADWAY

REF NO.	STATION	FROM	TO	SIDE	COM. SUB. GRADE	AGE	UNDER	L.F.	L.F.	S.Y.
I-R	430+25	430+25	434	C	42.4					

REF NO.	STATION	FROM	TO	SIDE	NO. 6 BIT. MATL. AGGR.	NO. 46 AGGR.	C.Y.	C.Y.	C.Y.	C.Y.
I-P	430+25	430+25	434	C	201	3.5	3.5	57	71	

EXCAVATION	34,711	C.Y.
EMBANKMENT	0	C.Y.
PAVEMENT	20	C.Y.