

LAKE COUNTY  
LAK-2-7.39

FOR ACCELERATION LANE  
PAVEMENT QUANTITIES  
SEE SHEET NO. 30

FOR DISPOSITION  
SEE SHEET NO. 11

CURVE DATA  
PAVT. EDGE 54.00' LT. TO  
PAVT. EDGE 59.87' LT.  
 $\Delta = 1^\circ 57' 49''$   
 $R = 10,000'$   
 $L = 342.71'$

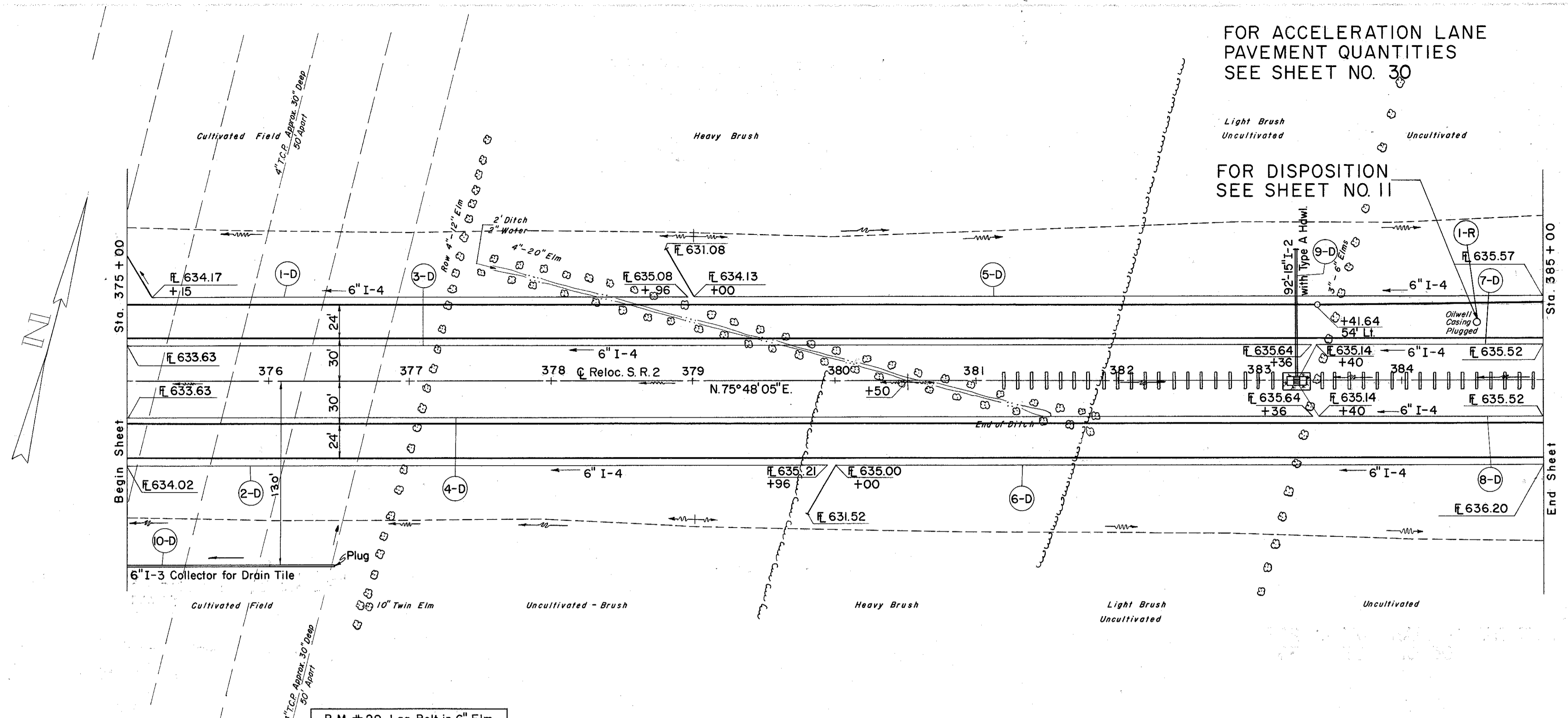

B.M. # 29 Lag Bolt in 6" Elm  
165' Rt. Sta. 376+65  
Elev. 630.983

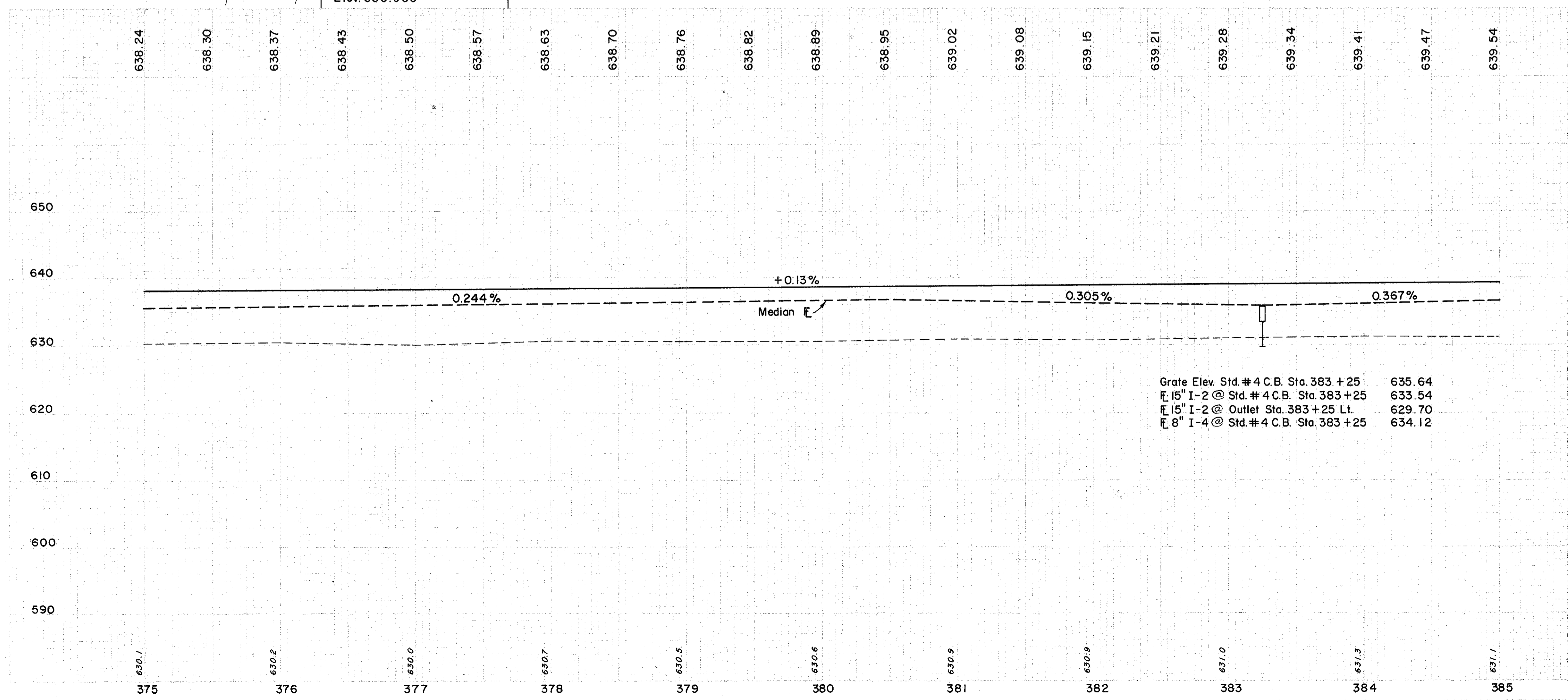

(D) DRAINAGE

REF. NO.	STATION	FROM	TO	DESCRIPTION	EA.	C.Y.	LBS.	S.Y.	CL. A	CL. B
I-4	375+15	378+96	LT.	6" PIPE UNDER DRAIN SEC. SHALLOW-6.4(a)	10					
I-4	375+00	379+96	RT.	6" PIPE UNDER DRAIN SEC. SHALLOW-6.4(a)	10					
I-4	375+00	383+36	LT.	6" PIPE UNDER DRAIN SEC. SHALLOW-6.4(a)	10					
I-4	375+00	383+36	RT.	6" PIPE UNDER DRAIN SEC. SHALLOW-6.4(a)	10					
I-4	379+00	385+00	LT.	6" PIPE UNDER DRAIN SEC. SHALLOW-6.4(a)	10					
I-4	379+00	385+00	RT.	6" PIPE UNDER DRAIN SEC. SHALLOW-6.4(a)	10					
I-4	383+40	385+00	LT.	6" PIPE UNDER DRAIN SEC. SHALLOW-6.4(a)	10					
I-4	383+40	385+00	RT.	6" PIPE UNDER DRAIN SEC. SHALLOW-6.4(a)	10					
I-4	383+25	385+00	RT.	6" PIPE UNDER DRAIN SEC. SHALLOW-6.4(a)	10					
I-4	375+00	376+47	RT.	6" PIPE UNDER DRAIN SEC. SHALLOW-6.4(a)	10					
I-5	375+00	376+47	RT.	6" x 4" BEND	EA.	3				
I-8	375+00	376+47	RT.	STD. # 4 CATCH BASIN	EA.	1	3.3	146	100.5	92
I-10	375+00	376+47	RT.	CONC. FOR SODDING	C.Y.					
I-3	375+00	376+47	RT.	ROADWAY DRAINAGE	6" L.F.					
I-2	375+00	376+47	RT.	ROADWAY DRAINAGE	6" L.F.					

(R) ROADWAY

REF. NO.	STATION	FROM	TO	DESCRIPTION	LUMP
I-R	384+53			SPECIAL Plugging Oil Well	LUMP

Excavation	183 C.Y.
Equipment	44,698 C.Y.
Equipment	20 55,638 C.Y.