

FOR CULVERT DETAILS
AND REMAINDER OF CHANNEL CHANGE
AND STRUCTURE DETAILS
SEE SHEET NO.215

Heavy Woods
2"-14" Elm, Oak & Maple

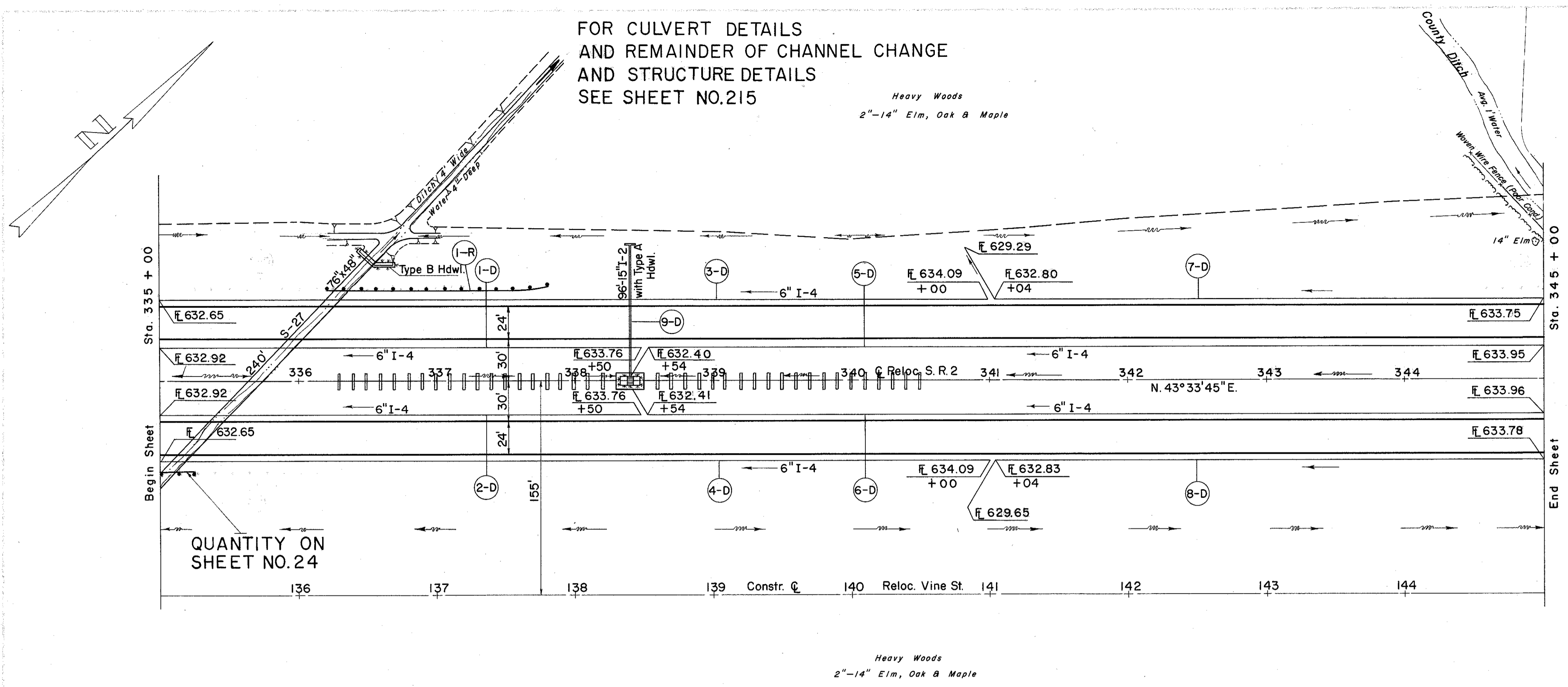

QUANTITY ON
SHEET NO.24

Heavy Woods
2"-14" Elm, Oak & Maple

B.M. # 26 Lag Bolt in base 15" Elm
100' Lt. Sta. 344+90
Elev. 630.402

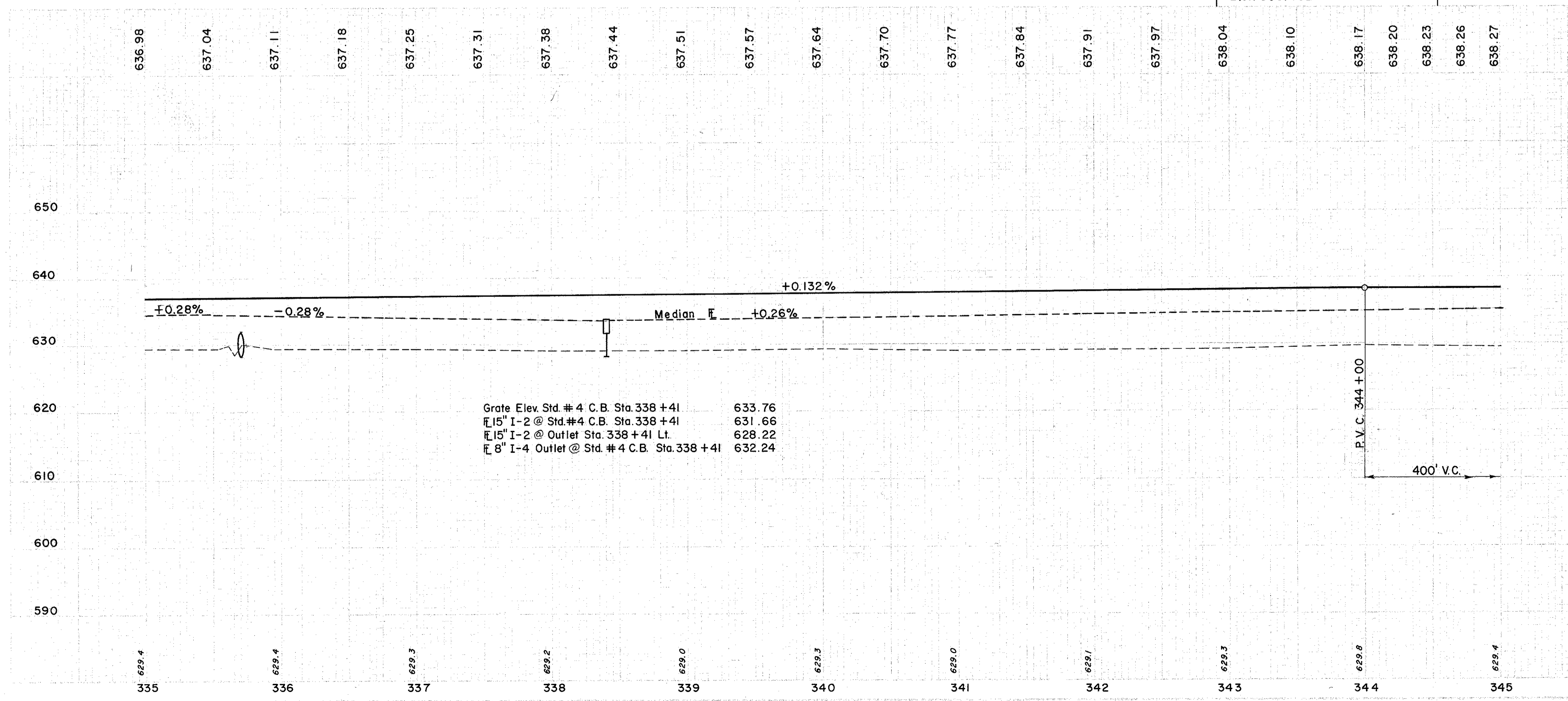

Grate Elev. Std. # 4 C.B. Sta. 338 +41 633.76
 15" I-2 @ Std. #4 C.B. Sta. 338 +41 631.66
 15" I-2 @ Outlet Sta. 338 +41 Lt. 628.22
 8" I-4 Outlet @ Std. # 4 C.B. Sta. 338 +41 632.24

(D) DRAINAGE

REF. NO.	STATION	6" PIPE UNDER-SIDE DRAIN		I-4	I-5	I-2	I-8	S-1	S-4	L-10
		SHALLOW-64(σ)	SEC							
I-D 335+00	338+50	LT	350							
2-D 335+00	338+50	RT	350							
3-D 335+00	341+00	LT	600							
4-D 335+00	341+00	RT	600							
5-D 338+54	345+00	LT	657	10						
6-D 338+54	345+00	RT	657	10						
7-D 341+04	345+00	LT	425	10						
8-D 341+04	345+00	RT	422	10						
9-D 338+41		CL			96			3.3	146	100.5

(S) STRUCTURE

REF. NO.	STATION	FROM	TO	TOTAL	S-1	S-4	L-10
I-S 335+70					39.7	17.15	11
E-2	CONC. CHANNEL FOR STRUCT. CL. C	155	498	498			
E-3	EXCAV. FOR STRUCT. CL. C	155	498	498			
S-27	76"x48" SIDE M-2066(b) SODDING	240	240	240			
					39.7	17.15	11

(R) ROADWAY

REF. NO.	STATION	FROM	TO	TOTAL
I-R 336+20		337+82	LT	162.5
				162.5

EXCAVATION	998	C.Y.
EXPANSION	45,285	C.Y.
EMPAVEMENT	20	54,342 C.Y.