

7-9

FED. RD. DIVISION	STATE	PROJECT	
2	OHIO	F - 3 29 (15)	

212
297

LAKE COUNTY
LAK-2-4.42

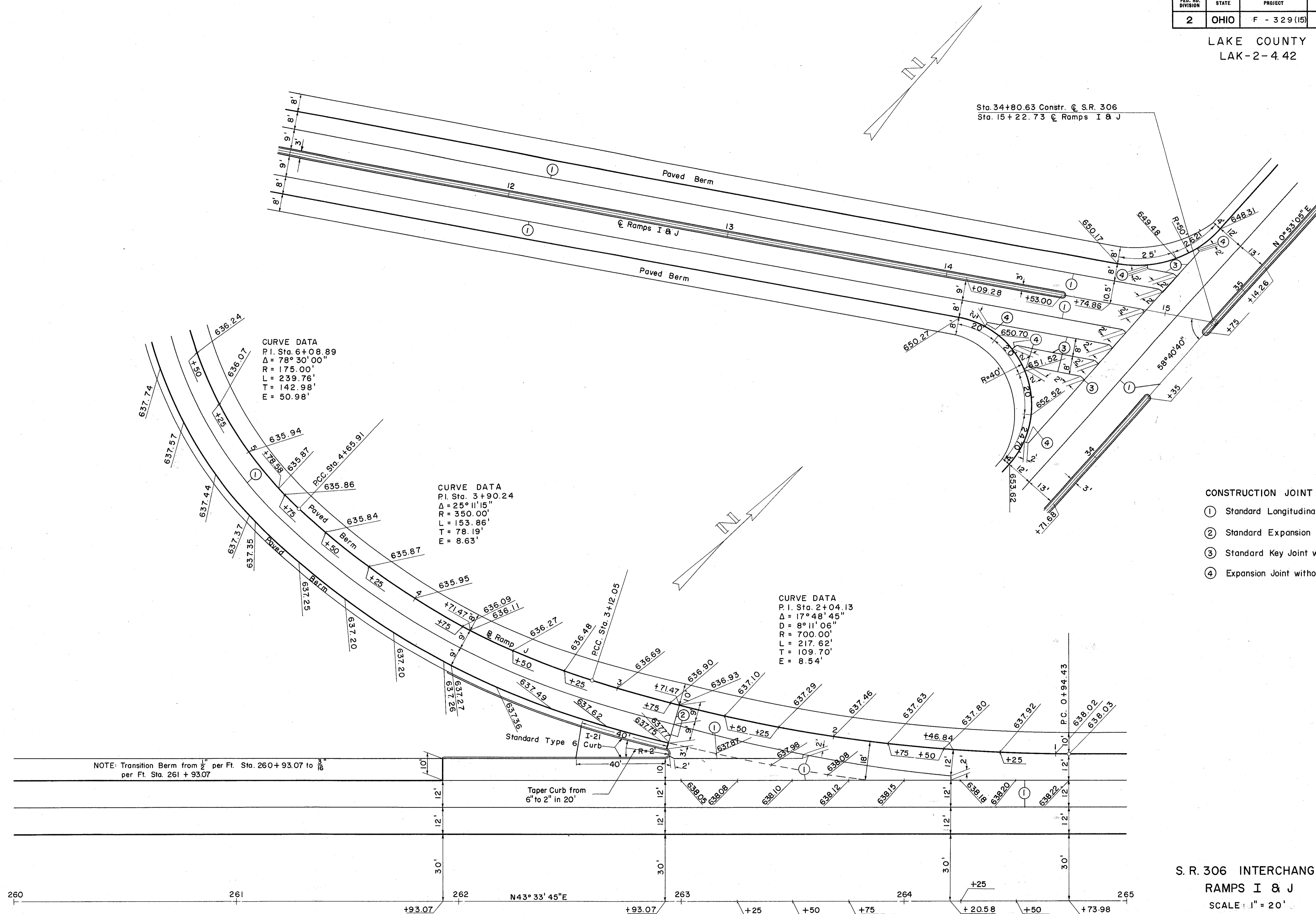

CURVE DATA
P.I. Sta. 6+08.89
 $\Delta = 78^\circ 30' 00''$
R = 175.00'
L = 239.76'
T = 142.98'
E = 50.98'

CURVE DATA
P.I. Sta. 3+90.24
 $\Delta = 25^\circ 11' 15''$
R = 350.00'
L = 153.86'
T = 78.19'
E = 8.63'

CURVE DATA
P.I. Sta. 2+04.13
 $\Delta = 17^\circ 48' 45''$
D = 8° 11' 06"
R = 700.00'
L = 217.62'
T = 109.70'
E = 8.54'

- CONSTRUCTION JOINT LEGEND
- ① Standard Longitudinal Joint
 - ② Standard Expansion Joint
 - ③ Standard Key Joint without Tie Bars
 - ④ Expansion Joint without Dowels

NOTE: Transition Berm from $\frac{1}{2}$ " per Ft. Sta. 260+93.07 to $\frac{3}{16}$ " per Ft. Sta. 261+93.07

Taper Curb from 6" to 2" in 20"

S. R. 306 INTERCHANGE
RAMPS I & J
SCALE: 1" = 20'