

75

F-10

FOR RAMP "A" DETAILS
SEE SHEET NO. 162

RAMP A CURVE DATA

FOR DETAILS OF STRUCTURE
SEE SHEET NO. 225

RAMP G CURVE DATA

A-1
P.I. Sta. 0+52.37
Δ = 8° 21' 52.9" Lt.
D = 8° 00' 00"
R = 716.20'
L = 104.56'
T = 52.37'

A-2
P.I. Sta. 1+89.00
Δ = 40° 19' 13.36" Lt.
D = 2° 00' 00"
R = 230.00'
L = 161.86'
T = 84.44'

A-3
P.I. Sta. 10+86.16
Δ = 32° 41' 52.34" Lt.
D = 2° 00' 00"
R = 2864.79'
L = 184.89'
T = 92.48'

G-1
P.I. Sta. 0+77.23
Δ = 54° 29' 07.95" Rt.
D = 2° 00' 00"
R = 150.00'
L = 142.64'
T = 77.23'

G-2
P.I. Sta. 3+61.40
Δ = 47° 15' 41.81" Rt.
D = 2° 00' 00"
R = 500.00'
L = 412.44'
T = 218.76'

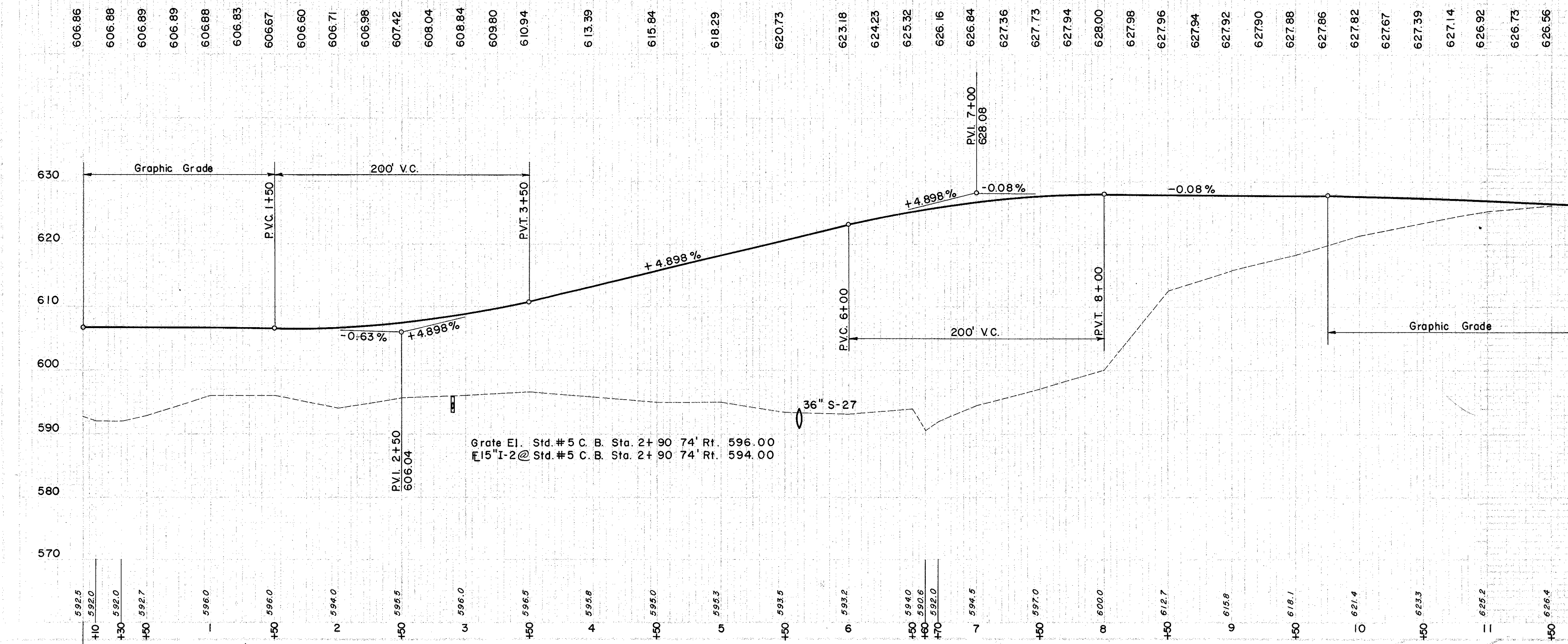
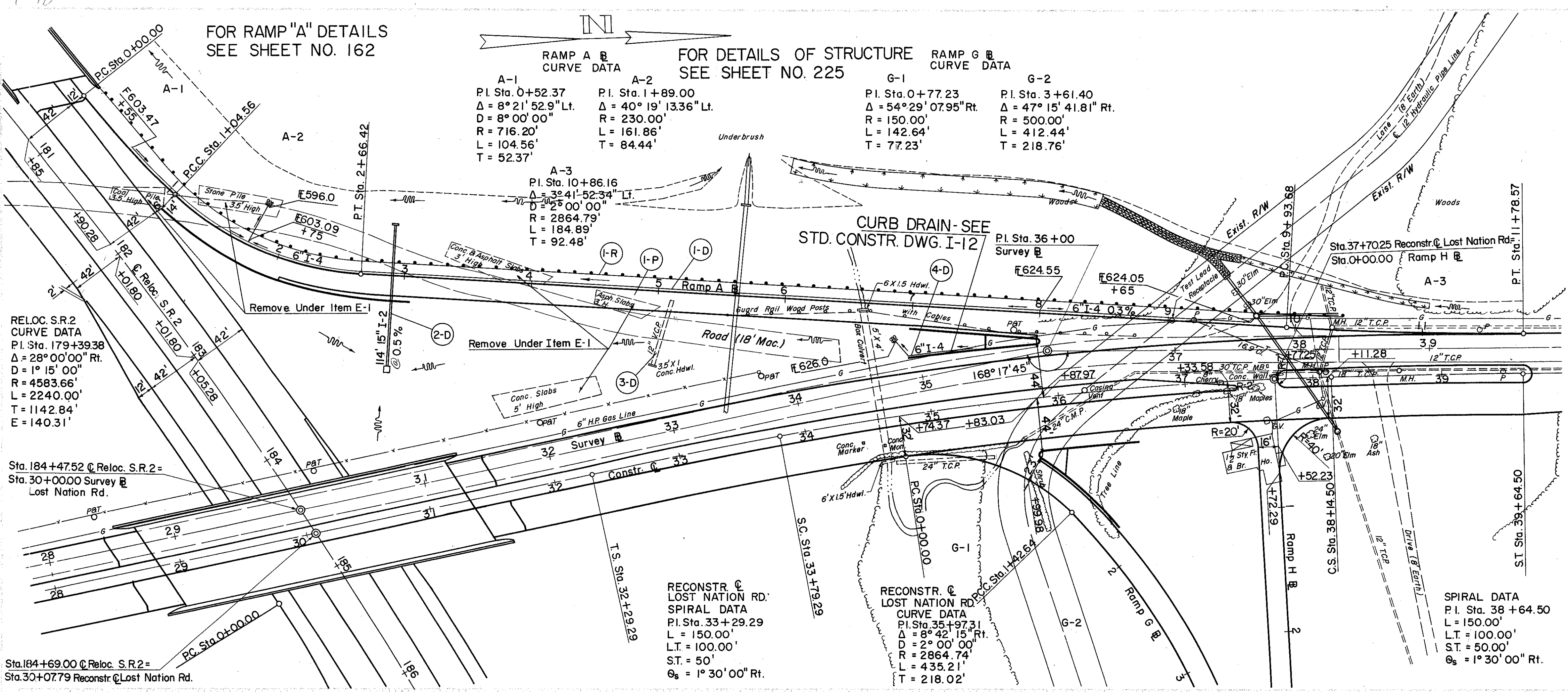

REF. NO.	STATION	DESCRIPTION	FROM	TO	TYPE	AMOUNT	UNIT
I-2	0+55	CL. STORM SEWER UNDER PAVT. SEC. OR M-6.5(b) OR M-6.8(b)	0+55	9+65	15"	114	LT.
I-4	10+40	8" OUTLET PIPE UNDER SEC. DRAIN	10+40	10+40	6"	14	LT.
I-5	6+00	6" 90° BEND	6+00	6+00	EA	1	EA
S-1	3+61	CONC. FOR STRUCT. CL. "E"	3+61	3+61	C.Y.	0.26	C.Y.
S-29	10+40	DRAINAGE OF STRUCT. NO. 2 AGGR.	10+40	10+40	C.Y.	0.3	C.Y.
I-12	3+61	STD. MOD. SP. CONC. CURB	3+61	3+61	L.F.	5.6	L.F.
E-12	3+61	REMOVAL OF PIPE 15" & UNDER	3+61	3+61	L.F.	5.6	L.F.
S-24	3+61	REMOVAL OF EXISTING STRUCT.	3+61	3+61	LUMP	1	LUMP
E-2	3+61	EXC. FOR STRUCT.	3+61	3+61	C.Y.	1	C.Y.

(R) ROADWAY

REF. NO.	STATION	DESCRIPTION	FROM	TO	TYPE	AMOUNT	UNIT
I-15	0+00	GUARD RAIL STEEL BEAM TYPE (DEEP) #2A	0+00	10+40	LT.	1037.5	LT.

(P) PAVEMENT

REF. NO.	STATION	DESCRIPTION	FROM	TO	TYPE	AMOUNT	UNIT
I-71	0+00	10" CONC. BASE COURSE	0+00	821	C.Y.	599	C.Y.
I-18	11+78.57	3" BIT. CRUSHED AGGR. SHLDS. & APPR.	11+78.57	2043	C.Y.	152	C.Y.
I-12	11+78.57	STD. MOD. SP. CONC. CURB	11+78.57	206	L.F.	206	L.F.
I-12	11+78.57	SPECIAL MOD. SP. CONC. CURB	11+78.57	53	L.F.	53	L.F.
I-21	11+78.57	CONC. MEDIAN TYPE I	11+78.57	31	GAL.	410	GAL.
T-31	11+78.57	BIT. MATL. AGGR.	11+78.57	66	C.Y.	66	C.Y.
T-31	11+78.57	NO. 6 AGR. SUBGR.	11+78.57	46	C.Y.	46	C.Y.
E-1	11+78.57	COMP. SUBGR.	11+78.57	6.6	S.Y.	2863	S.Y.

179	C.Y.
20952	C.Y.
25,142	C.Y.