

o:\project\cv000048a001\drawing\lak\13486\bridge\lak002_sheets\02_0542CSH002.dgn 6/24/2008 5:04:04 PM troxberry

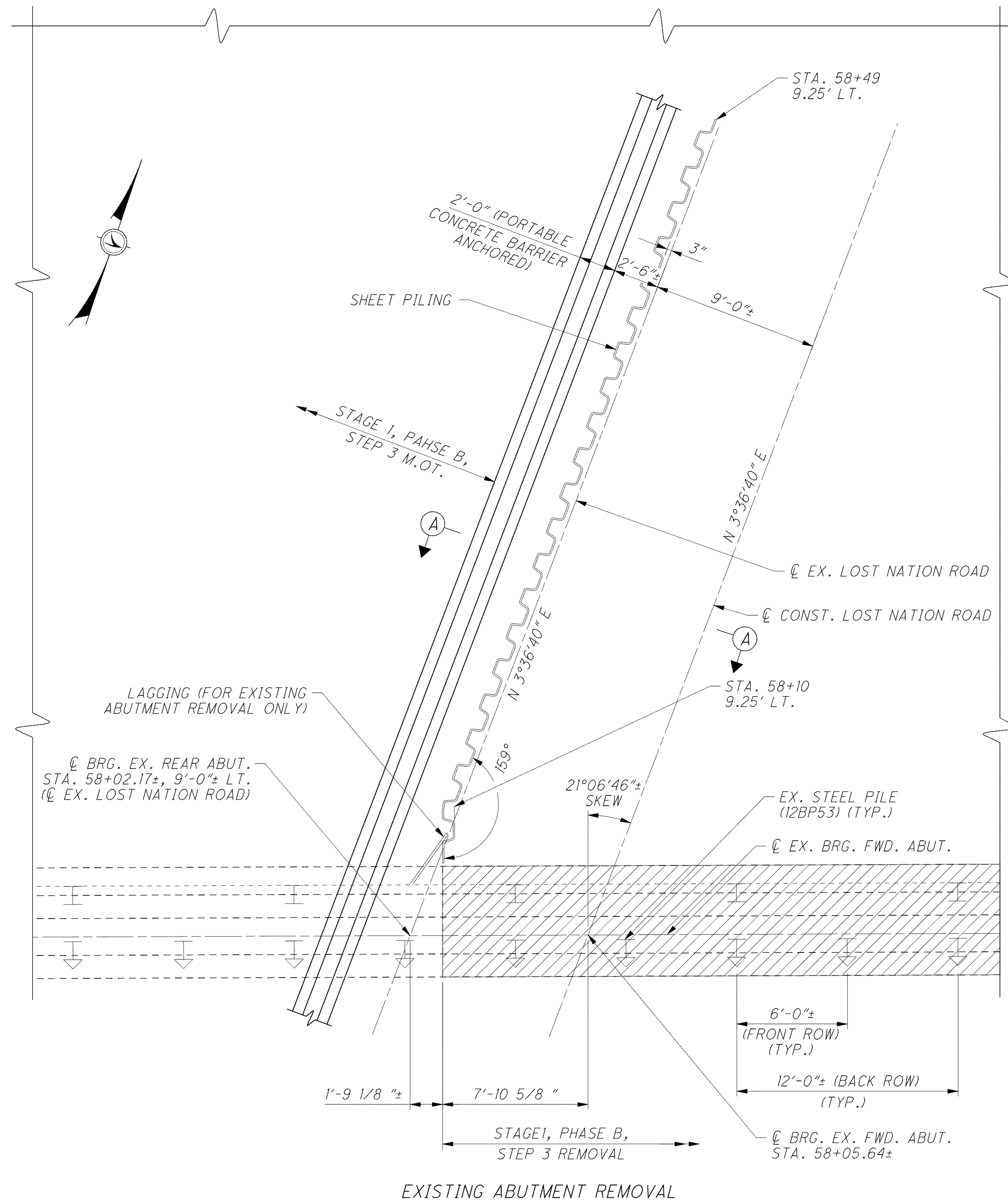

NOTES

1. FOR REMOVAL DETAILS, SEE SHEETS 13/47 AND 14/47 .
2. FOR FORWARD ABUTMENT DETAILS, SEE SHEETS 23/47 , 24/47 AND 25/47 .
3. FOR MSE WALL DETAILS, SEE SHEETS 17/47 , 18/47 AND 19/47 .
4. FOR PILE PLAN, SEE SHEET 20/47 .
5. FOR SEQUENCE OF CONSTRUCTION NOTE, SECTION A-A AND SECTION B-B, SEE SHEET 11/47 .
6. ALL STATIONS AND OFFSETS ARE FROM CENTERLINE CONSTRUCTION LOST NATION ROAD.
7. STEEL SHEET PILING SHALL HAVE A MINIMUM SECTION MODULUS OF 45 IN³ PER FOOT OF WALL FOR ALL LOCATIONS.
8. FOR LIST OF ABBREVIATIONS, SEE SHEET 3/47 .

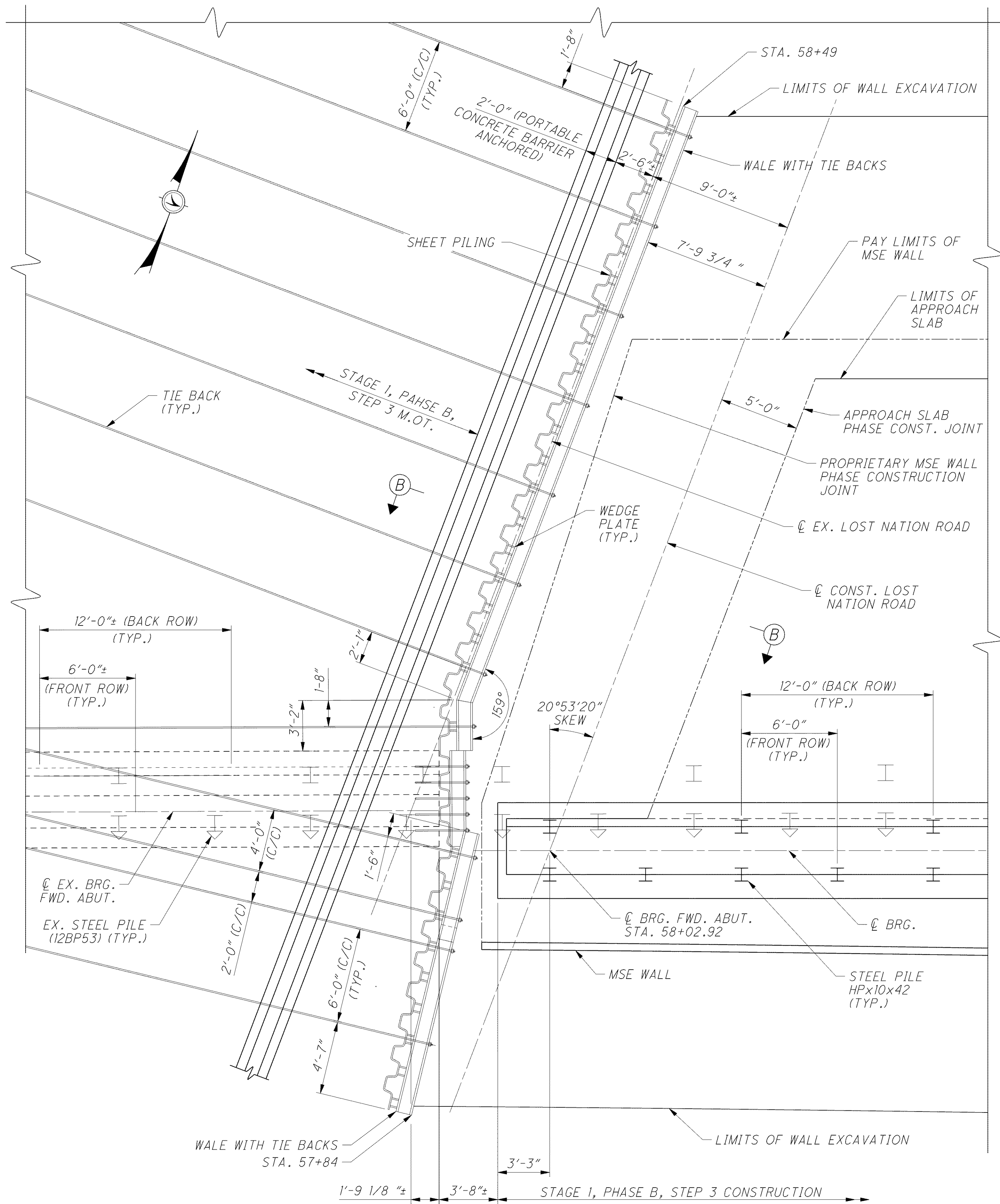

SHEET PILING CONSTRUCTION STAGE 1, PHASE B, STEP 3 CONSTRUCTION (PROPOSED ABUTMENT CONSTRUCTION)

<p>ARCADIS <small>ARCADIS U.S., Inc. 100 Superior Avenue, Suite 1250 Cleveland, Ohio 44114 Tel: 216-781-6177 Fax: 216-781-6245 www.arcadis-us.com</small></p>	<p>DATE 4/07</p>	<p>REVIEWED CMD</p>	<p>STRUCTURE FILE NUMBER 4500823</p>	<p>DESIGNED RBB</p>	<p>CHECKED SKS</p>	<p>DRAWN MPB</p>	<p>REVISED</p>
<p>TEMPORARY SHORING DETAILS - FORWARD ABUTMENT BRIDGE NO. LAK-2-0542 LOST NATION ROAD OVER STATE ROUTE 2</p>							
<p>LAK-2-3.32</p>							
<p>PID 13486</p>							
<p>10 / 47</p>							
<p>1556 1679</p>							