

C:\Project\CV000048A001\Drawing\LAK\13486\bridge\LAK002_0530P\001.dgn 6/26/2008 9:10:52 AM troxberry

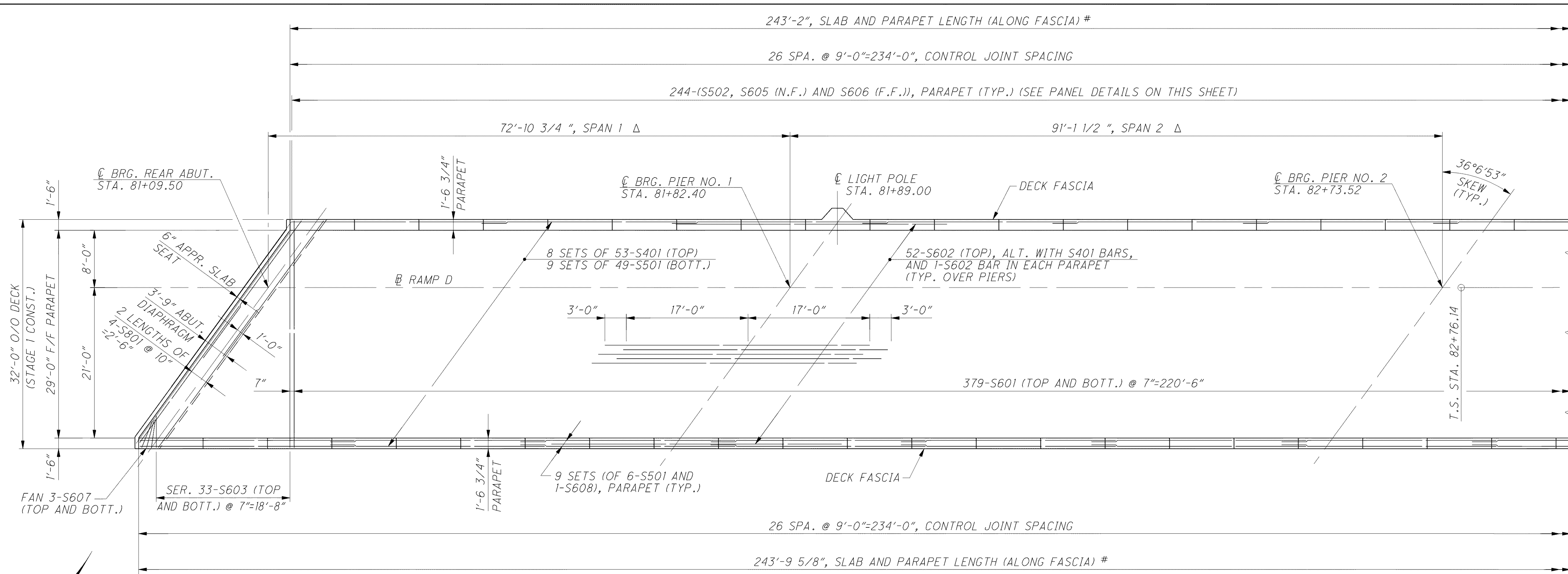

SLAB PLAN

NOTES

1. MINIMUM BAR LAPS:
 #4 BARS = 31" #5 BARS = 41"
 #6 BARS = 46" #8 BARS = 87"
2. FOR CENTERLINE SCHEMATIC DETAILS SEE SHEET 3 | 28 .
3. FOR LEGEND OF ABBREVIATIONS SEE SHEET 3 | 28 .
4. FOR TRANSVERSE SECTION AND PARAPET PANEL DETAILS SEE SHEET 20 | 28 .
5. FOR SEMI-INTEGRAL ABUTMENT DIAPHRAGM DETAILS, SEE SHEETS 17 | 28 THRU 18 | 28 .
6. FOR SCREED TABLES SEE SHEET 23 | 28 .
7. FOR FRAMING DETAILS AND NOTES SEE SHEETS 15 | 28 AND 16 | 28 .
8. TRANSVERSE CONSTRUCTION JOINTS SHALL NOT BE PERMITTED IN THE DECK SLAB.

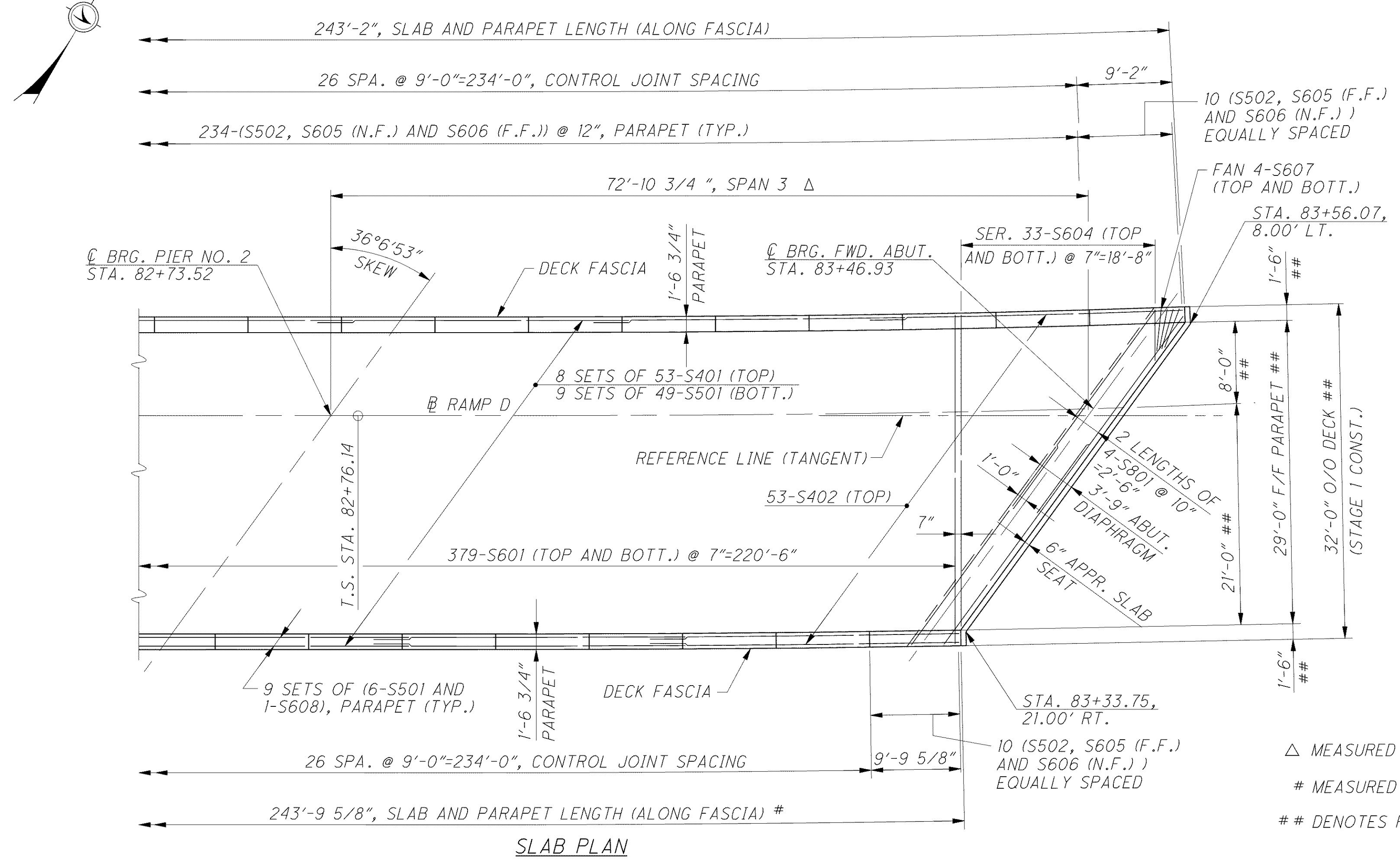

SLAB PLAN

LEGEND

- △ MEASURED ALONG REFERENCE LINE
- # MEASURED ALONG CURVE
- ## DENOTES RADIAL DIMENSION

DESIGN AGENCY ARCADIS ARCADIS U.S., Inc. 100 Superior Avenue, Suite 1250 Cleveland, Ohio 44114 Tel: 216-781-6177 Fax: 216-781-6243 www.arcadis-us.com	DATE	12/07	
	REVIEWED	RBB	
DESIGNED	FJG	CHECKED	MVD
DRAWN	CAF	REVISED	
STRUCTURE FILE NUMBER	4300750		

BRIDGE NO. LAK-2-0530 EN
RAMP D OVER CHAGRIN RIVER

LAK-2-3.32
PID 13486

21 / 28

1539
1679