

C:\Project\CV000048A001\Drawing\LAK\13486\bridge\LAK002\_0530L\_sheets\002\_0530CAF004.dgn 6/24/2008 5:05:53 PM mbechter

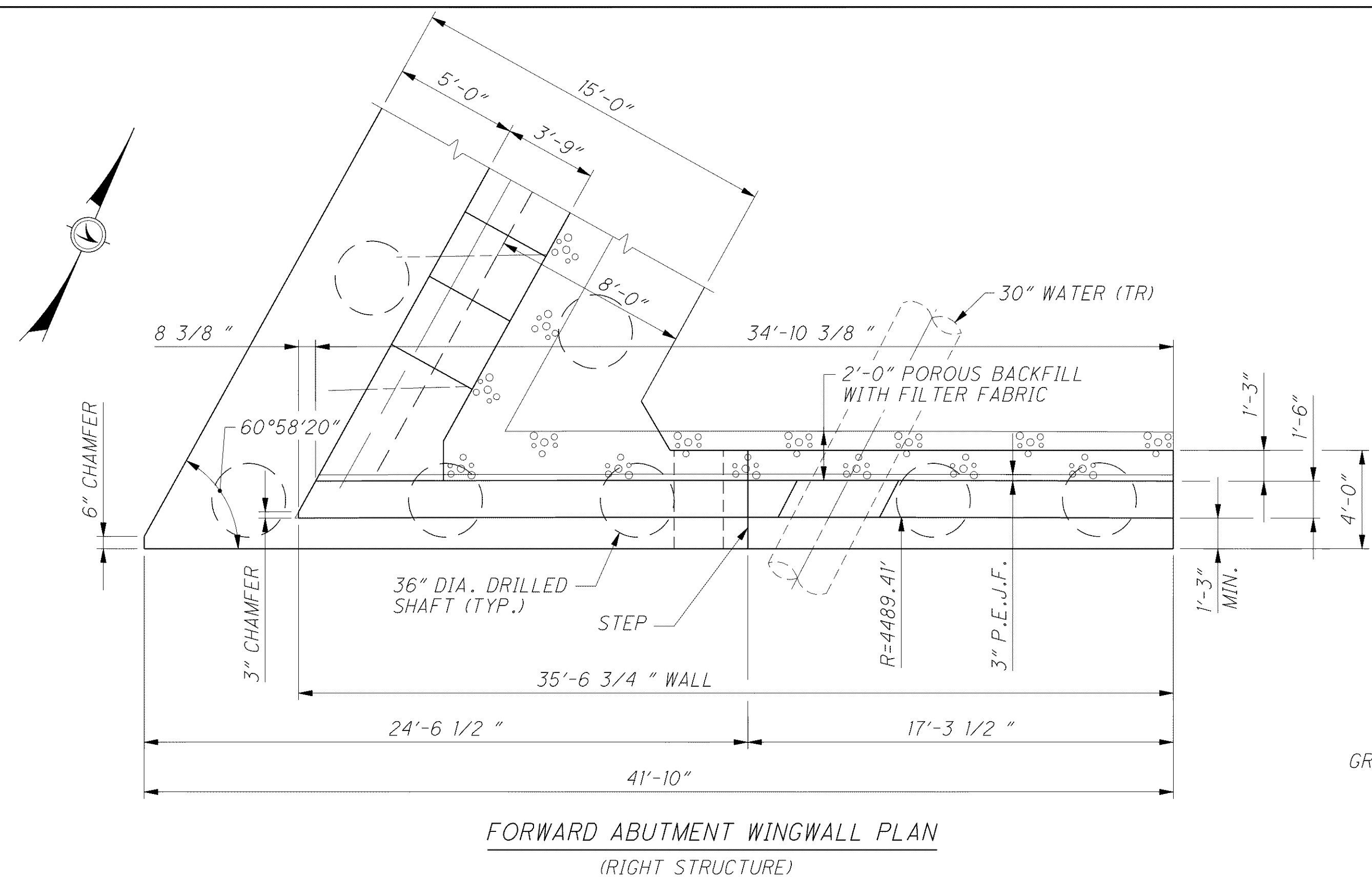

FORWARD ABUTMENT WINGWALL PLAN  
(RIGHT STRUCTURE)

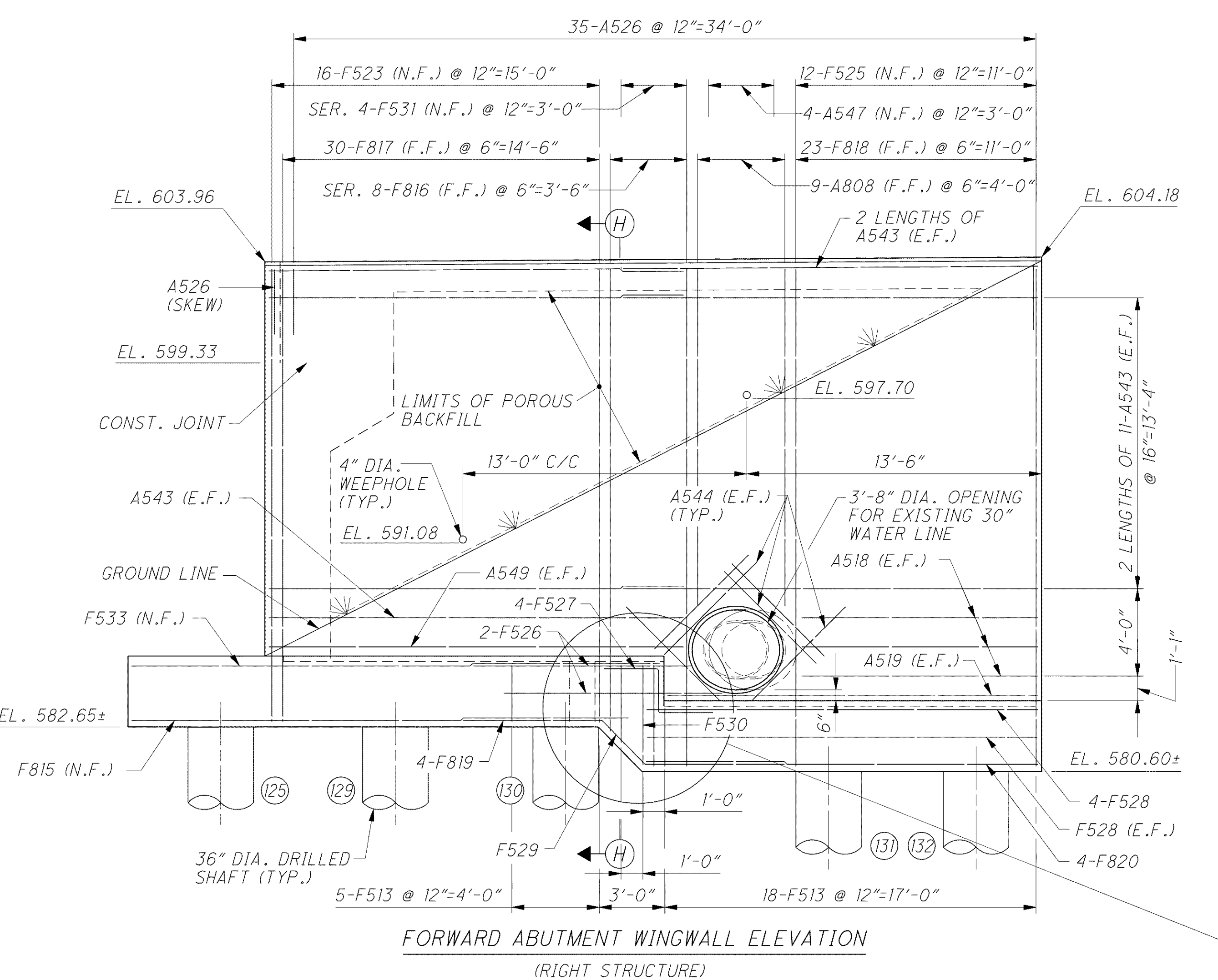

FORWARD ABUTMENT WINGWALL ELEVATION  
(RIGHT STRUCTURE)

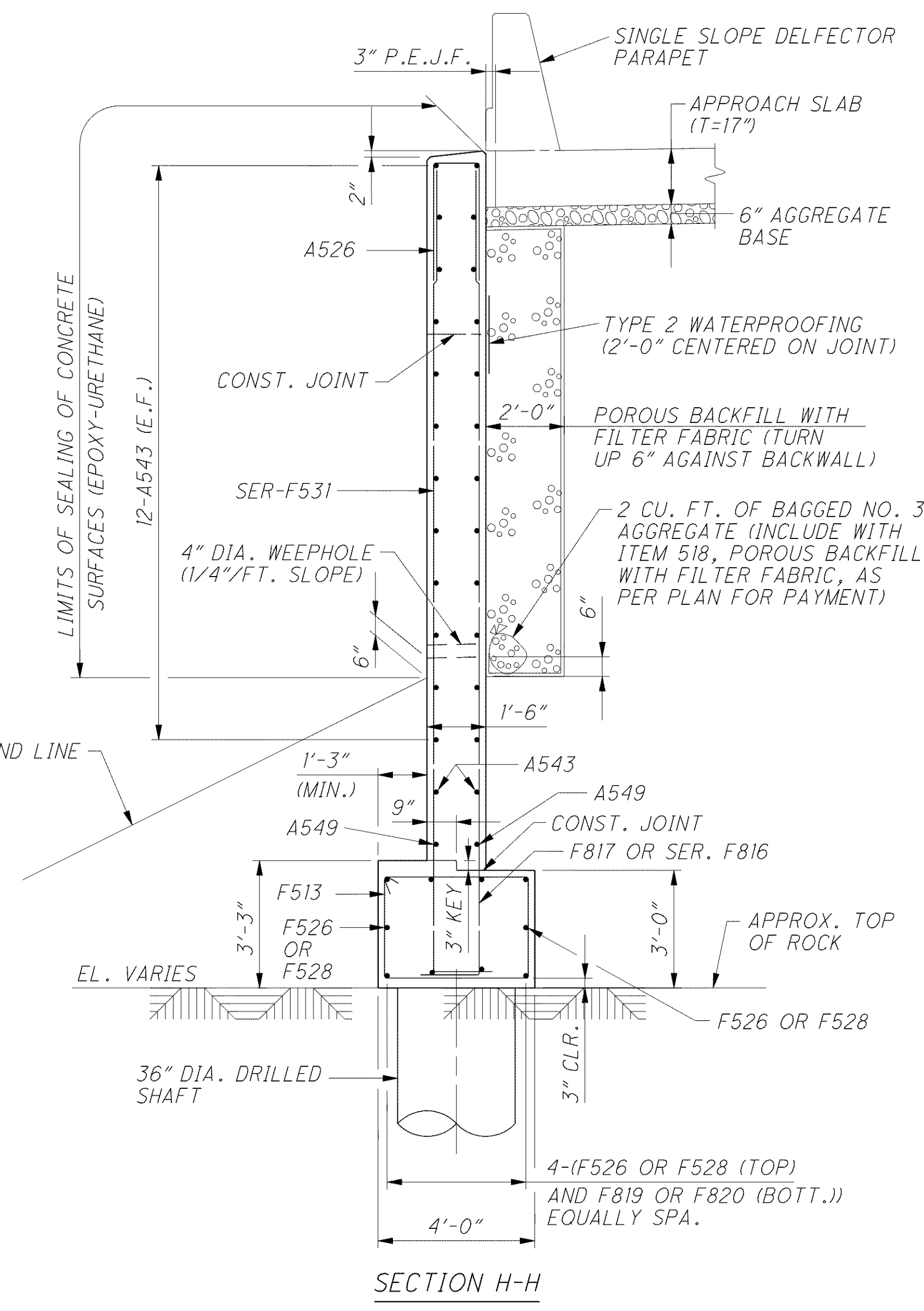

SECTION H-H

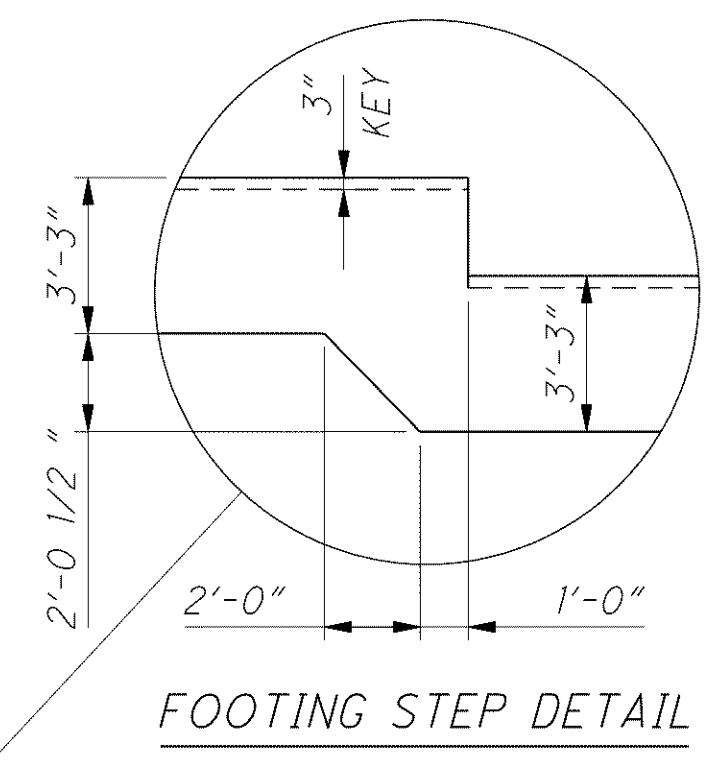

FOOTING STEP DETAIL

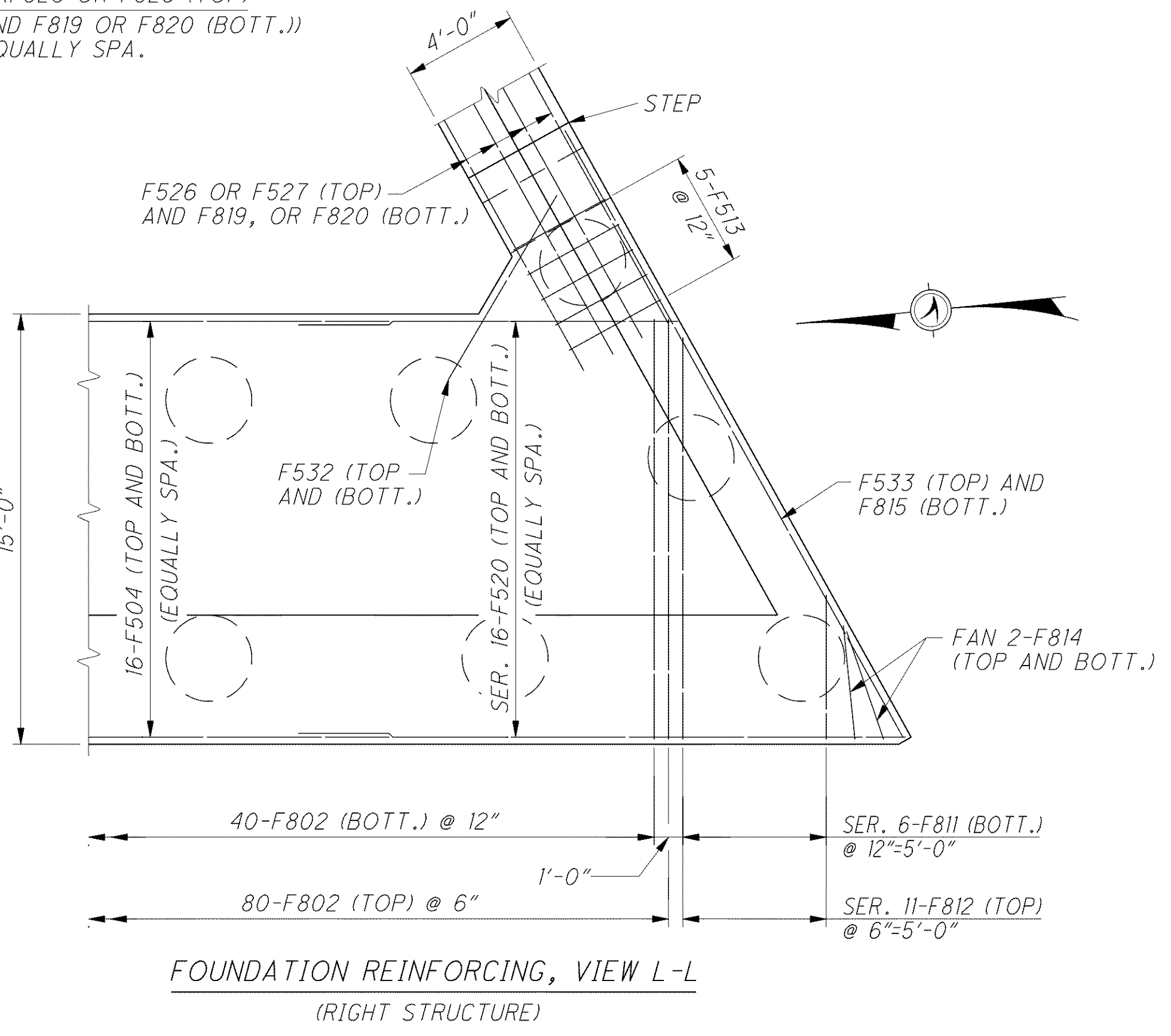

FOUNDATION REINFORCING, VIEW L-L  
(RIGHT STRUCTURE)

NOTES

1. MINIMUM BAR LAPS ARE AS FOLLOWS:  
#5 BARS = 38" #8 BARS = 87"
2. POROUS BACKFILL WITH FILTER FABRIC, TWO (2) FEET THICK (MIN.) SHALL EXTEND UP TO THE PLANE OF THE SUBGRADE, TO ONE (1) FOOT BELOW THE EMBANKMENT SURFACE OR TO THE BOTTOM OF THE APPROACH SLAB, AND LATERALLY TO THE ENDS OF THE WINGWALLS. PLACE TWO CUBIC FEET OF BAGGED NO. 3 AGGREGATE AT EACH WEEPHOLE. FILTER FABRIC SHALL CONFORM WITH 712.09, TYPE A. BAGGED AGGREGATE AND FILTER FABRIC IS INCLUDED WITH POROUS BACKFILL FOR PAYMENT.
3. PROVIDE A 1" CHAMFER ON THE EDGE OF ALL EXPOSED CONCRETE.
4. FOR REAR ABUTMENT DIAPHRAGM AND ADDITIONAL SUPERSTRUCTURE DETAILS SEE SHEETS [37 | 56] AND [38 | 56].
5. FOR REAR ABUTMENT PLAN AND ELEVATION SEE SHEETS [21 | 56] AND [20 | 56].
6. FOR FOUNDATION DETAILS SEE SHEET [15 | 56].
7. WINGWALL AND ABUTMENT CONCRETE ABOVE THE BEAM SEAT SHALL NOT BE PLACED UNTIL AFTER THE DECK SLAB AND ABUTMENT DIAPHRAGM HAVE BEEN PLACED AND PROPERLY CURED.
8. FOR LEGEND OF ABBREVIATIONS SEE SHEET [4 | 56].