

LEFT CORNER DETAIL

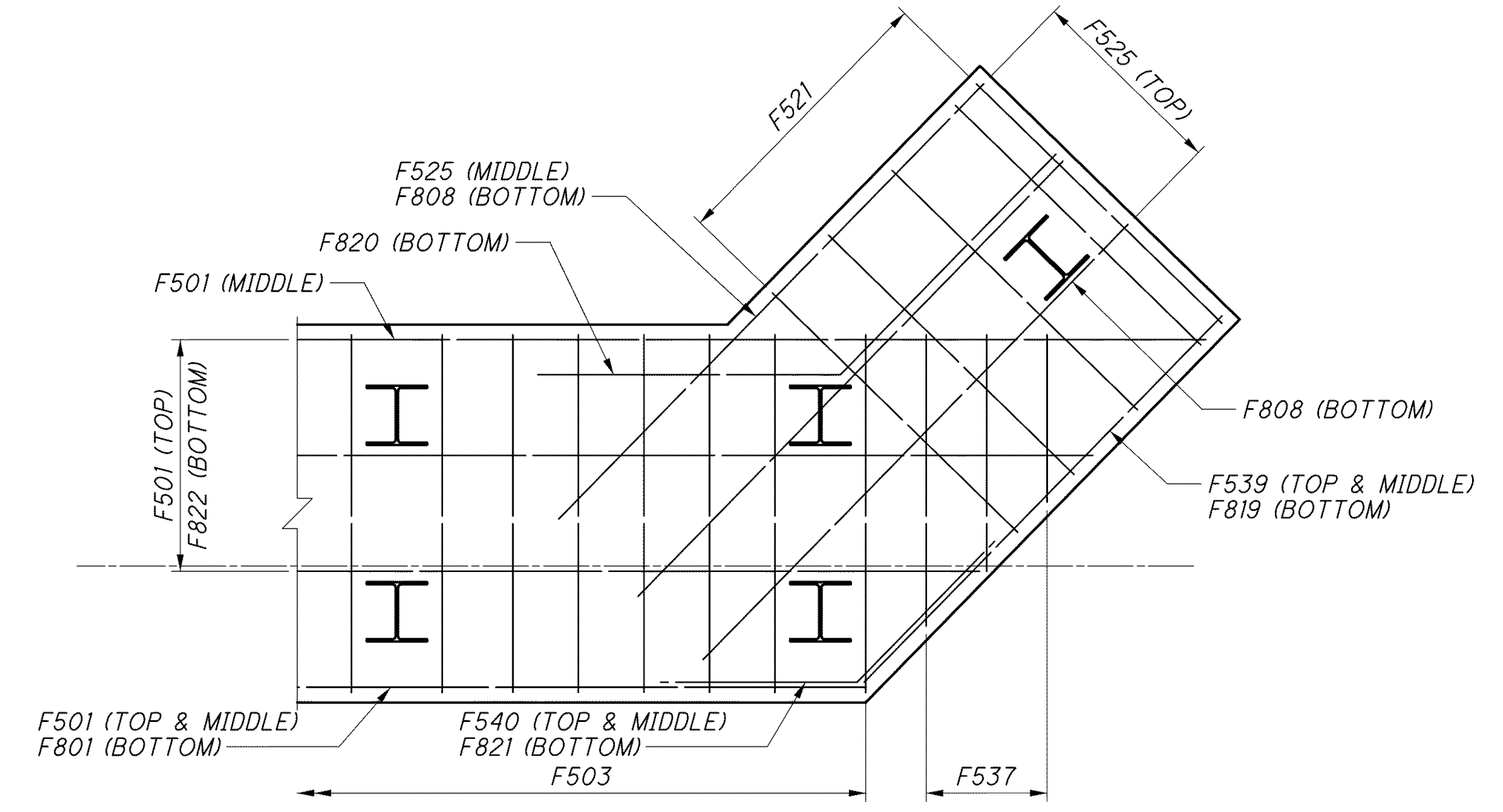

RIGHT CORNER DETAIL

PARTIAL FORWARD ABUTMENT FOOTING PLANS

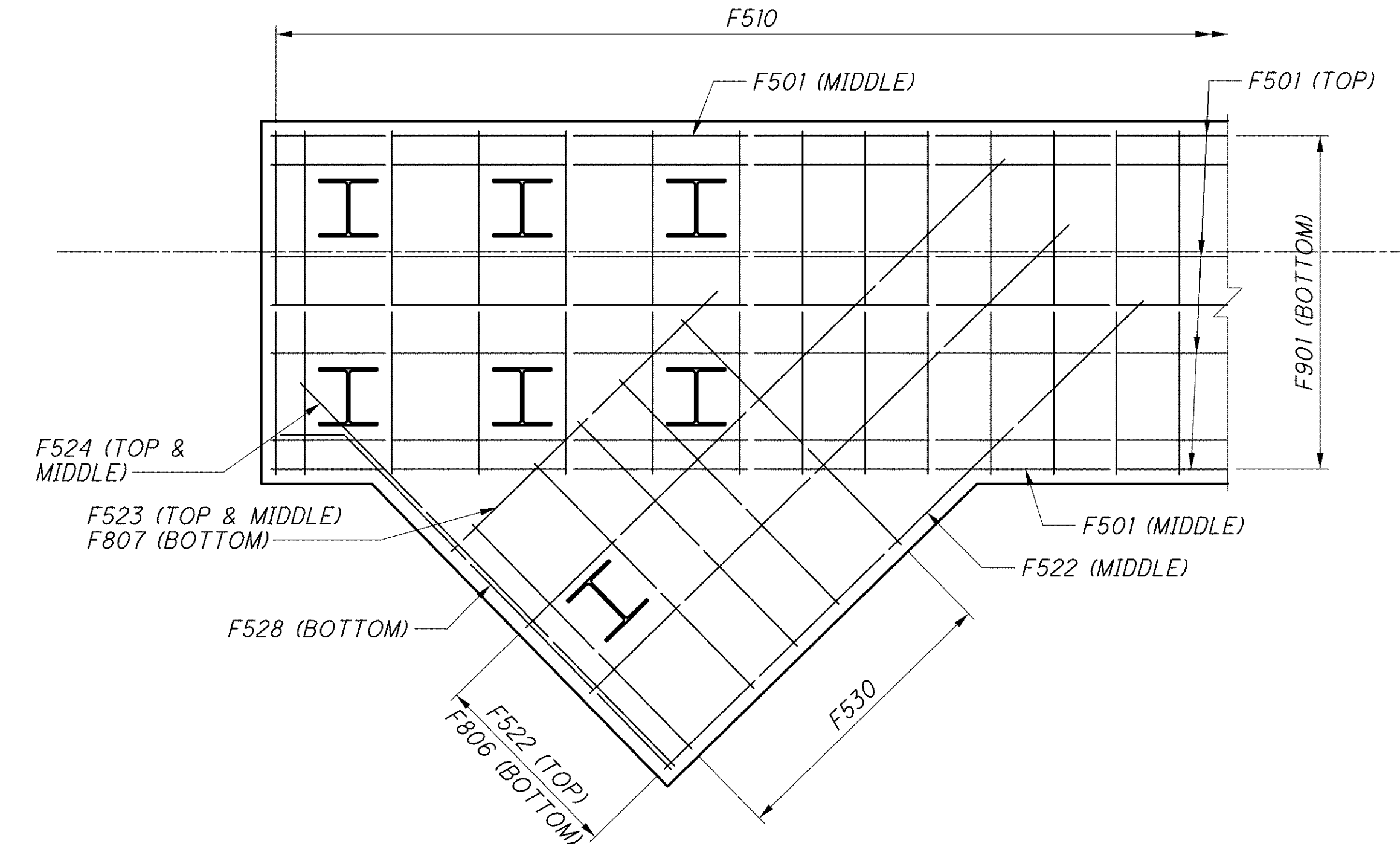

LEFT CORNER DETAIL

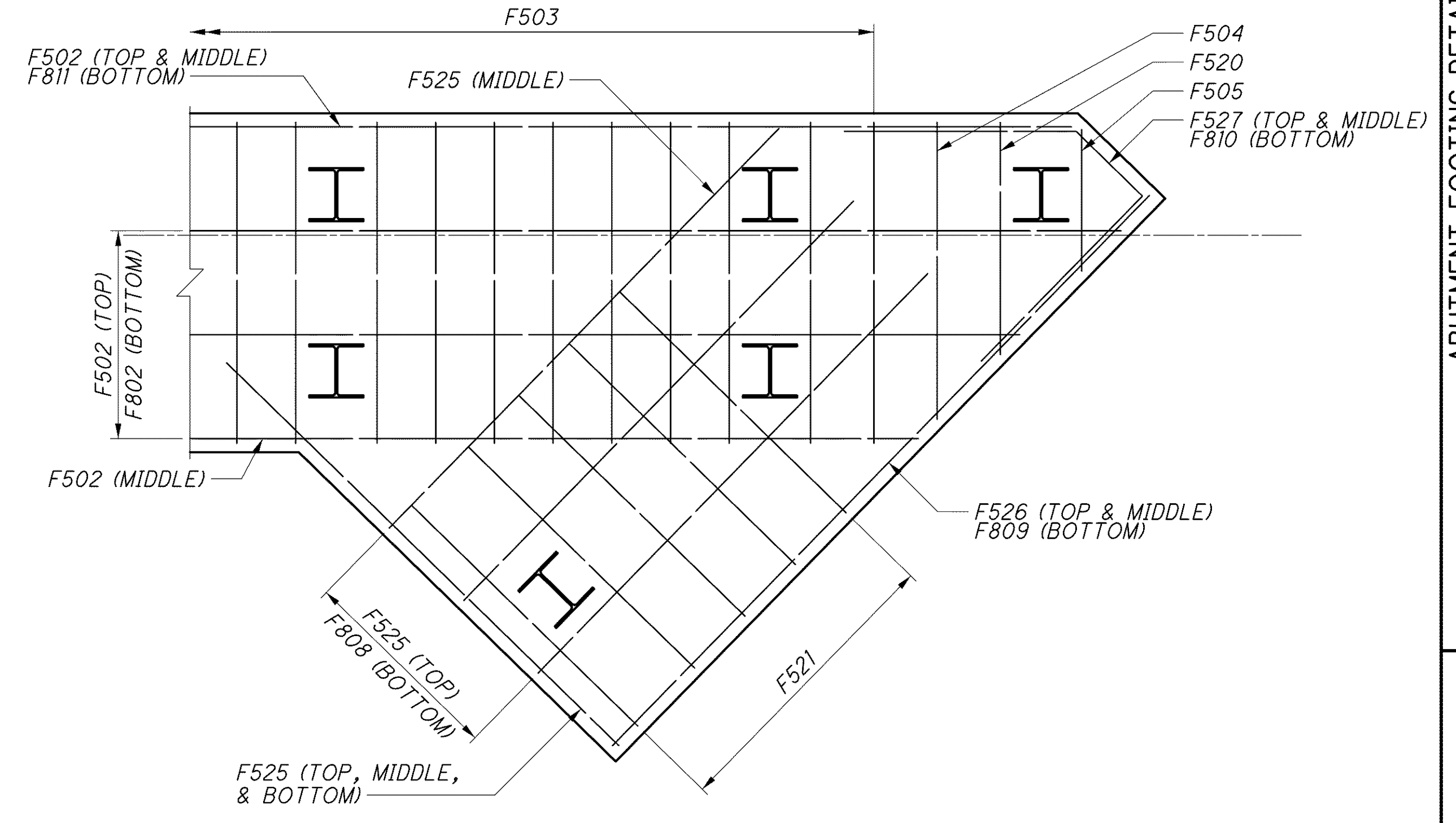

RIGHT CORNER DETAIL

PARTIAL REAR ABUTMENT FOOTING PLANS

- NOTES**
1. FOR A LIST OF ABBREVIATIONS, SEE SHEET 4/67.
  2. FOR ADDITIONAL ABUTMENT FOOTING REINFORCING DETAILS, SEE SHEETS 18/67 THRU 28/67.

j:\LAK\13486\bridge\LAK002\_0400C\sheets\002\_0400CAR007.dgn 03-JUL-2008 1:43PM lintn

		DESIGN AGENCY <b>PARSONS BRINCKERHOFF          QUADE &amp; DOUGLAS, INC.</b> 614 W. SUPERIOR AVE., SUITE 400 CLEVELAND, OHIO 44113	
DESIGNED	BMG	CHECKED	PWP
DRAWN	NAL	REVISED	
REVIEWED	RJO	STRUCTURE FILE NUMBER	4300572(L) 4300602(R)
DATE	6-19-08		
<b>ABUTMENT FOOTING DETAILS</b> BRIDGE NO. LAK-2-0400 L&R STATE ROUTE 2 OVER VINE STREET			
<b>LAK-2-3.32</b>		<b>PID No. 13486</b>	
29/67		1354 1679	