

0 50 100  
 25  
 HORIZONTAL  
 SCALE IN FEET

CALCULATED  
 JMS  
 CHECKED  
 ZFB

**LIGHTING PLAN**  
**STA. 267+50 TO STA. 280+00**

**LAK-2-3.32**

1240  
 1679

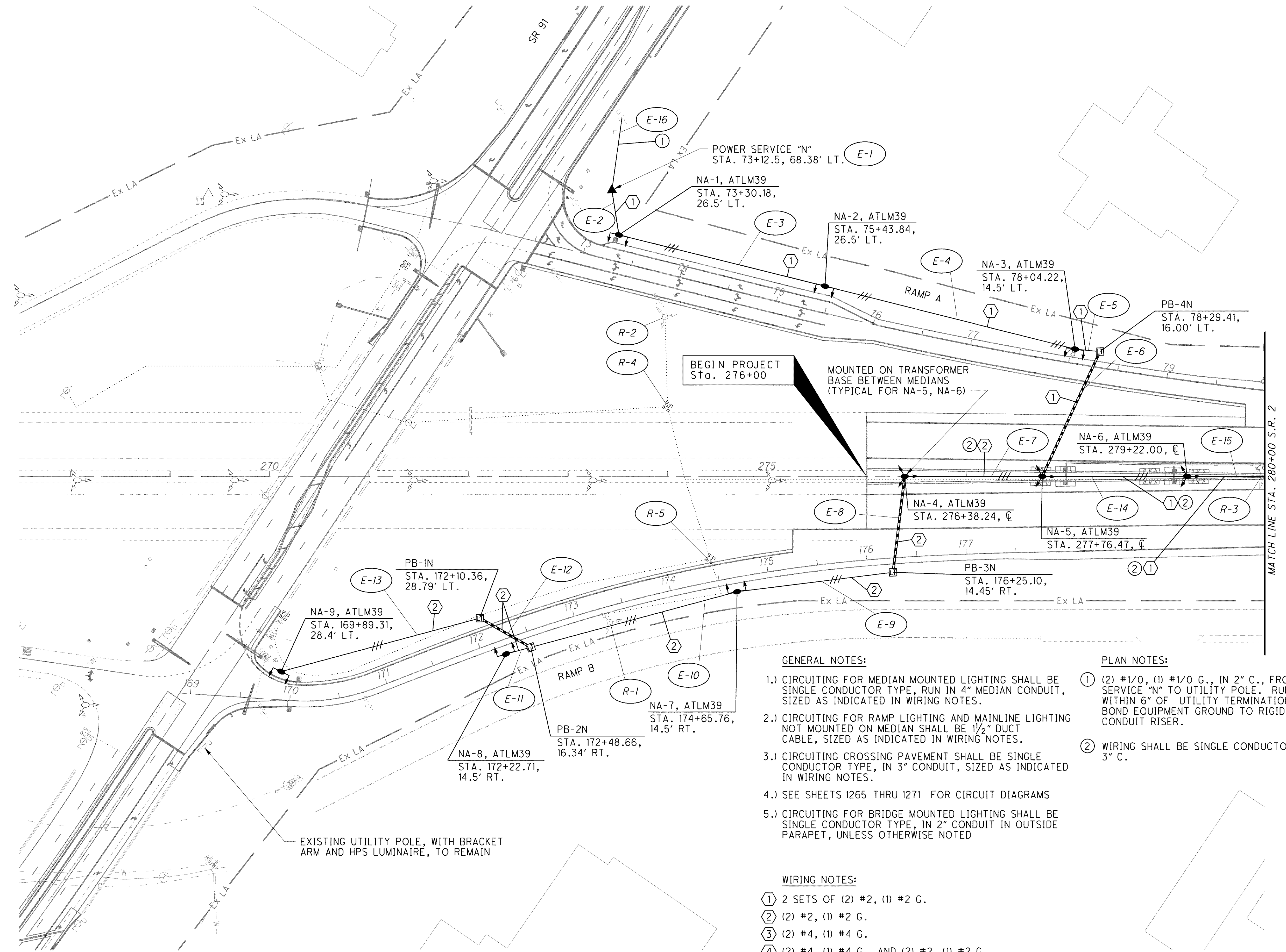

**BEGIN PROJECT**  
 Sta. 276+00

**MOUNTED ON TRANSFORMER**  
**BASE BETWEEN MEDIANS**  
 (TYPICAL FOR NA-5, NA-6)

**GENERAL NOTES:**

- 1.) CIRCUITING FOR MEDIAN MOUNTED LIGHTING SHALL BE SINGLE CONDUCTOR TYPE, RUN IN 4" MEDIAN CONDUIT, SIZED AS INDICATED IN WIRING NOTES.
- 2.) CIRCUITING FOR RAMP LIGHTING AND MAINLINE LIGHTING NOT MOUNTED ON MEDIAN SHALL BE 1 1/2" DUCT CABLE, SIZED AS INDICATED IN WIRING NOTES.
- 3.) CIRCUITING CROSSING PAVEMENT SHALL BE SINGLE CONDUCTOR TYPE, IN 3" CONDUIT, SIZED AS INDICATED IN WIRING NOTES.
- 4.) SEE SHEETS 1265 THRU 1271 FOR CIRCUIT DIAGRAMS
- 5.) CIRCUITING FOR BRIDGE MOUNTED LIGHTING SHALL BE SINGLE CONDUCTOR TYPE, IN 2" CONDUIT IN OUTSIDE PARAPET, UNLESS OTHERWISE NOTED

**PLAN NOTES:**

- ① (2) #1/0, (1) #1/0 G., IN 2" C., FROM POWER SERVICE "N" TO UTILITY POLE. RUN UP POLE, TO WITHIN 6" OF UTILITY TERMINATION POINT. BOND EQUIPMENT GROUND TO RIGID METALLIC CONDUIT RISER.
- ② WIRING SHALL BE SINGLE CONDUCTOR TYPE, IN 3" C.

**WIRING NOTES:**

- ① 2 SETS OF (2) #2, (1) #2 G.
- ② (2) #2, (1) #2 G.
- ③ (2) #4, (1) #4 G.
- ④ (2) #4, (1) #4 G., AND (2) #2, (1) #2 G.
- ⑤ 2 SETS OF (2) #4, (1) #4 G.
- ⑥ 2 SETS OF (2) #4, (1) #4 G., AND (2) #2, (1) #2 G.

EXISTING UTILITY POLE, WITH BRACKET ARM AND HPS LUMINAIRE, TO REMAIN

g:\project\lak\13486\lighting\sheets\13486LP001.dgn 7/11/2008 8:47:16 AM dshaner