

NOTES:

- 1) ALL SYSTEM LOOPS ARE TO BE 6'x6' DIAMOND CONFIGURATION, TO BE CENTERED IN THE LANE AND ARE LOCATED AT THE SAME STATION AS THE ADJACENT PULLBOX.
- 2) TIME SPACE DIAGRAM AND EXISTING INTERCONNECT PLANS CAN BE FOUND AT THE ODOT DISTRICT 12 OFFICES DATED 8/92, TITLED LAK-LOST NATION ROAD.
- 3) THE CONTRACTOR SHALL SPLICE INTO THE EXISTING INTERCONNECT CABLE. THE CONTRACTOR SHALL EXCAVATE AND LOCATE THE EXISTING CONDUIT PRIOR TO PLACING THE PULL BOX. THE CONTRACTOR SHALL EXERCISE EXTREME CAUTION AS NOT TO DAMAGE THE EXISTING CONDUIT OR CABLE. ANY DAMAGE DUE TO THE CONTRACTOR'S NEGLIGENCE SHALL BE REPLACED AT NO COST TO THE PROJECT.

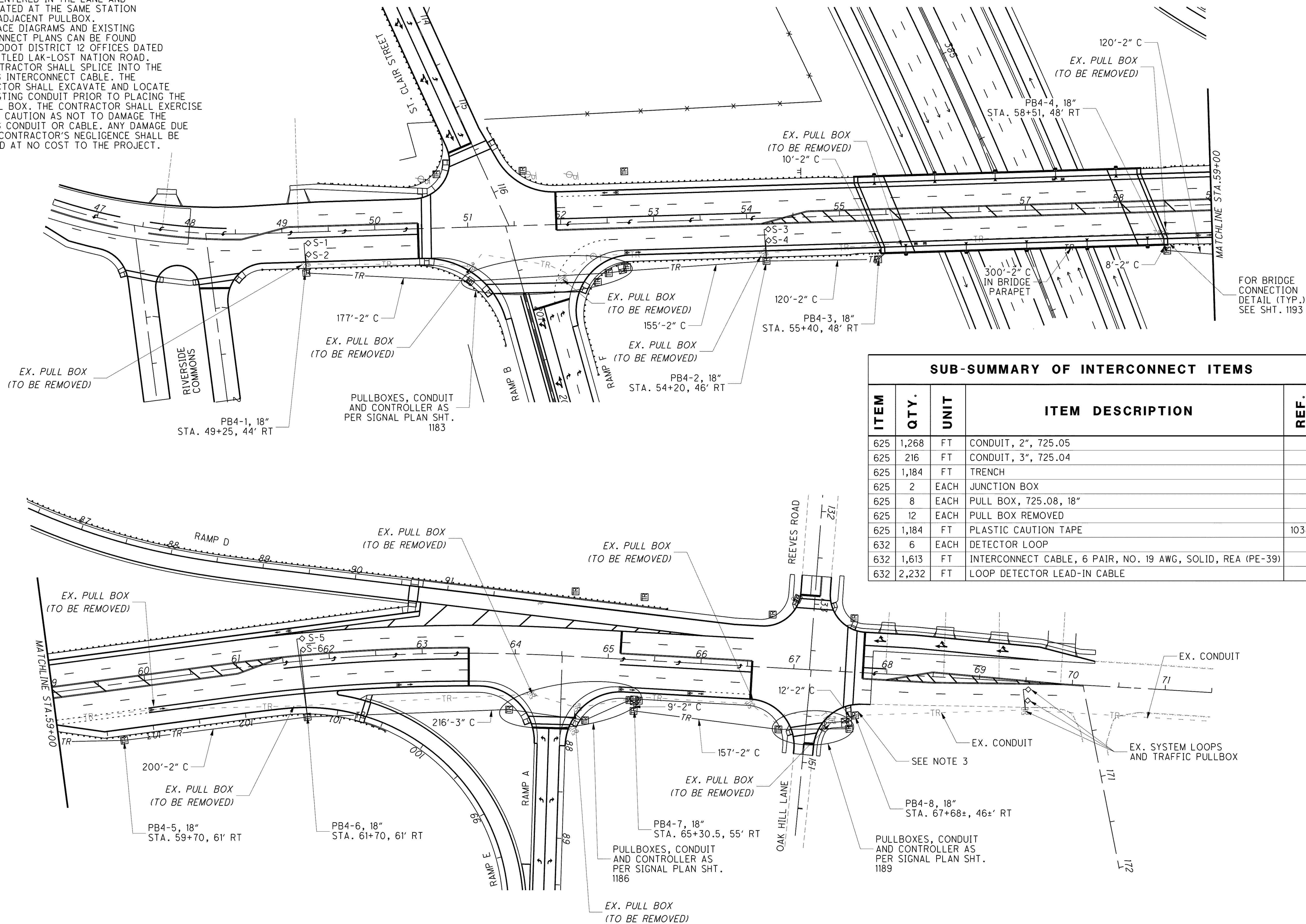

**SUB-SUMMARY OF INTERCONNECT ITEMS**

ITEM	QTY.	UNIT	ITEM DESCRIPTION	REF.
625	1,268	FT	CONDUIT, 2", 725.05	
625	216	FT	CONDUIT, 3", 725.04	
625	1,184	FT	TRENCH	
625	2	EACH	JUNCTION BOX	
625	8	EACH	PULL BOX, 725.08, 18"	
625	12	EACH	PULL BOX REMOVED	
625	1,184	FT	PLASTIC CAUTION TAPE	1038
632	6	EACH	DETECTOR LOOP	
632	1,613	FT	INTERCONNECT CABLE, 6 PAIR, NO. 19 AWG, SOLID, REA (PE-39)	
632	2,232	FT	LOOP DETECTOR LEAD-IN CABLE	

0 50 100  
 HORIZONTAL SCALE IN FEET  
 CALCULATED DRJ  
 CHECKED TMD

**INTERCONNECT PLAN  
 LOST NATION ROAD**

**LAK-2-3.32**

o:\project\lak\13486\signals\sheet\13486CML01.dgn 6/23/2008 10:31:32 AM jmadaria