

g:\project\lak\13486\roadway\sheets\13486XS\_LNB.dgn 7/11/2008 7:53:50 AM dshamer

RAMP B

ITEM 202 PAVEMENT REMOVED

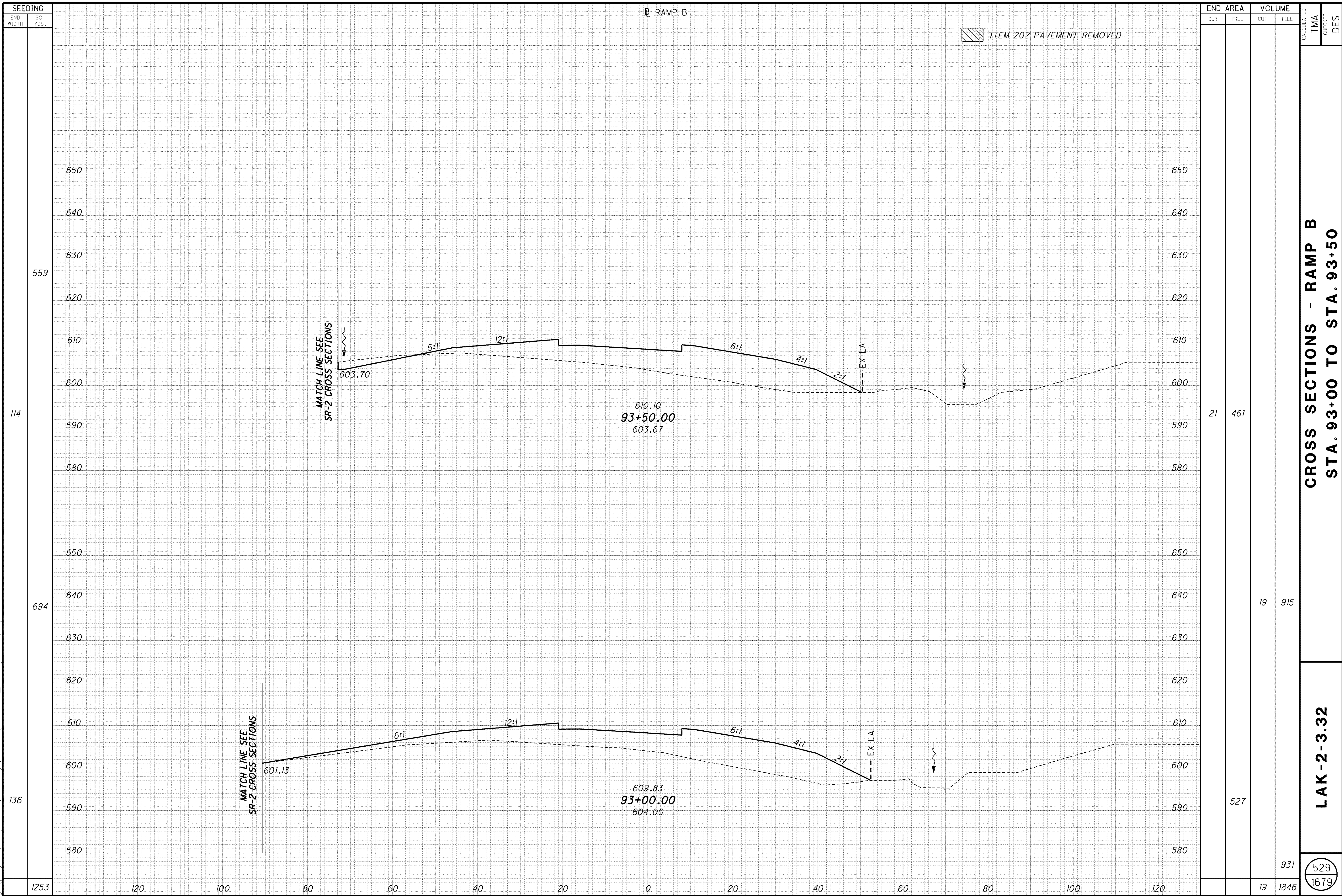

CROSS SECTIONS - RAMP B  
STA. 93+00 TO STA. 93+50

LAK - 2 - 3.32