





LEGEND

-  EX. WETLANDS
-  ITEM 670
DITCH EROSION
PROTECTION,
660.02
-  ITEM 670
DITCH EROSION
PROTECTION MAT,
TYPE A
-  ITEM 670
DITCH EROSION
PROTECTION MAT,
TYPE B
-  ITEM 601
ROCK CHANNEL
PROTECTION
TYPE C W/
FILTER
-  ITEM 601
ROCK CHANNEL
PROTECTION
TYPE D W/
FILTER

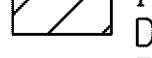

16 RAMP H CURVE DATA
 P.I. STA. = 320+00.97
 $\Delta = 205^\circ 30' 01''$ (LT)
 $D_c = 39^\circ 45' 00''$
 $R = 144.14'$
 $\Delta c = 165^\circ 45' 01''$ (LT)
 $L_c = 416.98'$
 $E_s = 345.22'$
 $e_{MAX} = 0.060$

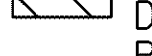
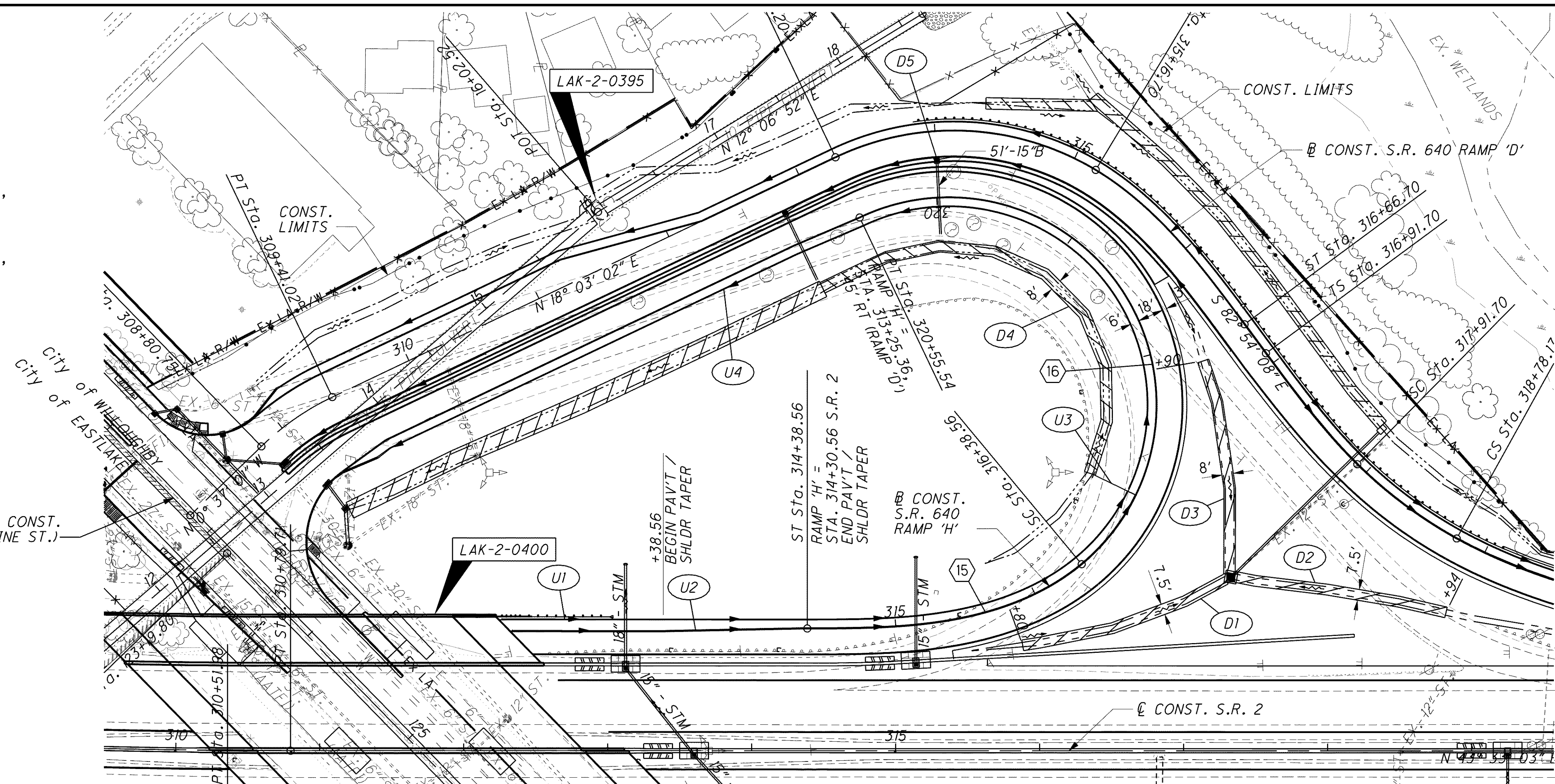
15 RAMP H SPIRAL DATA
 P.I. STA. = 315+75.42
 $L_s = 200.00'$
 $\theta_s = 39^\circ 45' 52''$
 $LT = 136.86'$
 $ST = 69.88'$
 $x = 190.59'$
 $y = 44.69'$
 $k = 98.42'$
 $p = 11.37'$

CROSS REFERENCES			
SHEET NO.	DESCRIPTION	SHEET NO.	DESCRIPTION
281	S.R. 2 PLAN & PROFILE	507	EST. QUANTITIES
488	S.R. 640 RAMP 'D' PLAN & PROFILE	820	INTERSECTION DETAILS
657	S.R. 640 (VINE ST.) PLAN & PROFILE	799	PAVEMENT DETAILS
1327	LAK-2-0400 PLAN & PROFILE	511	STORM PROFILES
508	CROSS SECTIONS		

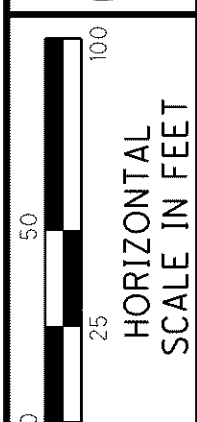
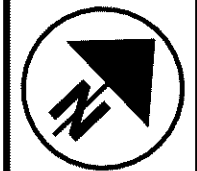
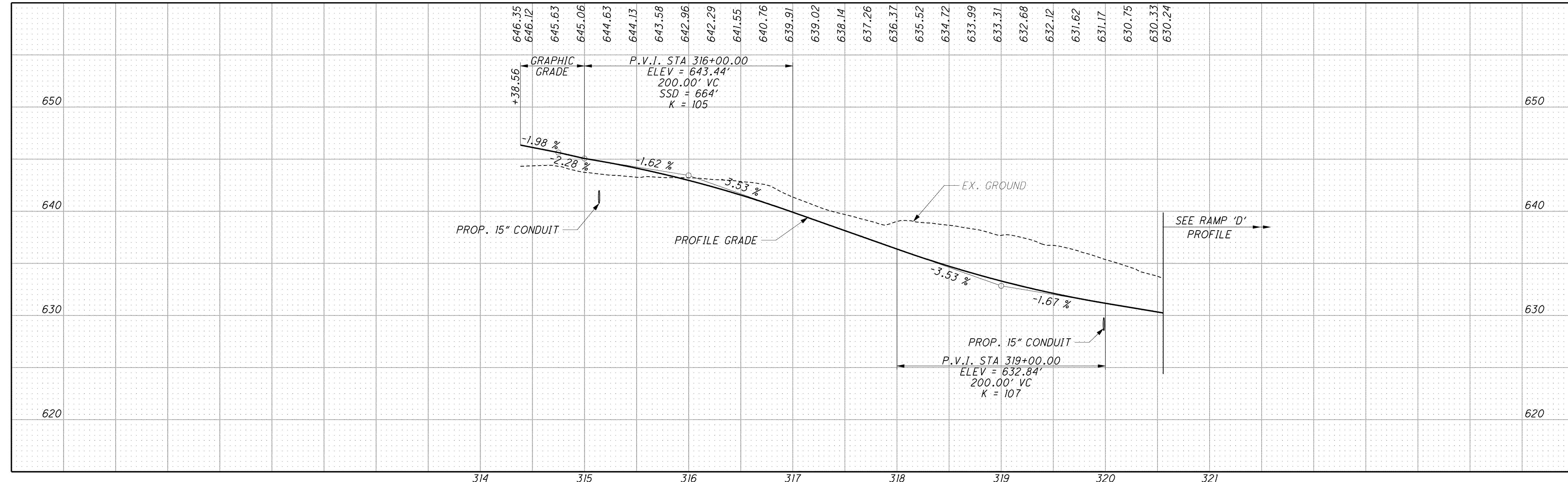

CALCULATED: NAH
 CHECKED: ABS

**PLAN AND PROFILE VINE ST. RAMP H
 BEGIN WORK TO END WORK**

LAK-2-3.32

506
1679

o:\project\lak\13486\roadway\sheets\13486GP09_640H.dgn 6/23/2008 1:03:28 PM jmoder10