

CROSS REFERENCES			
SHEET NO.	DESCRIPTION	SHEET NO.	DESCRIPTION
282	S.R. 2 PLAN & PROFILE	507	EST. QUANTITIES
482	S.R. 640 RAMP 'A' PLAN & PROFILE	820	INTERSECTION DETAILS
657	S.R. 640 (VINE ST.) PLAN & PROFILE	798	PAVEMENT DETAILS
1327	LAK-2-0400 PLAN & PROFILE	482	STORM PROFILES
502	CROSS SECTIONS	504	

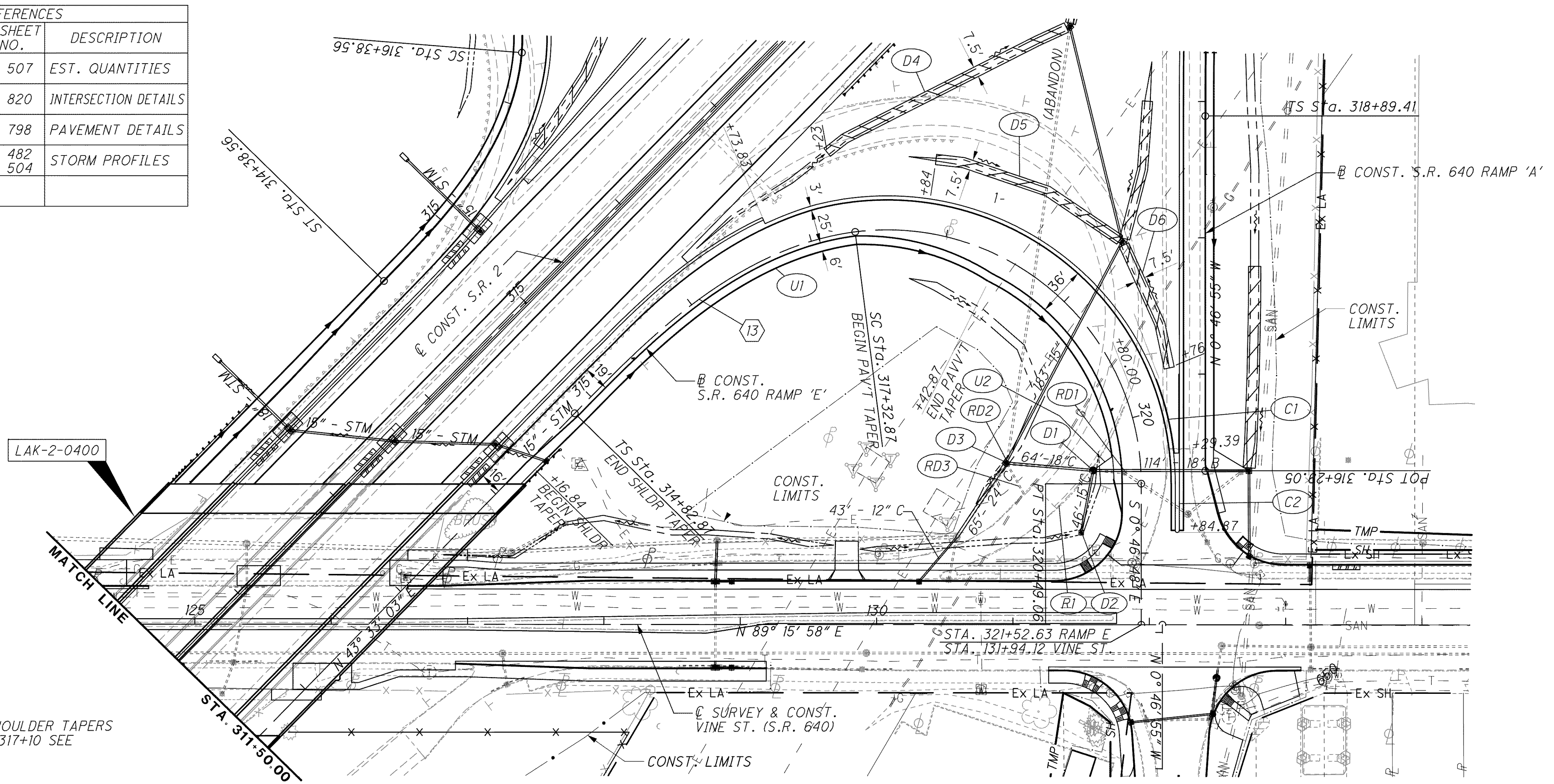

13 RAMP E SPIRAL DATA
 P.I. STA. 316+53.64
 Ls = 250.00'
 $\Delta = 38^\circ 26' 15''$
 LT = 170.77'
 ST = 87.08'
 x = 238.98'
 y = 54.13'
 k = 123.15'
 p = 13.75'

14 RAMP E CURVE DATA
 P.I. STA. 319+44.33
 $\Delta = 97^\circ 13' 47''$ (RT)
 Dc = 30° 45' 00"
 R = 186.33'
 T = 211.46'
 L = 316.19'
 E = 95.51'
 eMAX = 0.06

- LEGEND**
- EX. WETLANDS
 - ITEM 670 DITCH EROSION PROTECTION, 660.02
 - ITEM 670 DITCH EROSION PROTECTION MAT, TYPE A
 - ITEM 670 DITCH EROSION PROTECTION MAT, TYPE B
 - ITEM 601 ROCK CHANNEL PROTECTION TYPE C W/ FILTER
 - ITEM 601 ROCK CHANNEL PROTECTION TYPE D W/ FILTER

NOTE:
 1) FOR PAVEMENT AND SHOULDER TAPERS STA. 314+00 TO STA. 317+10 SEE PAVEMENT DETAILS

