

NOTES: 1. FOR PAVEMENT MARKING LEGEND SEE SHEET 56.

- 2. CONTRACTOR SHALL REMOVE ALL EXISTING CONFLICTING PAVEMENT MARKINGS IN ACCORDANCE WITH 614.11.
- 3. ACCESS TO RESIDENTIAL AND COMMERCIAL PROPERTIES SHALL BE MAINTAINED AT ALL TIMES.

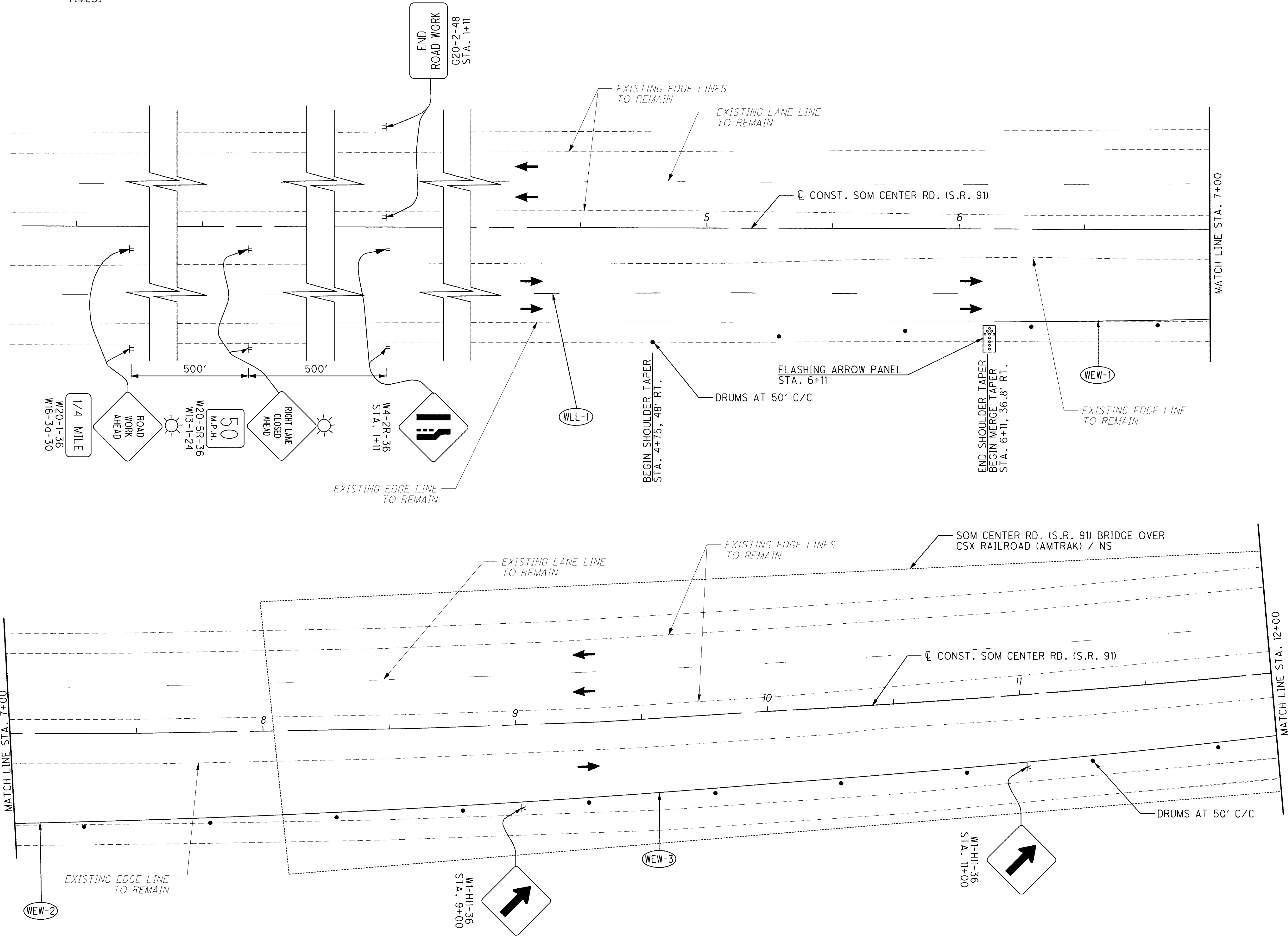

\\Akrn01\Data\Civil\2004108\00\13486\mot\sheets\13486MPg1B1.dgn 6/16/2008 8:09:21 AM svarrrechhia

CALCULATED
TRR
CHECKED
MAH

0 10 20 40
HORIZONTAL
SCALE IN FEET

MAINTENANCE OF TRAFFIC - SOM CENTER RD. (S.R. 91)
STAGE 3 PHASE B STEP 2A - BEGIN TO STA. 12+00

LAK-2-3.32