

NOTE: 1. FOR PAVEMENT MARKING LEGEND SEE SHEET 56
 2. ALL EXISTING SIGNS SHALL REMAIN UNLESS OTHERWISE SHOWN, THE CONTRACTOR SHALL KEEP ALL EXISTING SIGNS VISIBLE DURING CONSTRUCTION.

LEGEND OF WORK

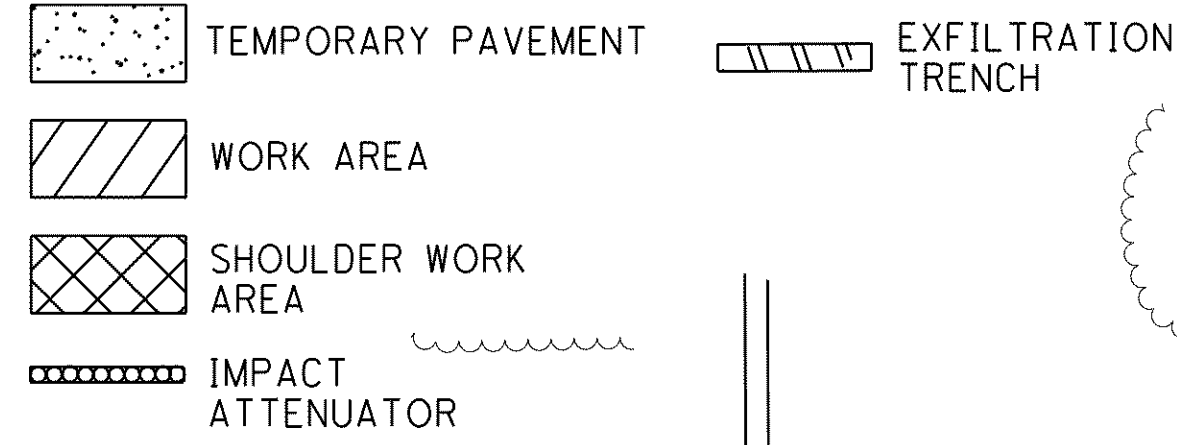

STA. 359+60, RT
 W20-1-36
 ROAD WORK AHEAD

STA. 366+00, RT
 W21-5BL-36
 LEFT SHOULDER CLOSED AHEAD

END ROAD WORK, SPEED REDUCTION & WORK ZONE SPEED LIMIT SIGNS ON THE WEST SIDE OF THE WORK ZONE SHALL BE PLACED IN ACCORDANCE WITH STAGE 2 AND STAGE 3 SHEETS 131 TO 159.

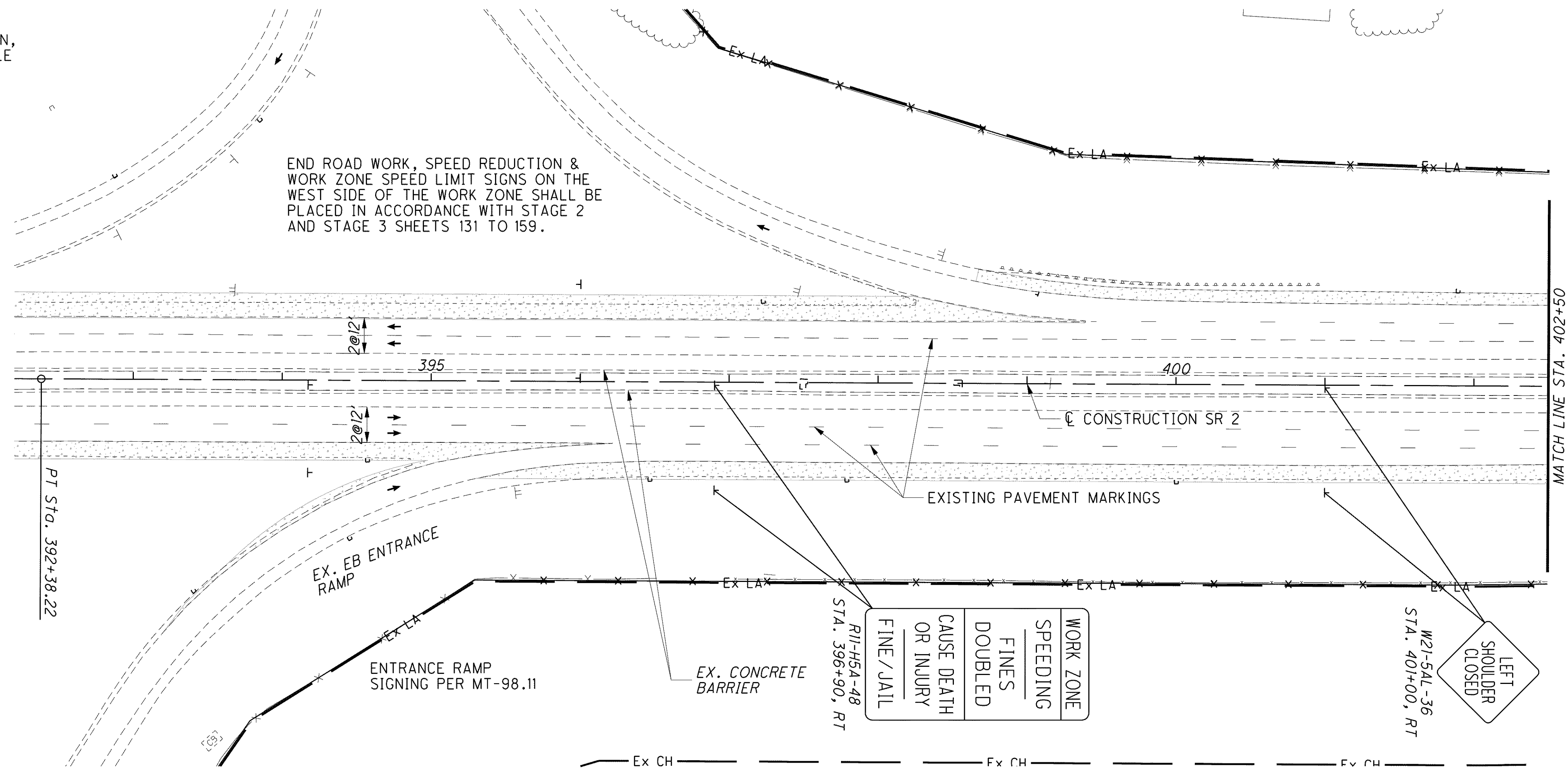

SEE PLAN AND PROFILE OF RAMPED PAVEMENT SHEET 160

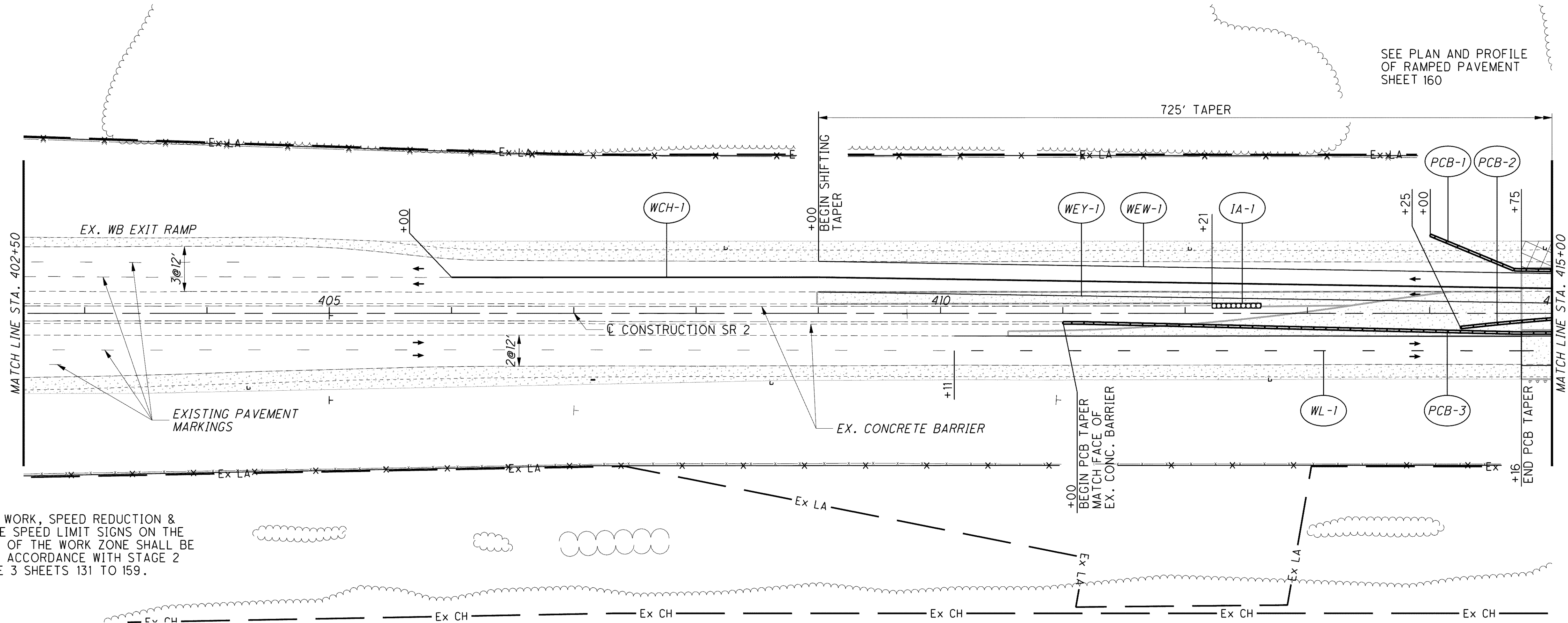

END ROAD WORK, SPEED REDUCTION & WORK ZONE SPEED LIMIT SIGNS ON THE WEST SIDE OF THE WORK ZONE SHALL BE PLACED IN ACCORDANCE WITH STAGE 2 AND STAGE 3 SHEETS 131 TO 159.

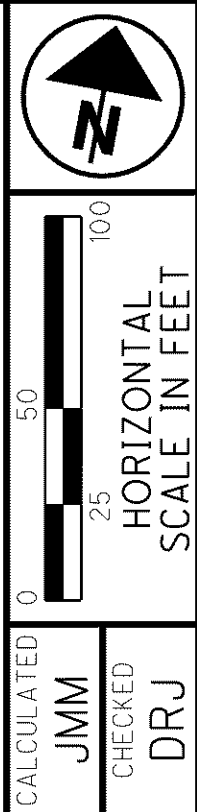

MAINTENANCE OF TRAFFIC - S.R. 2 STAGE 1
 PHASE D - STA. 359+60 TO STA. 415+00

LAK-2-3.32

125
 1679