

LAKE COUNTY  
LAK-2-1649

Located 2.2 miles East of East Corporation Line of Painesville.

B.M. # 92 A - Railroad Spike in 18" Maple N. Side Rte. 20 adjacent to Siron Dr. 10' Lt. of Sta. 93 + 17 on U.S. 20, 31.55' Lt. of C. of Reconstr. Sta. 93 + 17 Elev. 690.930

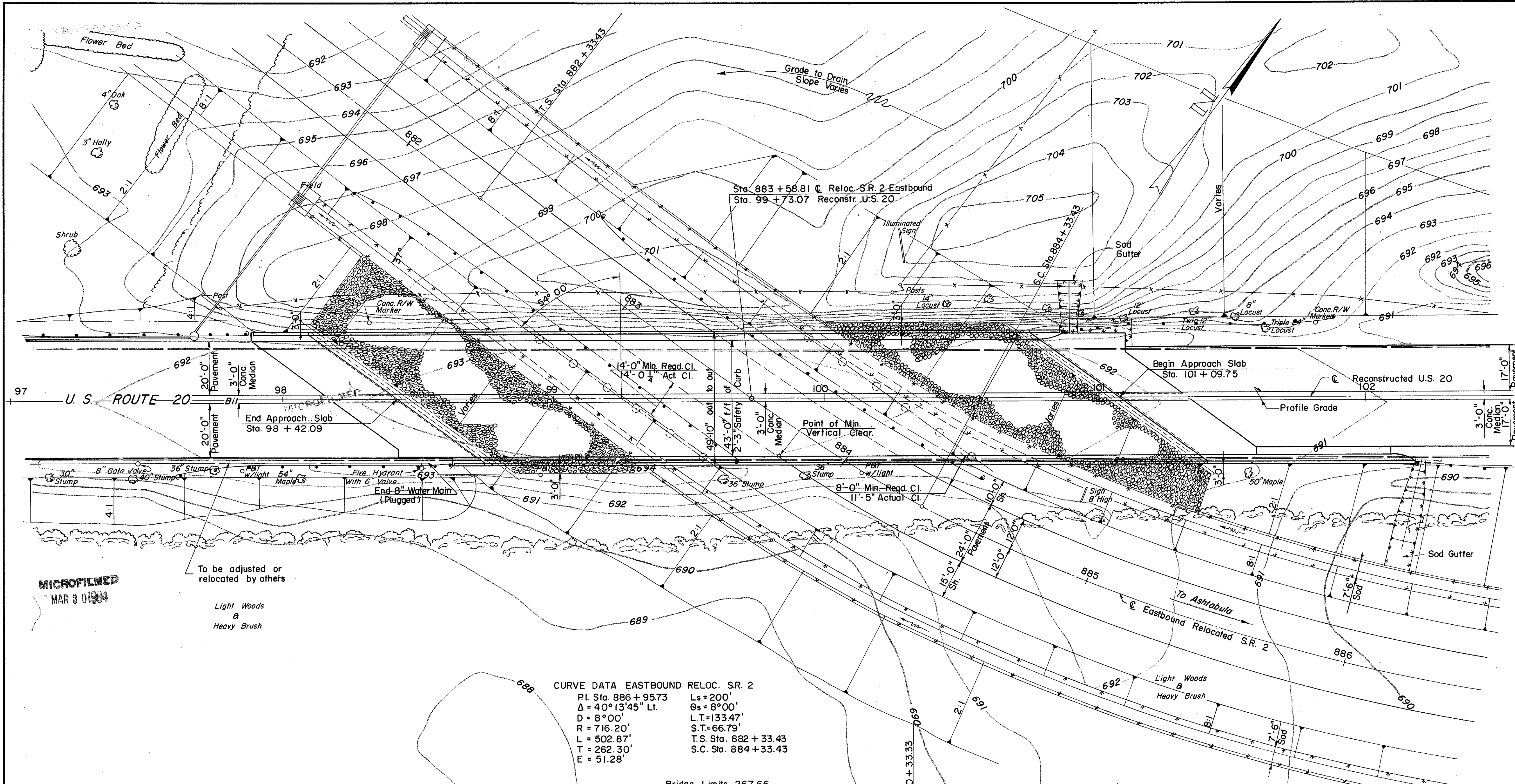

MICROFILMED  
MAR 3 01984

To be adjusted or relocated by others

Light Woods  
&  
Heavy Brush

CURVE DATA EASTBOUND RELOC. S.R. 2  
 P.I. Sta. 886 + 95.73    Ls = 200'  
 Δ = 40° 13' 45" Lt.    Os = 8° 00'  
 D = 8° 00'    L.T. = 133.47'  
 R = 716.20'    S.T. = 66.79'  
 L = 502.87'    T.S. Sta. 882 + 33.43  
 T = 262.30'    S.C. Sta. 884 + 33.43  
 E = 51.28'

Bridge Limits 267.66

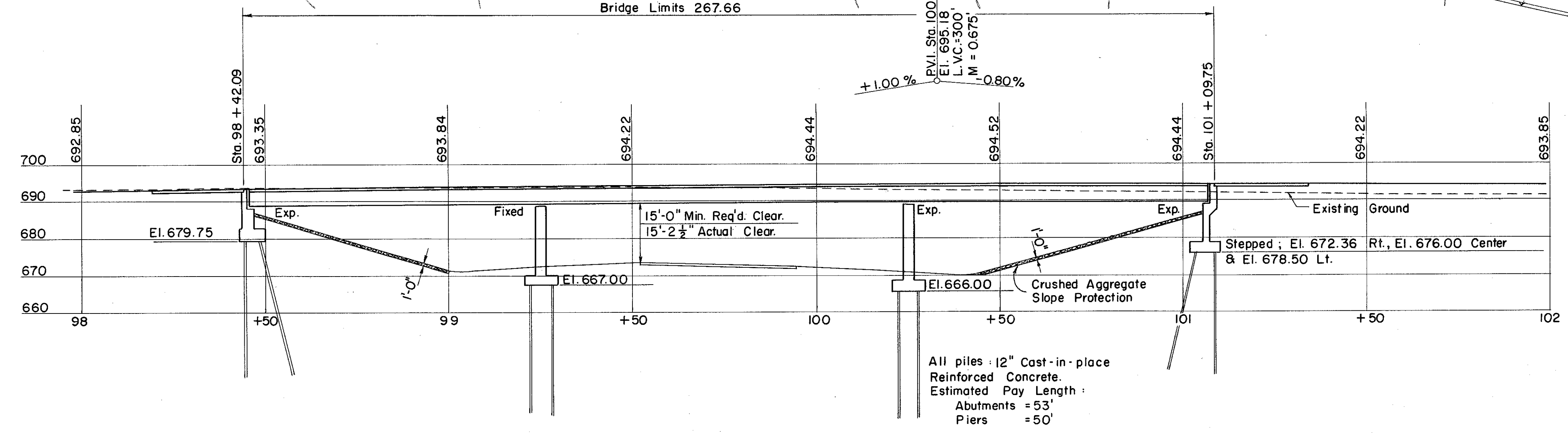

All piles: 12" Cast-in-place Reinforced Concrete.  
 Estimated Pile Length:  
 Abutments = 53'  
 Piers = 50'

FOUNDATION SOUNDINGS: Foundation design and foundation quantities are based on a study of rod soundings and soil-sampling soundings made of the site. This sounding information may be inspected in the office of the Bureau of Bridges in Columbus or in the Division Office, but the State does not guarantee the accuracy thereof.

PROPOSED STRUCTURE

TYPE: 3 Span Continuous Welded Plate Girder with Reinforced Concrete Deck & Substructure.  
 SPANS: 80'-0", 100'-0" and 80'-0" Ctr. to Ctr. bearing.  
 ROADWAY: 43'-0" f/f 2'-3" Safety Curbs.  
 LOAD FREQUENCY: CF = 400 (57)  
 WEARING SURFACE: 1" monolithic concrete.  
 APPROACH SLABS: Special (25'-0" long)  
 ALIGNMENT: Tangent U.S. 20, Curve S.R. 2  
 A.D.T. U.S. 20: 8220 (1980)  
 A.D.T. Reloc. S.R. 2: 5510 (1980)  
 SKEW of Substructure: 54° 00' R.F.

PREPARED BY  
 CAPITOL ENGINEERING ASSOCIATES, DILLSBURG, PA.  
 FOR

STATE OF OHIO  
 DEPARTMENT OF HIGHWAYS  
 DIVISION OF DESIGN AND CONSTRUCTION  
 BUREAU OF BRIDGES

SITE PLAN

BRIDGE NO. LAK-2-1862  
 RELOC. S.R. 2 UNDER RECONSTR. U.S. 20  
 LAKE COUNTY  
 STA. 99 + 73.07

DESIGNED	DRAWN	TRACED	CHECKED	REVIEWED DATE	REVISED
	M.J.F.	F.W.B.	L.L.D. J.H.T.		